



fungeneration

SePar
QUAD LED RGB UV IR,
SePar
QUAD LED RGBW
LED PAR

Musikhaus Thomann
Thomann GmbH
Hans-Thomann-Straße 1
96138 Burgebrach
Germany
Telephone: +49 (0) 9546 9223-0
E-mail: info@thomann.de
Internet: www.thomann.de

14.01.2020, ID: 399539, 399604 (V2)

Table of contents

1	General information	5
	1.1 Further information.....	6
	1.2 Notational conventions.....	7
	1.3 Symbols and signal words.....	8
2	Safety instructions	10
3	Features	17
4	Installation	18
5	Starting up	23
6	Connections and controls	26
7	Operating	33
	7.1 Starting the device.....	33
	7.2 Remote control.....	33
	7.3 Operating controls on the device.....	36
	7.4 Menu overview.....	40
	7.5 Functions in 2-channel DMX mode.....	41

7.6	Functions in 4-channel DMX mode.....	44
7.7	Functions in 6-channel DMX mode.....	44
7.8	Functions in 8-channel DMX mode.....	45
8	Technical specifications.....	49
9	Plug and connection assignments.....	53
10	Troubleshooting.....	54
11	Cleaning.....	57
12	Protecting the environment.....	58

1 General information

This user manual contains important information on the safe operation of the device. Read and follow all safety notes and all instructions. Save this manual for future reference. Make sure that it is available to all persons using this device. If you sell the device to another user, be sure that they also receive this manual.

Our products and user manuals are subject to a process of continuous development. We therefore reserve the right to make changes without notice. Please refer to the latest version of the user manual which is ready for download under www.thomann.de.

1.1 Further information

On our website (www.thomann.de) you will find lots of further information and details on the following points:

Download	This manual is also available as PDF file for you to download.
Keyword search	Use the search function in the electronic version to find the topics of interest for you quickly.
Online guides	Our online guides provide detailed information on technical basics and terms.
Personal consultation	For personal consultation please contact our technical hotline.
Service	If you have any problems with the device the customer service will gladly assist you.

1.2 Notational conventions

This manual uses the following notational conventions:

Letterings

The letterings for connectors and controls are marked by square brackets and italics.

Examples: *[VOLUME]* control, *[Mono]* button.

Displays

Texts and values displayed on the device are marked by quotation marks and italics.

Examples: *'24ch'*, *'OFF'*.

Text input





Text inputs that are carried out on the device are indicated by typewriter font.

Example: 2323

1.3 Symbols and signal words

In this section you will find an overview of the meaning of symbols and signal words that are used in this manual.

Signal word	Meaning
DANGER!	This combination of symbol and signal word indicates an immediate dangerous situation that will result in death or serious injury if it is not avoided.
WARNING!	This combination of symbol and signal word indicates a possible dangerous situation that can result in death or serious injury if it is not avoided.
NOTICE!	This combination of symbol and signal word indicates a possible dangerous situation that can result in material and environmental damage if it is not avoided.

Warning signs	Type of danger
	Warning – high-voltage.
	Warning – dangerous optical radiation.
	Warning – suspended load.
	Warning – danger zone.

2 Safety instructions

Intended use

This device is intended for use as an electronic lighting effect by means of LED technology. The device is designed for professional use and is not suitable for use in households. Use the device only as described in this user manual. Any other use or use under other operating conditions is considered to be improper and may result in personal injury or property damage. No liability will be assumed for damages resulting from improper use.

This device may be used only by persons with sufficient physical, sensorial, and intellectual abilities and having corresponding knowledge and experience. Other persons may use this device only if they are supervised or instructed by a person who is responsible for their safety.

Extend the life of the device by regular breaks in operation and avoid switching it on and off frequently. This device is not suitable for continuous use.

Safety**DANGER!****Danger for children**

Ensure that plastic bags, packaging, etc. are disposed of properly and are not within reach of babies and young children. Choking hazard!

Ensure that children do not detach any small parts (e.g. knobs or the like) from the unit. They could swallow the pieces and choke!

Never let children unattended use electrical devices.

**DANGER!****Electric shock caused by high voltages inside**

Within the device there are areas where high voltages may be present. Never remove any covers.

There are no user-serviceable parts inside.

Do not use the device if covers, protectors or optical components are missing or damaged.



DANGER!

Electric shock caused by short-circuit

Always use proper ready-made insulated mains cabling (power cord) with a protective contact plug. Do not modify the mains cable or the plug. Failure to do so could result in electric shock/death or fire. If in doubt, seek advice from a registered electrician.



WARNING!

Eye damage caused by high light intensity

Never look directly into the light source.



WARNING!

Risk of epileptic shock

Strobe lighting can trigger seizures in photosensitive epilepsy. Sensitive persons should avoid looking at strobe lights.



NOTICE!

Risk of fire

Do not block areas of ventilation. Do not install the device near any direct heat source. Keep the device away from naked flames.



NOTICE!

Risk of fire due to incorrect polarity

Incorrectly inserted batteries may destroy the device or the batteries.
Ensure that proper polarity is observed when inserting batteries.



NOTICE!

Possible damage by leaking batteries

Leaking batteries can cause permanent damage to the device.
Take batteries out of the device if it is not going to be used for a longer period.



NOTICE!

Operating conditions

This device has been designed for indoor use only. To prevent damage, never expose the device to any liquid or moisture. Avoid direct sunlight, heavy dirt, and strong vibrations.

Only operate the device within the ambient conditions specified in the chapter 'Technical specifications' of this user manual. Avoid heavy temperature fluctuations and do not switch the device on immediately after it was exposed to temperature fluctuations (for example after transport at low outside temperatures).

Dust and dirt inside can damage the unit. When operated in harmful ambient conditions (dust, smoke, nicotine, fog, etc.), the unit should be maintained by qualified service personnel at regular intervals to prevent overheating and other malfunction.



NOTICE!

Power supply

Before connecting the device, ensure that the input voltage (AC outlet) matches the voltage rating of the device and that the AC outlet is protected by a residual current circuit breaker. Failure to do so could result in damage to the device and possibly injure the user.

Unplug the device before electrical storms occur and when it is unused for long periods of time to reduce the risk of electric shock or fire.



NOTICE!

Possible staining

The plasticiser contained in the rubber feet of this product may possibly react with the coating of your parquet, linoleum, laminate or PVC floor and after some time cause permanent dark stains.

In case of doubt, do not put the rubber feet directly on the floor, but use felt-pad floor protectors or a carpet.



NOTICE!

Possible damage due to installation of a wrong fuse

The use of different types of fuses can cause serious damage to the unit. Fire hazard!

Only fuses of the same type may be used.

3 Features

Special features of the device:

- – SePar Quad RGBW IR: 5 × 4 watt 4in1 LED red, green, blue and white
- SePar Quad RGB UV IR: 5 × 4 watt 4in1 LED red, green, blue and UV
- Stand-alone, master-slave or DMX mode operation
- Operation via buttons and display on the unit or via an optionally available infrared remote control (item no. 354223)
- Sound control via built-in microphone
- Universal two-piece mounting bracket for hanging or standing installation
- Suitable for use in clubs, bars, stages, exhibitions, etc.

For technological reasons, the light output of LEDs decreases over their lifetime. This effect increases with higher operating temperature. You can extend the service life of the illuminants by providing adequate ventilation and operating the LEDs with the lowest possible brightness.

4 Installation

Unpack and check carefully there is no transportation damage before using the unit. Keep the equipment packaging. To fully protect the product against vibration, dust and moisture during transportation or storage use the original packaging or your own packaging material suitable for transport or storage, respectively.



WARNING!

Risk of injury caused by falling objects

Make sure that the installation complies with the standards and rules that apply in your country. Always secure the device with a secondary safety attachment, such as a safety cable or a safety chain.



NOTICE!

Risk of overheating

The distance between light output and the illuminated surface must be more than 1.5 m (19.7in).

Provide sufficient ventilation.

The ambient temperature must always be below 40 °C (104 °F).



NOTICE!

Use of stands

When mounting the device onto a stand, ensure that the stand is in a safe and stable position and that the weight of the device does not exceed the maximum permissible load capacity of the stand.



NOTICE!

Possible data transmission errors

For error-free operation make use of dedicated DMX cables and do not use ordinary microphone cables.

Never connect the DMX input or output to audio devices such as mixers or amplifiers.

Mounting options

You can install the unit in hanging or standing position. When in use, the device must always be attached to a solid surface or an approved truss. Use the openings provided on the two-piece bracket for attaching.

Always work from a stable platform whenever installing, moving or servicing the unit. In doing so, the area underneath the unit must be cordoned off.

The safety cable must be attached to the bracket.

DMX indicator

If the unit is in DMX mode and a DMX controller is connected and turned on, a dot on the fourth digit of the display will flash. If the unit is in DMX mode, but without a turned on DMX controller connected, the display will flash.



Please note that this device must not be connected to a dimmer.

Inserting the battery into the remote control

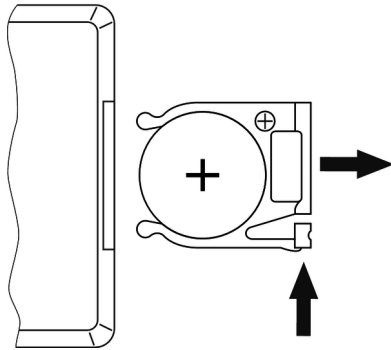

Press the lock of the battery holder to the centre of the housing and pull out the battery holder like a drawer. Insert the battery. The battery is correct if the positive pole points to the housing base of the remote control. Slide the battery holder back into the remote until it clicks into place.

When shipping, the battery is already installed in the remote and protected against discharge by a transparent plastic foil. Remove the plastic foil prior to first use.

5 Starting up

Create all connections while the device is off. Use the shortest possible high-quality cables for all connections. Take care when running the cables to prevent tripping hazards.

Connections in DMX mode

Connect the DMX input of the device to the DMX output of a DMX controller or another DMX device. Connect the output of the first DMX device to the input of the second one, and so on to form a daisy chain. Always ensure that the output of the last DMX device in the daisy chain is terminated with a resistor ($110\ \Omega$, $\frac{1}{4}\text{ W}$).

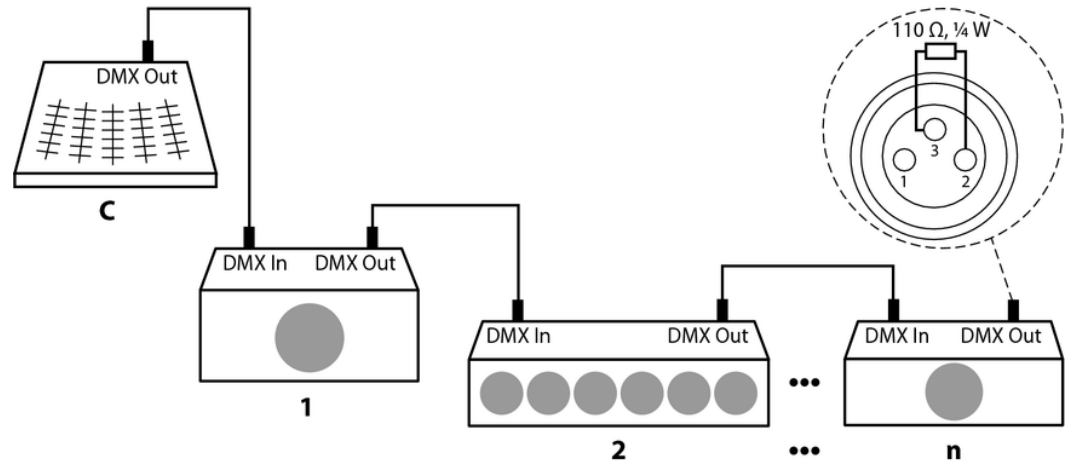

Connections in master/slave mode

When you configure a group of devices in master/slave mode, the first unit will control the other units for an automatic, sound-activated, synchronized show. This function is ideal when you want to start a show immediately. Connect the DMX output of the master device to the DMX input of the first slave device. Then connect the DMX output of the first slave device to the DMX input of the second slave device and so on.

6 Connections and controls

Front and rear panel

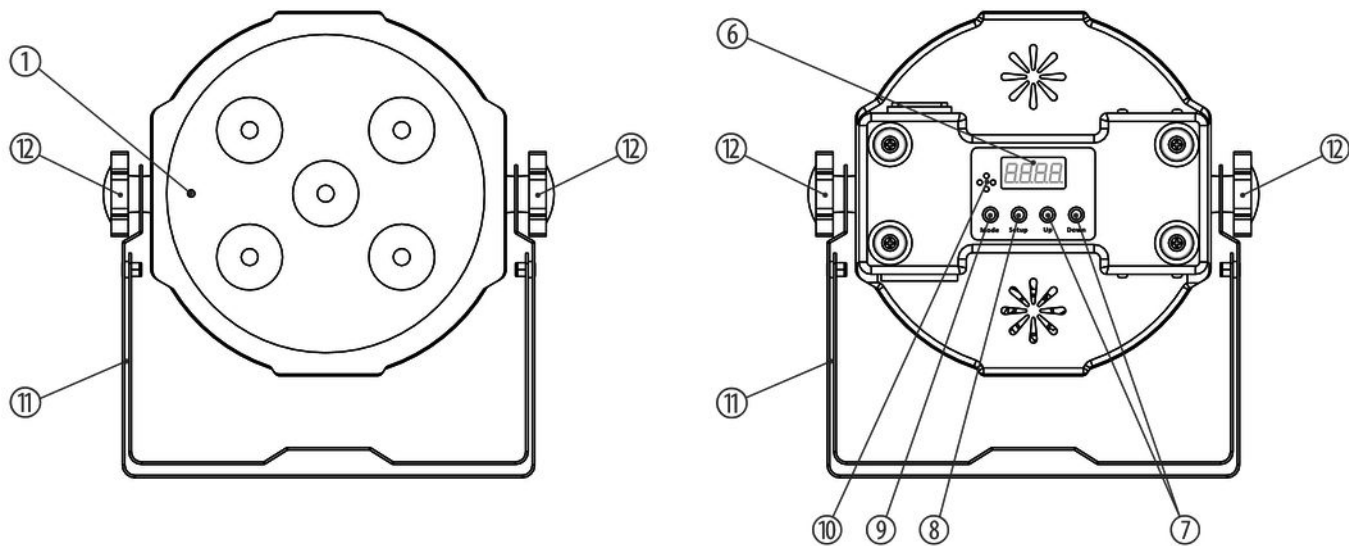

View from above / below

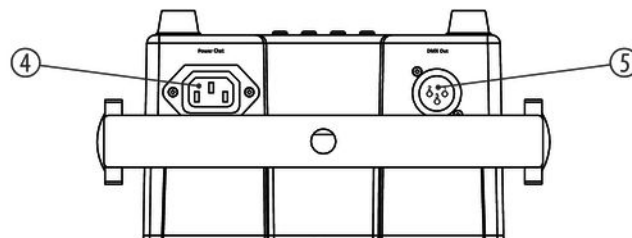
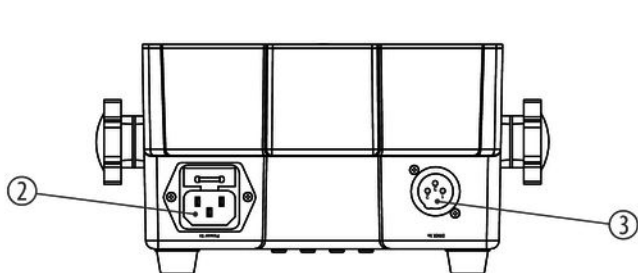

SePar QUAD LED RGB UV IR, SePar QUAD LED RGBW

1	Infrared sensor for receiving the signals from the remote control.
2	<i>[Power In]</i> Panel plug (for non-heating apparatus) for mains cable with fuse holder Connect the device to a grounded power outlet using the supplied power cable.
3	<i>[DMX In]</i> DMX input
4	<i>[Power Out]</i> Power supply socket (for non-heating apparatus) for the power supply of other devices.
5	<i>[DMX Out]</i> DMX output
6	Display
7	<i>[Up] [Down]</i> Increases / decreases the displayed value by one.
8	<i>[Setup]</i> Confirms a selected value.

9	<i>[Mode]</i> Calls the main menu or a submenu.
10	Microphone for sound control.
11	Two-piece bracket for hanging or installation and for securing the safety-rope.
12	Locking screws for the mounting bracket.

Remote control

A remote control (item no. 354223) is available as an optional accessory (not included).

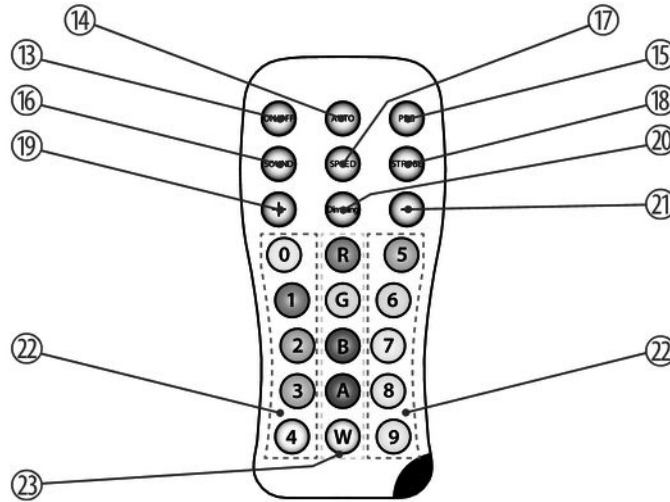

13	<i>[ON/OFF]</i> Button for switching the display off (blackout) or back on.
14	<i>[AUTO]</i> Activates Auto mode.
15	<i>[PRG]</i> Activates Program mode.
16	<i>[SOUND]</i> Activates the 'Sound Control' mode.
17	<i>[SPEED]</i> Allows you to set the speed of the selected program.
18	<i>[STROBE]</i> Turns the strobe effect on and off.
19	<i>[+]</i> Increases the displayed value by one.

20	<i>[Dimming]</i> Brightness control
21	<i>[-]</i> Decreases the displayed value by one.
22	<i>[0] ... [9]</i> Numeric keys.
23	Buttons for colour selection.

7 Operating

7.1 Starting the device

Connect the device to the power supply to start operation. After a few seconds the device is ready for use.

7.2 Remote control

If the device neither is working as Slave in a Master / Slave configuration nor is not controlled via DMX you can control it using the remote control.

Blackout

Use *[ON/OFF]* to activate or cancel Blackout.

Auto mode

Press *[AUTO]*. The device now operates in automatic stand-alone mode.

In Auto mode, you can turn on a strobe effect. Press *[STROBE]* and use *[+]* and *[-]* to select a value between 'FS00' (slow) and 'FS99' (fast). Press again *[STROBE]* to turn the strobe effect off.

In Auto mode, you can set the speed. Press *[SPEED]* and use *[+]* and *[-]* to select a value between 'SP01' (slow) and 'SPFL' (fast).

Program mode

Press *[PRG]*. Use *[+]* and *[-]* to select a value between 'Pr02' and 'Pr.12'.

In Program mode, you can turn on a strobe effect. Press *[STROBE]* and use *[+]* and *[-]* to select a value between 'FS00' (slow) and 'FS99' (fast). Press again *[STROBE]* to turn the strobe effect off.

It is possible to adjust the speed of the programs. Press *[SPEED]* and use *[+]* and *[-]* to select a value between 'SP01' (slow) and 'SPFL' (fast).

Sound control

Press *[SOUND]*. This activates a sound controlled automatic show.

Use *[+]* and *[-]* to adjust the sensitivity of the sound control in a range from 'SV00' to 'SV31'.

Dimming (SePar Quad RGBW IR)

Press *[Dimming]* to adjust the brightness level of the primary colours. Press *[R]* (red), *[G]* (green), *[B]* (blue) or *[W]* (white) and use *[+]* and *[-]* to select a value between 0 and 255.

Dimming (SePar Quad RGB UV IR)

Press *[Dimming]* to adjust the brightness level of the primary colours. Press *[R]* (red), *[G]* (green), *[B]* (blue) or *[1]* (UV) and use *[+]* and *[-]* to select a value between 0 and 255.

Colour selection

Use the coloured buttons to select a colour tone in any mode. The following assignment applies:

Button	Colour	Button	Colour	Button	Colour
0	Cyan	5	Magenta	R	Red
1	Purple	6	Light green	G	Green
2	Pink	7	Light blue	B	Blue
3	Yellow	8	Brown	A	Amber
4	White	9	Warm white	W	White

Resetting to factory defaults

To reset the device, press *[ON/OFF]* to activate Blackout and then press *[9]*, *[8]*, and *[7]* at the same time.

7.3 Operating controls on the device

Press *[Mode]* to activate the main menu. Press *[Mode]* again to access additional menu items. To activate the displayed menu item, press *[Setup]*. Use *[Up]* and *[Down]* to change the respectively displayed value. Changed values and settings will be applied immediately. Use *[Mode]* to return to the previous menu level.

If you do not press any button for about 15 seconds the display turns off. The set values are retained even when the device is disconnected from the mains power supply.

Auto mode

Press *[Mode]* repeatedly until the display shows 'AUTO'. The device now operates in automatic stand-alone mode.

Automatic operation can only be activated when the unit is operating in stand alone mode or as master in a master / slave combination. This setting takes effect only when the device is not operated under DMX control.

Press *[Setup]* and then use *[Up]* | *[Down]* to set a program speed between 'SP01' (slow) and 'SPFL' (fast). Press *[Setup]* and then use *[Up]* | *[Down]* to set a flashing speed between 'FS01' (slow) and 'FS99' (fast). Press *[Setup]* and then use *[Up]* | *[Down]* to set a switching speed between 'n001' (slow) and 'n100' (fast).

Program mode

Press *[Mode]* or *[Up]* | *[Down]* until the display shows 'Pro'. Press *[Setup]* and then use *[Up]* | *[Down]* to select one of the programs between 'Pr01' to 'Pr12'.

A preprogrammed automatic show can only be activated when the unit is operating in stand-alone mode or as master in a master / slave combination. This setting takes effect only when the device is not operated under DMX control.

If you select 'Pr01', you can press *[Setup]* and then use *[Up]* | *[Down]* to select 15 pre-programmed colour patterns, which will then light up constantly. Or select '-OFF' to activate Blackout. Press *[Setup]* and then use *[Up]* | *[Down]* to set a flashing speed between 'FS01' (slow) and 'FS99' (fast) or 'FSFL' (strobe effect). For constant light, select 'FS00'.

Programs 'Pr02' - 'Pr12' provide pre-programmed colour sequences. After selecting a program, press *[Setup]* and then use *[Up]* | *[Down]* to set the speed of the colour sequences between 'SP01' (slow) and 'SPFL' (fast). Press *[Setup]* and then use *[Up]* | *[Down]* to choose a flashing speed between 'FS01' (slow) and 'FS99' (fast).

DMX address

Press *[Mode]* or *[Up]* | *[Down]* until the display shows 'd---'. Press *[Setup]* and then use *[Up]* | *[Down]* to set the desired DMX address between 1 and 512 (display 'd001' ... 'd512'). Make sure this number matches the configuration of your DMX controller.

This setting is only relevant if the device is being controlled via DMX.

Press *[Setup]* and then use *[Up]* | *[Down]* to select the DMX mode (2, 4, 6 or 8 channels).

Slave mode

Press *[Mode]* or *[Up]* | *[Down]* until the display shows 'SLAv'. The device is now operating in slave mode, i.e. with correct wiring it will behave exactly like the controlling master device.

This setting takes effect only when the device is not operated under DMX control.

Colour mode (SePar Quad RGBW IR)

Press *[Mode]* or *[Up]* | *[Down]* until the display shows 'CLor'. All LEDs now light up at full intensity. Press *[Setup]* and then use *[Up]* | *[Down]* to set the intensity of the red colour between 'r000' (off) and 'r255' (full). Press *[Setup]* and then use *[Up]* | *[Down]* to set the intensity of the green colour between 'g000' (off) and 'g255' (full). Press *[Setup]* and then use *[Up]* | *[Down]* to set the intensity of the blue colour between 'b000' (off) and 'b255' (full). Press *[Setup]* and then use *[Up]* | *[Down]* to set the intensity of the white colour between 'w000' (off) and 'w255' (full).

A constant colour can only be activated when the unit is operating in stand-alone mode or as master in a master / slave combination. This setting takes effect only when the device is not operated under DMX control.

Colour mode (SePar Quad RGB UV IR)

Press *[Mode]* or *[Up]* | *[Down]* until the display shows 'CLor'. All LEDs now light up at full intensity. Press *[Setup]* and then use *[Up]* | *[Down]* to set the intensity of the red colour between 'r000' (off) and 'r255' (full). Press *[Setup]* and then use *[Up]* | *[Down]* to set the intensity of the green colour between 'g000' (off) and 'g255' (full). Press *[Setup]* and then use *[Up]* | *[Down]* to set the intensity of the blue colour between 'b000' (off) and 'b255' (full). Press *[Setup]* and then use *[Up]* | *[Down]* to set the intensity of the UV ranger between 'u000' (off) and 'u255' (full).

A constant colour can only be activated when the unit is operating in stand-alone mode or as master in a master / slave combination. This setting takes effect only when the device is not operated under DMX control.

Sound mode

Press *[Mode]* or *[Up]* | *[Down]* until the display shows 'SoUn'. The device now shows a music-controlled colour sequence. Press *[Setup]* and then use *[Up]* | *[Down]* to set the sensitivity of the built-in microphone for the music control between 'SU00' (low) and 'SU31' (high).

7.4 Menu overview

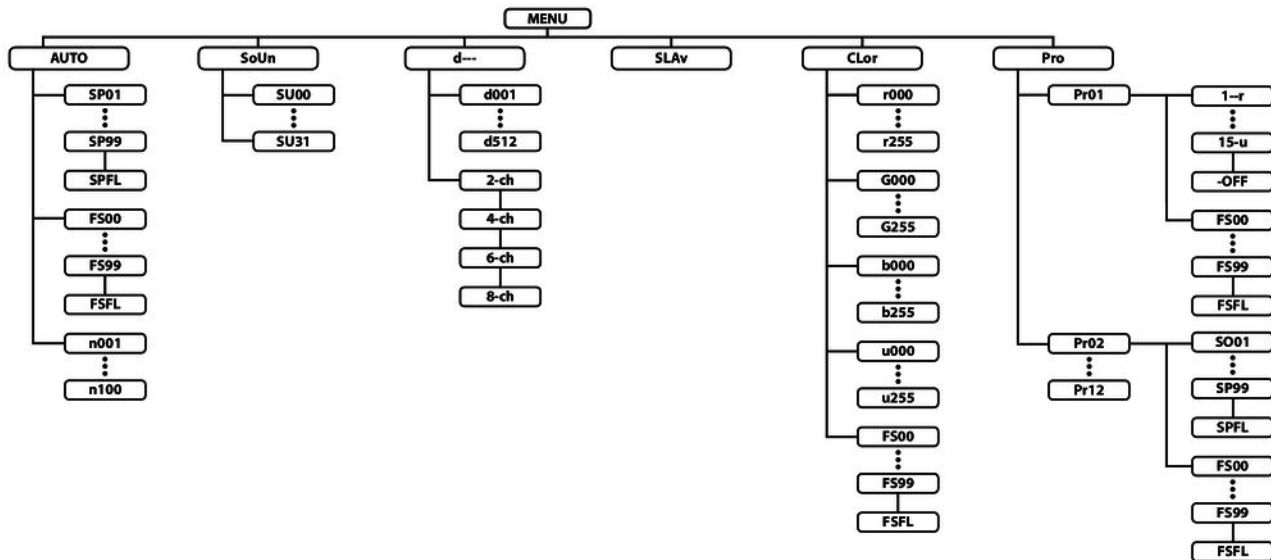

7.5 Functions in 2-channel DMX mode

Channel	Value	Function
1	Colour or program selection	
	0 ... 4	LEDs off (blackout)
	5 ... 9	Red
	10 ... 14	Yellow
	15 ... 19	Fawn
	20 ... 24	Green
	25 ... 29	Cyan
	30 ... 34	Blue
	35 ... 39	Purple
	40 ... 44	Pink
	45 ... 49	Amber

Channel	Value	Function
	50 ... 54	Light red
	55 ... 59	Light green
	60 ... 64	Light blue
	65 ... 69	Cold white
	70 ... 74	White (SePar Quad RGBW IR) Warm white (SePar Quad RGB UV IR)
	75 ... 79	Warm white (SePar Quad RGBW IR) UV (SePar Quad RGB UV IR)
	80 ... 89	Automatic Show 2
	90 ... 99	Automatic Show 3
	100 ... 109	Automatic Show 4
	110 ... 119	Automatic Show 5
	120 ... 129	Automatic Show 6

Channel	Value	Function
	130 ... 139	Automatic Show 7
	140 ... 149	Automatic Show 8
	150 ... 159	Automatic Show 9
	160 ... 169	Automatic Show 10
	170 ... 179	Automatic Show 11
	180 ... 189	Automatic Show 12
	190 ... 255	Music-controlled automatic show, sensitivity setting with channel 2
2	0 ... 255	No function, if channel 1 = 0 ... 79 Speed of the automatic show, if channel 1 = 80 ... 189) Microphone sensitivity, if channel 1 = 190 ... 255

7.6 Functions in 4-channel DMX mode

Channel	Value	Function
1	0...255	Intensity Red (0 % to 100 %)
2	0...255	Intensity Green (0 % to 100 %)
3	0...255	Intensity Blue (0 % to 100 %)
4	0...255	Intensity white (0 % to 100 %) (SePar Quad RGBW IR) Intensity UV (0 % to 100 %) (SePar Quad RGB UV IR)

7.7 Functions in 6-channel DMX mode

Channel	Value	Function
1	0...255	Intensity Red (0 % to 100 %)
2	0...255	Intensity Green (0 % to 100 %)

Channel	Value	Function
3	0...255	Intensity Blue (0 % to 100 %)
4	0...255	Intensity white (0 % to 100 %) (SePar Quad RGBW IR) Intensity UV (0 % to 100 %) (SePar Quad RGB UV IR)
5	0...255	Dimmer (0 % to 100 %)
6	0...255	Strobe effect, increasing speed

7.8 Functions in 8-channel DMX mode

Channel	Value	Function
1	0...255	Intensity Red (0 % bis 100 %), if channel 7 = 0 ... 4
2	0...255	Intensity Green (0 % to 100 %), if channel 7 = 0 ... 4
3	0...255	Intensity Blue (0 % bis 100 %), if channel 7 = 0 ... 4

Channel	Value	Function
4	0...255	Intensity white (0 % bis 100 %) (SePar Quad RGBW IR), if channel 7 = 0 ... 4 Intensity white (0 % bis 100 %) (SePar Quad RGB UV IR), if channel 7 = 0 ... 4
5	0...255	Dimmer (0 % to 100 %)
6	0...255	Strobe effect, increasing speed
7	Colour or program selection	
	0 ... 4	LEDs off (blackout)
	5 ... 9	Red
	10 ... 14	Yellow
	15 ... 19	Fawn
	20 ... 24	Green
	25 ... 29	Cyan
	30 ... 34	Blue
	35 ... 39	Purple

Channel	Value	Function
	40 ... 44	Pink
	45 ... 49	Amber
	50 ... 54	Light red
	55 ... 59	Light green
	60 ... 64	Light blue
	65 ... 69	Cold white
	70 ... 74	White (SePar Quad RGBW IR) Warm white (SePar Quad RGB UV IR)
	75 ... 79	Warm white (SePar Quad RGBW IR) UV (SePar Quad RGB UV IR)
	80 ... 89	Automatic Show 2
	90 ... 99	Automatic Show 3
	100 ... 109	Automatic Show 4

SePar QUAD LED RGB UV IR, SePar QUAD LED RGBW

Channel	Value	Function
	110 ... 119	Automatic Show 5
	120 ... 129	Automatic Show 6
	130 ... 139	Automatic Show 7
	140 ... 149	Automatic Show 8
	150 ... 159	Automatic Show 9
	160 ... 169	Automatic Show 10
	170 ... 179	Automatic Show 11
	180 ... 189	Automatic Show 12
	190 ... 255	Music-controlled automatic show, sensitivity setting with channel 8
8	0 ... 255	No function, if channel 7 = 0 ... 79 Speed of the automatic show, if channel 7 = 80 ... 189) Microphone sensitivity, if channel 7 = 190 ... 255

8 Technical specifications

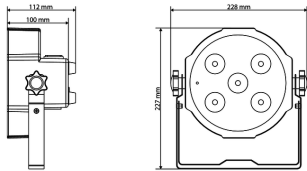

		SePar Quad RGBW IR: Item no. 399539	SePar Quad RGB UV IR: Item no. 399604
Light source		5 × 4in1 LED, 4-W (red, green, blue, white)	5 × 4in1 LED, 4 W (red, green, blue, UV)
Optical properties	Beam angle	20°	
Control	DMX		
	Remote control (optional)		

SePar QUAD LED RGB UV IR, SePar QUAD LED RGBW

		SePar Quad RGBW IR: Item no. 399539	SePar Quad RGB UV IR: Item no. 399604
Number of DMX channels	2, 4, 6, 8		
Input connections	Voltage supply	IEC chassis plug C14	
	DMX control	XLR chassis socket, 3-pin	
Output connections	Voltage supply	IEC chassis plug C13	
	DMX control	XLR chassis socket, 3-pin	
Power consumption	25 W		
Supply voltage	100 – 240 V ~ 50/60 Hz		
Fuse	5 mm × 20 mm, 1 A, 250 V, slow-blow		
Degree of protection	IP20		
Mounting options	Hanging, standing		
Dimensions (W × H × D)	180 mm × 175 mm × 85 mm		
Weight	1.1 kg (1.1 lbs)		

		SePar Quad RGBW IR: Item no. 399539	SePar Quad RGB UV IR: Item no. 399604
Ambient conditions	Temperature range	0 °C...40 °C	
	Relative humidity	50 %, non condensing	

Further information

	SePar Quad RGBW IR: Item no. 399539	SePar Quad RGB UV IR: Item no. 399604
Design	Flat PAR	Flat PAR
Colour mixture	RGBW	RGBUV
LED type	x-in-1	x-in-1
Base housing	Yes	Yes
Fanless	Yes	Yes
Remote control	Optional	Optional
Wireless DMX	No	No
Housing colour	Black	Black

9 Plug and connection assignments

Introduction

This chapter will help you select the right cables and plugs to connect your valuable equipment so that a perfect light experience is guaranteed.

Please take our tips, because especially in 'Sound & Light' caution is indicated: Even if a plug fits into a socket, the result of an incorrect connection may be a destroyed DMX controller, a short circuit or 'just' a not working light show!

DMX connections



The unit offers a 3-pin XLR socket for DMX output and a 3-pin XLR plug for DMX input. Please refer to the drawing and table below for the pin assignment of a suitable XLR plug.

Pin	Configuration
1	Ground, shielding
2	Signal inverted (DMX-, 'cold signal')
3	Signal (DMX+, 'hot signal')

10 Troubleshooting



NOTICE!

Possible data transmission errors

For error-free operation make use of dedicated DMX cables and do not use ordinary microphone cables.

Never connect the DMX input or output to audio devices such as mixers or amplifiers.

In the following we list a few common problems that may occur during operation. We give you some suggestions for easy troubleshooting:

Symptom	Remedy
The unit does not work, no light, the display is dark	Check the mains connection and the main fuse.
Apparently no function despite proper power supply	Check if the unit is in DMX mode or in 'slave' mode. If so, check the device into a different mode.
No response to the DMX controller	<p>1. If the unit is in DMX mode and the display flashes, no DMX signal is received. Check that the DMX controller is switched on. Check the DMX connectors and cables for proper connection.</p> <p>2. If the unit is in DMX mode and a DMX controller is connected and turned on, a dot on the fourth digit of the display will flash. If it doesn't, no valid DMX signal is received. Check that the DMX controller is switched on. Check the DMX connectors and cables for proper connection.</p> <p>3. If the display dot is flashing but there is still no response, check the address settings and the DMX polarity.</p>

Symptom	Remedy
	4. Try using another DMX controller.
	5. Check to see if the DMX cables run near or alongside to high voltage cables that may cause damage or interference to DMX interface circuits.

If the procedures recommended above do not succeed, please contact our Service Center. You can find the contact information at www.thomann.de.

11 Cleaning

Optical lenses

Clean the optical lenses, that are accessible from the outside, regularly in order to optimize the light output. The frequency of cleaning depends on the operating environment: wet, smoky or particularly dirty surroundings can cause more accumulation of dirt on the optics of the device.

- Clean with a soft cloth using our lamp and lens cleaner (item no. 280122).
- Always dry the parts carefully.

Fan grids

The fan grids of the device must be cleaned of any contamination, such as dust, etc. on a regular basis. Before cleaning, switch off the device and disconnect mains-operated devices from the mains. Only use pH-neutral, solvent-free and non-abrasive cleaning agents. Clean the unit with a slightly damp lint-free cloth.

12 Protecting the environment

Disposal of the packaging material



For the transport and protective packaging, environmentally friendly materials have been chosen that can be supplied to normal recycling.

Ensure that plastic bags, packaging, etc. are properly disposed of.

Do not just dispose these materials with your normal household waste, but make sure that they are fed to a recovery. Please follow the notes and markings on the packaging.

Disposal of batteries



Batteries must not be disposed of as domestic waste or thrown into fire. Dispose of the batteries according to national or local regulations regarding hazardous waste. To protect the environment, dispose of empty batteries at your retail store or at appropriate collection sites.

Disposal of your old device



This product is subject to the European Waste Electrical and Electronic Equipment Directive (WEEE) in its currently valid version. Do not dispose with your normal household waste.

Dispose this device through an approved waste disposal firm or through your local waste facility. When discarding the device, comply with the rules and regulations that apply in your country. If in doubt, consult your local waste disposal facility.

SePar QUAD LED RGB UV IR, SePar QUAD LED RGBW



Musikhaus Thomann · Hans-Thomann-Straße 1 · 96138 Burgebrach · Germany · www.thomann.de