

Quick Start Guide

This quick start guide contains important information on the safe operation of the product. Read and follow the safety advice and instructions given. Retain the quick start guide for future reference. If you pass the product on to others please include this quick start guide.

Safety instructions

Intended use

This device is used for the transmission and receiving of radio signals. Any other use or use under other operating conditions is considered to be improper and may result in personal injury or property damage. No liability will be assumed for damages resulting from improper use.

Danger for children



Ensure that plastic bags, packaging, etc. are properly disposed of and are not in the reach of babies and young children. Choking hazard! Ensure that children do not detach any small parts (e.g. knobs or the like) from

the product. They could swallow small parts and choke! Never let children play unattended with the electrical devices.

Risk of fire due to incorrect polarity

Incorrectly inserted batteries may destroy the device or the batteries. Ensure that proper polarity is observed when inserting batteries.

Possible damage by leaking batteries

Leaking batteries can cause permanent damage to the device. Take batteries out of the device if it is not going to be used for a longer period.

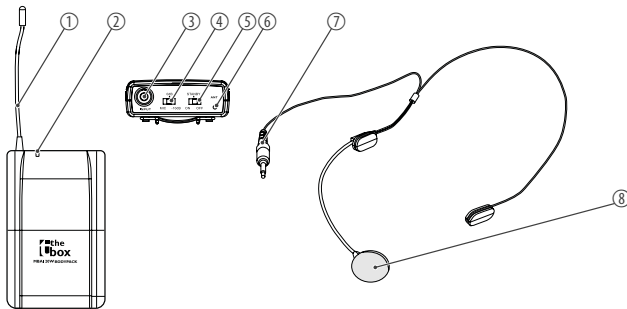

Features

- Extension kit for the speakers MBA120W and MBA120W MKII (item no. 466279 and 490317)
- contains 1 × UHF receiver, 1 × UHF bodypack transmitter, 1 × headset and 1 × receiving antenna

Operating elements

- Antenna
- Status indicator battery: green: battery capacity sufficient
red: batteries empty
- 1/4" mini jack socket to connect the headset
- Gain switch.
Switches level between [MIC], [0 dB] and [-10 dB].
- Main switch
- 1/4" mini jack socket
- Microphone

Mounting the UHF receiver

For mounting the second UHF receiver into the free slot loosen the two screws and remove the cover plate. The cables for power supply and signal transmission are already prepared and equipped with suitable plugs. Carefully loosen the cables out of the device housing and plug them to the corresponding connectors of the UHF receiver. Place the second UHF

receiver in the compartment and fasten it with the two mounting screws. Keep the cover in a safe place.

For more information refer to the user manual of the respective speaker under www.thomann.de.

Installation and replacement of batteries

The battery compartment of the UHF bodypack transmitter is located on the back of the device.

Make sure that the main switch is in position [OFF]. Open the battery compartment cover by pressing on the side latches. Insert the batteries. Pay attention to the correct location of the poles. Close the battery compartment and slide the main switch in position [ON]. The battery status indicator LED briefly lights up.

Use only AA type batteries.

Technical specifications

UHF bodypack transmitter

- Output connection headset: 1 × 1/4" mini jack socket
- Number of channels: 16
- Frequency range: 863 MHz ... 865 MHz
- Maximum transmitter power: 10 mW
- Frequency response: 50 Hz ... 16 kHz
- Battery: 2 × AA or Ni-MH batteries (nickel metal hydride)
- Dimensions (W × H × D, without ant.): 105 mm × 65 mm × 24 mm
- Dimensions antenna (W × H): 13 mm × 250 mm
- Weight: 80 g



For the packaging, environmentally friendly materials have been chosen that can be supplied to normal recycling. Ensure that plastic bags, packaging, etc. are properly disposed of. Do not just dispose of these materials with your normal household waste, but make sure that they are collected for recycling. Please follow the notes and markings on the packaging.



This product is subject to the European Waste Electrical and Electronic Equipment Directive (WEEE) in its currently valid version. Do not dispose with your normal household waste. Dispose of this device through an approved waste disposal firm or through your local waste facility. When discarding the device, comply with the rules and regulations that apply in your country. If in doubt, consult your local waste disposal facility.



Batteries do contain some hazardous chemicals so they should not be thrown away with the normal household waste. They should be returned to the manufacturer for disposal or recycled elsewhere in accordance with your local regulations.