

Millenium **Drums**

Focus Drum Set

Assembly Instructions

Drum Set

Thomann GmbH
Hans-Thomann-Straße 1
96138 Burgebrach
Germany
Telephone: +49 (0) 9546 9223-0
Internet: www.thomann.de

30.04.2024, ID: 495981, 495988, 495993, 495982, ... (V2)

Table of contents

| | | |
|----------|---|-----------|
| 1 | General information | 5 |
| | 1.1 Symbols and signal words..... | 5 |
| 2 | Safety instructions | 6 |
| 3 | Features and scope of delivery | 7 |
| 4 | Installation | 10 |
| | 4.1 Assembling the bass drum..... | 10 |
| | 4.2 Mounting the floor tom..... | 11 |
| | 4.3 Assembling the hardware package..... | 12 |
| | 4.4 Tuning the drum shells..... | 16 |
| | 4.5 Setting up the drum set..... | 18 |
| | 4.6 Assembling cymbals..... | 21 |
| 5 | Protecting the environment | 23 |



1 General information

This document contains important instructions for the safe operation of the product. Read and follow the safety instructions and all other instructions. Keep the document for future reference. Make sure that it is available to all those using the product. If you sell the product to another user, be sure that they also receive this document.

Our products and documentation are subject to a process of continuous development. They are therefore subject to change. Please refer to the latest version of the documentation, which is ready for download under www.thomann.de.

1.1 Symbols and signal words

In this section you will find an overview of the meaning of symbols and signal words that are used in this document.

| Signal word | Meaning |
|---|--|
| DANGER! | This combination of symbol and signal word indicates an immediate dangerous situation that will result in death or serious injury if it is not avoided. |
| NOTICE! | This combination of symbol and signal word indicates a possible dangerous situation that can result in material and environmental damage if it is not avoided. |
| Warning signs | Type of danger |
|  | Warning – danger zone. |

2 Safety instructions

Intended use

Use the device only as described in this user manual. Any other use or use under other operating conditions is considered to be improper and may result in personal injury or property damage. No liability will be assumed for damages resulting from improper use.

This device may be used only by persons with sufficient physical, sensorial, and intellectual abilities and having corresponding knowledge and experience. Other persons may use this device only if they are supervised or instructed by a person who is responsible for their safety.

Safety



DANGER!

Risk of injury and choking hazard for children!

Children can suffocate on packaging material and small parts. Children can injure themselves when handling the product. Never allow children to play with the packaging material and the product. Always store packaging material out of the reach of babies and small children. Always dispose of packaging material properly when it is not in use. Never allow children to use the product without supervision. Keep small parts away from children and make sure that the product does not shed any small parts that children could play with.

3 Features and scope of delivery

- See 'Focus' series with drum shells with wrap finish
- Particularly suitable for ambitious beginners
- Available as junior drum set for children aged 4 to 7
- Muffling cushion for bass drum
- Sound control rings for hanging toms and snare drum (22-inch drum set)
- Size of the bass drum: 18-inch, 20-inch or 22-inch
- Colour: Black, white or red
- Drum stool and sticks (included)
- Drum set, double-strut hardware set and brass cymbal set (included)



Before you assemble your drum set, make sure the contents of package is complete according to the following list.

Depending on the model, there can be variations in the type and number of components.



The drum set is delivered in two cardboard boxes in disassembled state. Before assembly, sort the components accordingly.

Snare drum



The snare drum is delivered fully assembled.

Bass drum



The bass drum includes the following parts:

- 1 × drum shell
- 2 × hoops
- 2 × heads (1 × batter head and 1 × resonator head)
- 16 × tension screws with washer
- 16 × claw hooks
- 2 × bass drum spurs
- 1 × damper pillow

2 × hanging toms



The hanging toms are delivered fully assembled.

Floor tom



The floor tom includes the following parts:

- 1 × drum shell
- 2 × hoops
- 2 × heads
- 12 × tension screws with washer
- 3 × floor tom foot

Hardware package



The hardware package includes the following parts:

- 1 × bass drum pedal



1 × hi-hat stand



1 × snare drum stand



1 × cymbal stand



2 × tom holders

Accessories



The accessories include the following parts:

- 1 × tuning key
- 1 pair of drumsticks
- 3 × sound control rings for hanging toms and snare drum (22-inch drum set)

Cymbals



Depending on the scope of supply, a set of cymbals is included:

- 1 × ride or crash cymbal, 16-inch
- 1 × hi-hat cymbal, 14 inch

4 Installation

4.1 Assembling the bass drum



1. ➤ Position the bass drum shell so that the screws of the tom collar point downwards.
2. ➤ Place the black resonator head on the bass drum shell.
3. ➤ Place a hoop over the resonator head.
4. ➤ Align the resonator head so that the 'Millenium' logo is parallel to the tom collar.
 - ⇒ The resonator head must be lying evenly on the edge of the bass drum shell on all sides.

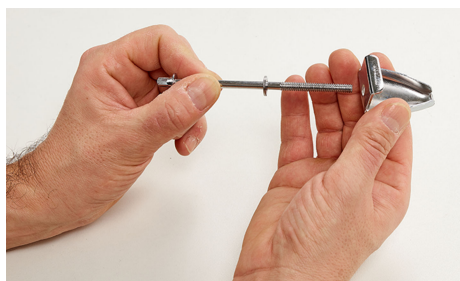

5. ➤  *The tension screws of the junior drum set are shorter than those of the standard tom. When assembling the bass drum, pay attention to the length of the tension screws.*

Place one washer and one claw hook onto each of the 16 tension screws.



6. ➤ Affix 8 tension screws to the hoop of the resonator head and tighten the tension screws slightly in crosswise fashion.
7. ➤ Turn the bass drum shell 180°.
8. ➤ Optional: Place the muffling cushion on the bass drum shell.
9. ➤ Place the transparent batter head on the bass drum shell.
10. ➤ Place the hoop over the batter head.
 - ⇒ The batter head must be lying evenly on the edge of the bass drum shell on all sides.
11. ➤ Affix 8 tension screws to the hoop of the batter head and tighten the tension screws slightly in crosswise fashion.



12. ➤ Screw the 2 bass drum feet to the designated holders.
 - ⇒ The bass drum feet are assembled and folded in.
 - ⇒ The bass drum is assembled.

4.2 Mounting the floor tom

For easier transport, the hoops are fixed in place with the tension screws on one side of the floor tom shell.



1. ▶ To assemble the heads, first release the pre-mounted tension screws.



The tension screws of the junior drum set are longer than those of the bass drum. When assembling the floor tom, pay attention to the length of the tension screws.



2. ▶ Remove the two hoops.
3. ▶ Place the head on the top of the floor tom shell with the 'Millenium' logo facing upwards. This head serves as the batter head.

4. ▶ Place a hoop over the batter head.

⇒ The batter head must be lying evenly on the edge of the floor tom shell on all sides.

5. ▶ Place one washer onto each of the 12 tension screws.

6. ▶ Affix 6 tension screws to the hoop of the batter head and tighten the tension screws slightly in crosswise fashion.

7. ▶ Screw the 3 floor tom feet to the designated holders.

⇒ The legs are assembled and turned away to the outside.

⇒ The two rear floor tom feet are attached in the middle.

⇒ The floor tom foot facing the player is fixed in place lightly and will be adjusted later when the player is seated.

8. ▶ Turn the floor tom shell 180°.

9. ▶ Place the second head on the floor tom shell. This head serves as the resonator head.

10. ▶ Place the hoop over the resonator head.

⇒ The resonator head must be lying evenly on the edge of the floor tom shell on all sides.

11. ▶ Affix 6 tension screws to the hoop of the resonator head and tighten the tension screws slightly in crosswise fashion.

⇒ The floor tom is assembled.



4.3 Assembling the hardware package

4.3.1 Assembling the bass drum pedal

Some bass drum pedals do not have a continuous floor plate. To ensure a stable support, the bass drum pedals are equipped with 2 round iron rods.

1. ➤ If there is no continuous floor plate. Press the 2 round iron rods together and insert them in the recesses on the frame of the bass drum pedal.

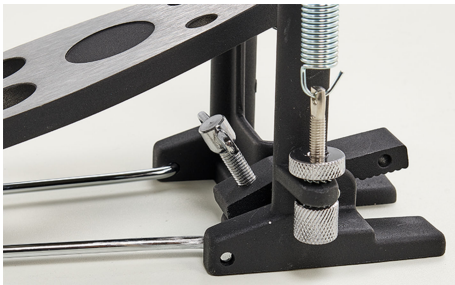
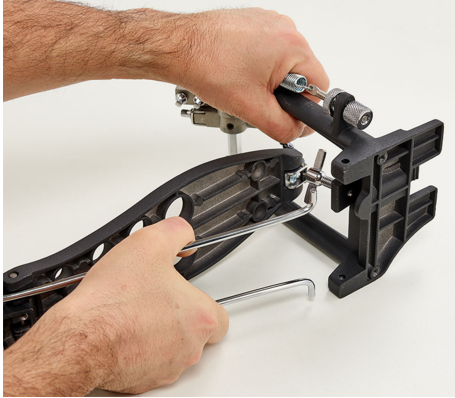

2. ➤



NOTICE!

Property damage due to incorrect assembly of the beater!

If the bottom end of the shaft is inserted too far, this can damage the bass drum head. For more information on assembly, see the user manual of the bass drum pedal.

Fix the beater in the holder.

⇒ The bass drum pedal is assembled.



4.3.2 Assembling the hi-hat stand

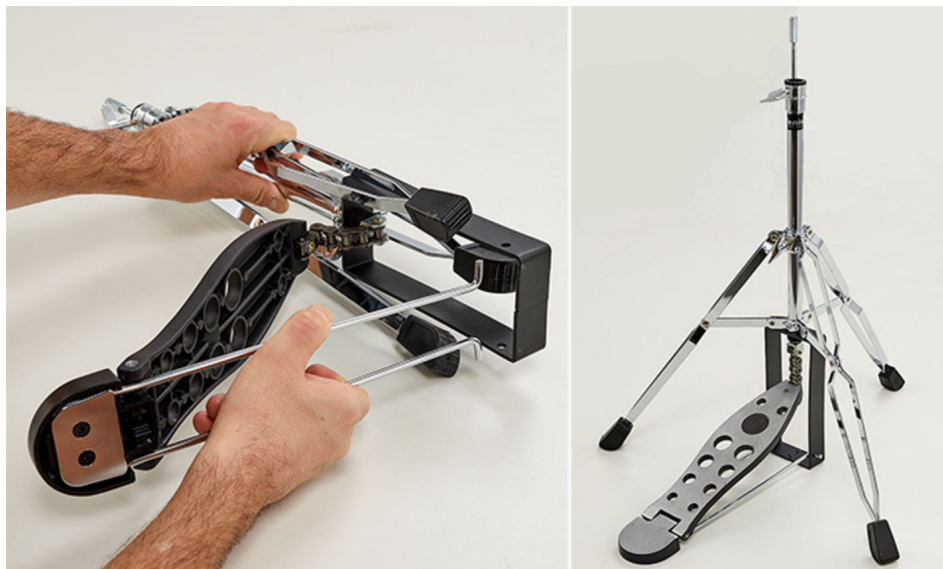

1. ➤ If there is no continuous floor plate. Press the 2 round iron rods together and insert them in the recesses on the frame of the hi-hat stand.
2. ➤ Unfold the 3 legs of the hi-hat stand until there is optimum stability between the base point of the hi-hat stand and the legs.
3. ➤ Fix the 3 legs in position with the wing screw.

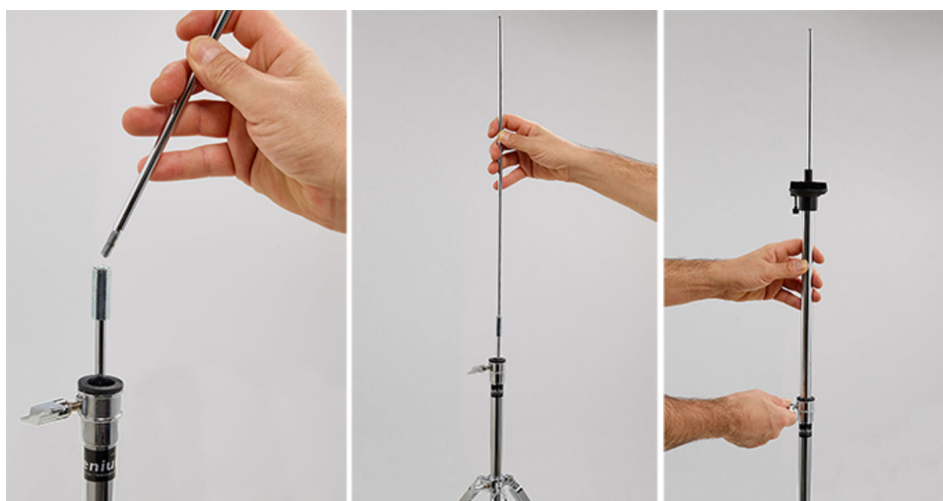

4. ➤ Fix the pull rod in place in the thread of the stand.
5. ➤ Guide the centre tube over the pull rod and fix the centre tube in place.
⇒ The hi-hat stand is assembled.

4.3.3 Assembling the snare drum stand



1. ▶ Unfold the 3 legs of the snare drum stand until there is optimum stability between the base point of the snare drum stand and the legs.
2. ▶ Fix the 3 legs in position with the wing screw.
3. ▶ Insert the upper part with the carrier arms in the bottom section and fix the upper part in place.
4. ▶ To open the carrier arms, release the union nut.
⇒ The snare drum stand is assembled.



4.3.4 Assembling the cymbal stand



1. ▶ Unfold the 3 legs of the cymbal stand until there is optimum stability between the base point of the cymbal stand and the legs.
 2. ▶ Fix the 3 legs in position with the wing screw.
 3. ▶ Put the centre tube and the spacer tube on the stand foot and fix both in place with the wing screw.
- ⇒ The cymbal stand is assembled.

4.4 Tuning the drum shells



To ensure uniform tension, the tension screws are fixed in place evenly and in cross-wise fashion. At first the tension screws are fixed with a maximum of one turn. At the end, the tension screws are fixed in place with a turn of between $\frac{1}{4}$ and $\frac{1}{8}$. To check the sound, tap the head with your finger about 3 cm from the edge. Always tap by the tension screw you are currently adjusting.



Tune the batter and resonator heads to the same pitch. You can, of course, change the pitch to match your own personal taste.

4.4.1 Tuning the snare drum

The snare drum is delivered fully assembled. Apart from a couple of minor corrections, the pitch of the snare drum should be OK.

1. ▶ To check the sound of the batter head, tap the batter head with your finger about 3 cm from the edge. Tap it by all the tension screws.
 - ⇒ The tone is the same for all tension screws.
2. ▶ Relax the snare wires on the resonator head. To do so, place a drum stick between the edge of the hoop and the snare wires. The drum stick must not touch the resonator head.
3. ▶ To check the sound of the resonator head, tap the resonator head with your finger about 3 cm from the edge. Tap it by all the tension screws.
 - ⇒ The tone is the same for all tension screws.
4. ▶ Remove the drum stick and tension the snare wires.



The tension of the snare wires has a significant effect on the vibration of the resonator head and the typical snare sound.

⇒ The snare drum is tuned.

4.4.2 Tuning the bass drum



1. ▶ Push both hands onto the batter head with moderate strength.
 - ⇒ The batter head is pushed evenly onto the bass drum shell and can make noises in the process.
2. ▶ Fix the tension screws crosswise with one turn each.
 - ⇒ The batter head generates a sound.
 - ⇒ No folds are visible on the batter head.
3. ▶ Turn the bass drum shell 180°.
4. ▶ Push both hands onto the resonator head with moderate strength.
 - ⇒ The resonator head is pushed evenly onto the bass drum shell and can make noises in the process.

- 5.** ▶ Fix the tension screws crosswise with one turn each.
 - ⇒ The resonator head generates a sound.
 - ⇒ No folds are visible on the resonator head.
 - ⇒ The bass drum is tuned.

4.4.3 Tuning hanging toms and floor tom

- 1.** ▶ To fix the batter head in place, push the batter head down with your hands.
- 2.** ▶ Fix the tension screws crosswise with one turn each.
 - ⇒ The batter head generates a sound.
 - ⇒ No folds are visible on the batter head.
- 3.** ▶ To check the sound of the batter head, tap the batter head with your finger about 3 cm from the edge. Tap it by all the tension screws.
 - ⇒ The tone is the same for all tension screws.
- 4.** ▶ Check the tone of the batter head on all 3 toms.
 - ⇒ The tones of the batter heads on all 3 tom match each other and are consistent.
- 5.** ▶ Turn the toms 180°.
- 6.** ▶ To fix the resonator head in place, push the resonator head down with your hands.
- 7.** ▶ Fix the tension screws crosswise with one turn each.
 - ⇒ The resonator head generates a sound.
 - ⇒ No folds are visible on the resonator head.
- 8.** ▶ To check the sound of the resonator head, tap the resonator head with your finger about 3 cm from the edge. Tap it by all the tension screws.
 - ⇒ The tone is the same for all tension screws.
- 9.** ▶ Check the tone of the resonator head on all 3 toms.
 - ⇒ The tones of the resonator heads on all 3 tom match each other and are consistent.
- 10.** ▶ Hit the batter head and the resonator head in alternating order.
 - ⇒ As the pitch of the resonator head approaches that of the batter head, the drum shell gets louder and clearer.
- 11.** ▶ If you tension the head too much, you lose the clear sound. Loosen all tension rods evenly with the same amount of turn and start from the beginning.



It is not possible to tune drum heads backwards individually.

4.5 Setting up the drum set

For optimum playing, we don't just need tuned drums shells; it is also necessary to position all the drums in an optimum way. The set-up that is described here is intended for right-handers. The set-up for left-handers is a mirror image of this one. A non-slip surface like a carpet or similar guarantees stability.

4.5.1 Adjusting the drum stool



➔ Adjust the height of the drum stool so that the player's thigh is almost horizontal.

⇒ The drum stool is adjusted.

4.5.2 Setting up the snare drum stands



1. ➔ Attach the snare drum stands to the snare drums. To do so, open the arms of the snare drum stand until the arms reach over the lower hoop.

2. ➔ Fix the union nut in place.



Make sure that the arms do not interfere with the snare wire or the throw-off lever.

⇒ The throw-off lever is facing the player.

3. ➔ Adjust the height of the snare drums so that the hands touch the batter head with the sticks but the hands are not touching the thigh.

4. ➔ Tilt the snare drums slightly towards the player to make drumming and rim-shots easier.

⇒ The snare drum stands are set up.



4.5.3 Setting up the bass drum



1. ▶ Unfold the bass drum feet until they are facing forward at an angle of approx. 45°.

2. ▶ If there is a carpet under the drum set, screw in the rubber feet until you can see the spikes.

⇒ These spikes hook into the carpet and prevent the bass drum moving.



3. ▶ Adjust the length of the bass drum feet so there is a roughly finger-wide gap between the floor and the lower edge of the hoops.

⇒ The bass drum shell is not tilted forwards or backwards.

4. ▶ Use the tuning key to fix the memory clamps in place.

⇒ The adjustments of the bass drum feet are retained (even after dismantling).



5. ▶ Push the pre-assembled bass drum pedal onto the hoop.

6. ▶ Fix the bass drum pedal with the claw.



You can use adhesive tape to avoid scratching the hoop.



7. ▶ Attach the tom collar of the tom holders to the bass drum.



The tom collar is designed for one or two tom holders. If you are only using one tom holder, you can attach an adapter instead.



8. ▶ Fix the memory clamps in place.

⇒ The settings of the tom holders are retained (length and angle of tom holders).

⇒ The bass drum is set up.

4.5.4 Aligning the bass drum and hi-hat



1. Place the bass drum on the right and the hi-hat stand on the left of the snare drum.

- ⇒ The snare drum is between the player's knees, but the knees are not touching the snare drum.
- ⇒ The bass drum pedal and the hi-hat pedal are in the same place as the feet of the player when the player is sitting upright. The pedals form a V shape pointing towards the drum stool.
- ⇒ The lower hoop of the snare drum is just above the bass drum's hoop.

2. Attach the small hanging tom to the left tom holder and the large hanging tom to the right tom holder.

- ⇒ Each tom holder is at a right angle to the hanging tom.



In the junior drum set, the hanging toms have a hole, and the tom holders are pushed into the hanging toms.

3. Adjust the height and angle of the hanging toms so that the hands touch the batter head with the sticks but the hands are not touching the thigh.

- ⇒ The hanging toms are not touching each other or the bass drum.

4. Set up the floor tom next to the player's right thigh.

- ⇒ The snare drum, the floor tom and the player's leg have enough space.

5. Adjust the height of the floor tom according to the height of the snare drum.

- ⇒ Both hoops are at the same height.
- ⇒ The floor tom's batter head is not angled; rather, it is horizontal.
- ⇒ Viewed from above, the snare drum, the hanging toms and the floor tom are aligned in a V shape.

6. Optional for the 22-inch drum set: attach the transparent sound rings (muffling rings) to the hanging toms and the snare drum.

- ⇒ The drum set is set up.

4.6 Assembling cymbals

4.6.1 Assembling the hi-hat cymbal



1. ➤ Place a metal washer and a felt disk on the hi-hat stand.
2. ➤ Place the lower cymbal (labelled 'bottom') on the hi-hat stand.



3. ➤ Attach the upper cymbals (labelled 'top') with the hi-hat clutch holding system. To do this, turn the holder upside down and lay it in the palm of your hand.
4. ➤ Place a felt disk, the upper cymbal (with the curvature facing down), another felt disk, a washer and a screw connection on the holder.



5. ➤ Push the upper cymbal on the pull rod so it lies loosely on the lower cymbal.



6. ➤ Adjust the height of the hi-hat stand so that the bottom of the hi-hat cymbal is about the width of your hand above the snare drum's hoop.
 7. ➤ Now push the hi-hat pedal half-way down and tighten the wing screw of the hi-hat clutch.
- ⇒ The hi-hat cymbal is assembled.

4.6.2 Assembling the ride or crash cymbal



1. ➤ Assemble the ride or crash cymbal between the floor tom and the right hanging tom. To do so, place a metal washer and a felt disk on the cymbal stand.



2. ➤ Place the ride or crash cymbal on the felt disk.
 3. ➤ Place another felt disk on the ride or crash cymbal and fix the cymbal in place with the wing screw.
- ⇒ The ride or crash cymbal is assembled.



⇒ The drum set is assembled.

5 Protecting the environment

Disposal of the packing material

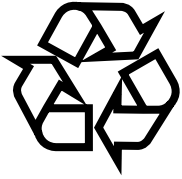

Environmentally friendly materials have been chosen for the packaging. These materials can be sent for normal recycling. Ensure that plastic bags, packaging, etc. are disposed of in the proper manner.

Do not dispose of these materials with your normal household waste, but make sure that they are collected for recycling. Please follow the instructions and markings on the packaging.

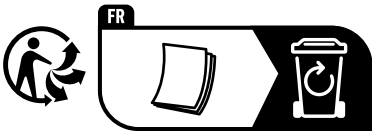

Observe the disposal note regarding documentation in France.

