

VicBooth Premium

INSTALLATION PROCEDURES

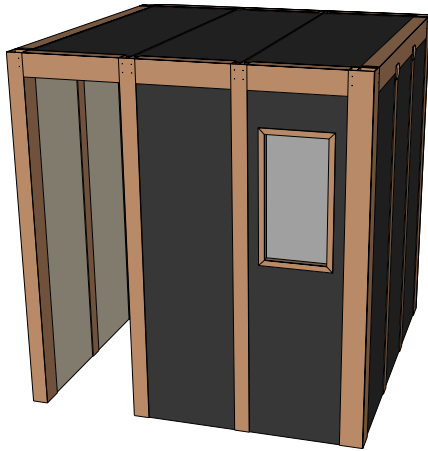

Required Apparatus:

Numbered Wood Items

- 3 x Part 1
- 3 x Part 2
- 4 x Part 3
- 1 x Part 4
- 1 x Part 5
- 1 x Part 6
- 1 x Part 7
- 2 x Part 8
- 5 x Part 9
- 1 x Part 10
- 2 x Part 11

Numbered Panels

- 10 x Panel 12
- 3 x Panel 13
- 1 x Panel 14
- 2 x Panel 15

Accessories

- 32 x Screw (3x20 Philips Head)
- 32 x Screw Stickers

Bill of Materials 1/2

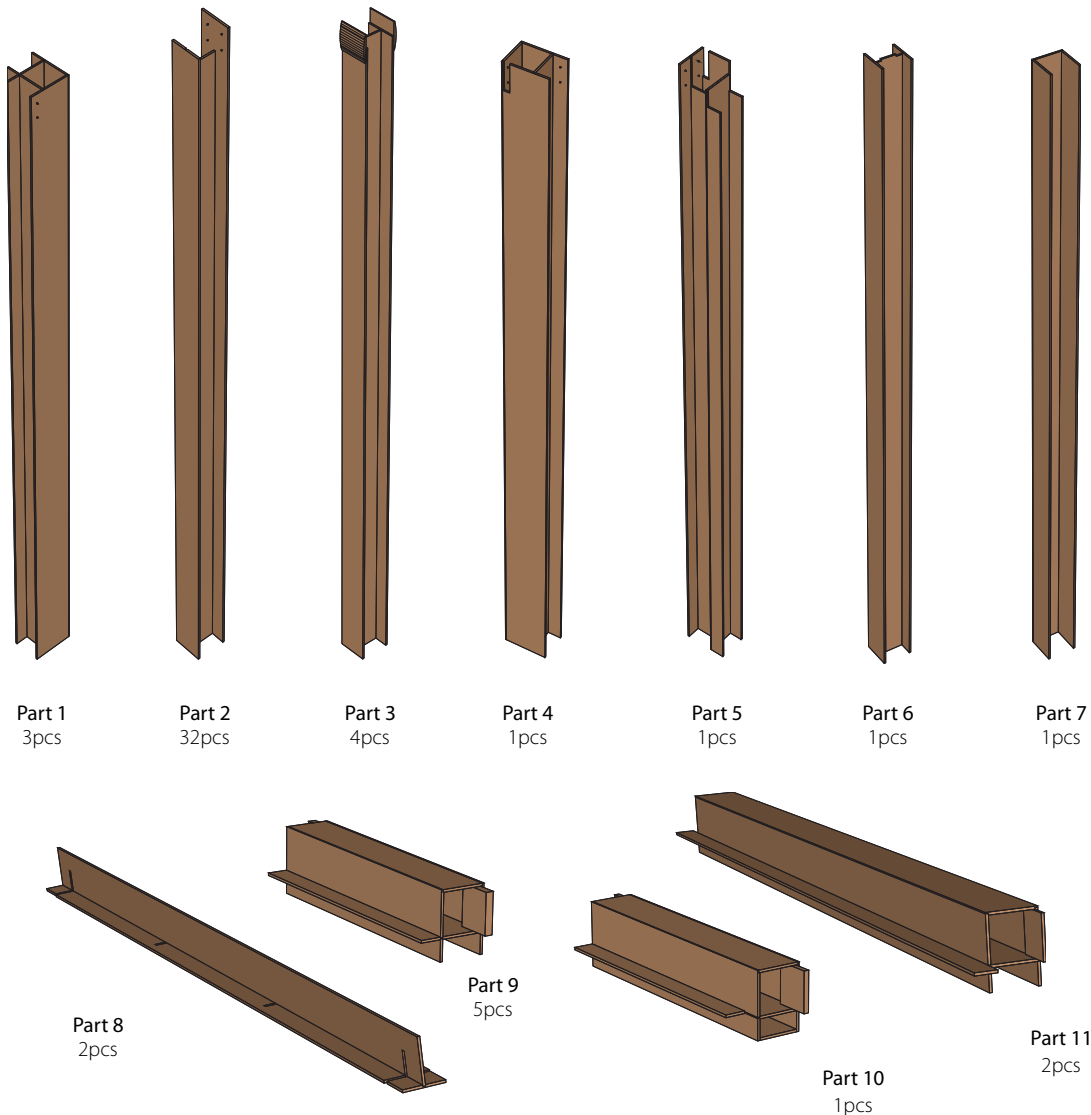

VicBooth Premium

INSTALLATION PROCEDURES

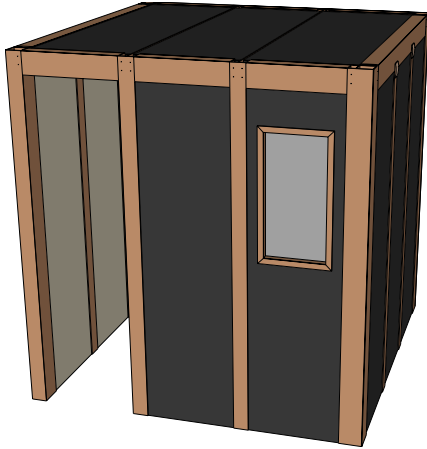

Required Apparatus:

Numbered Wood Items

- 3 x Part 1
- 3 x Part 2
- 4 x Part 3
- 1 x Part 4
- 1 x Part 5
- 1 x Part 6
- 1 x Part 7
- 2 x Part 8
- 5 x Part 9
- 1 x Part 10
- 2 x Part 11

Numbered Panels

- 10 x Panel 12
- 3 x Panel 13
- 1 x Panel 14
- 2 x Panel 15

Accessories

- 32 x Screw (3x20 Philips Head)
- 32 x Screw Stickers

Bill of Materials 2/2

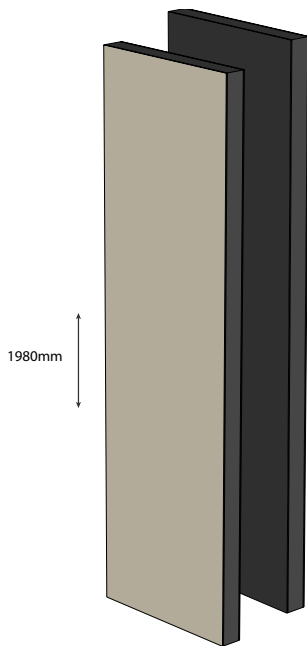

Part 12
10pcs

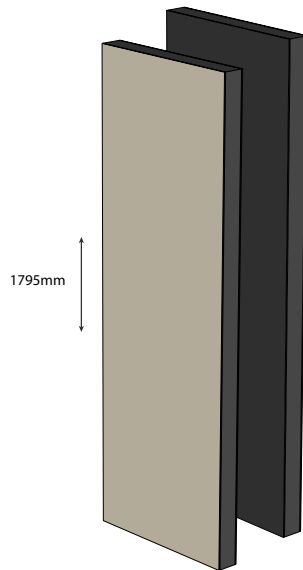

Part 13
3pcs

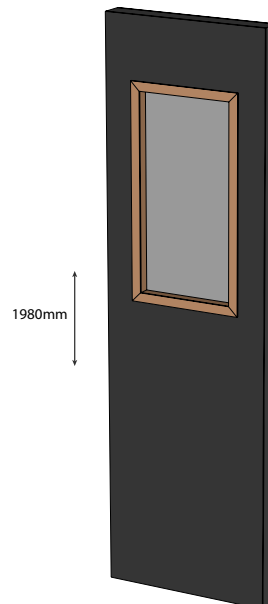

Part 14
1pcs

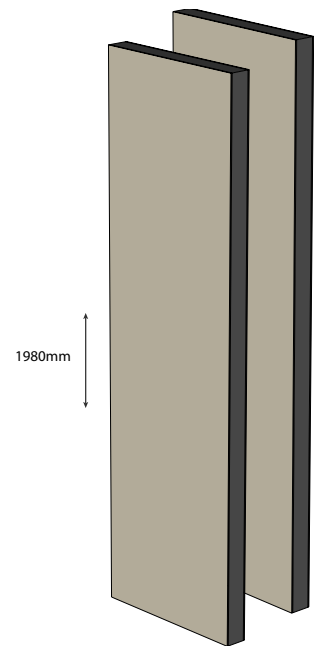

Part 15
2pcs

Step 1

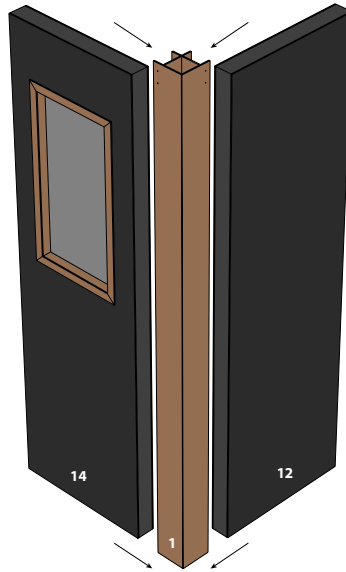

Step 2

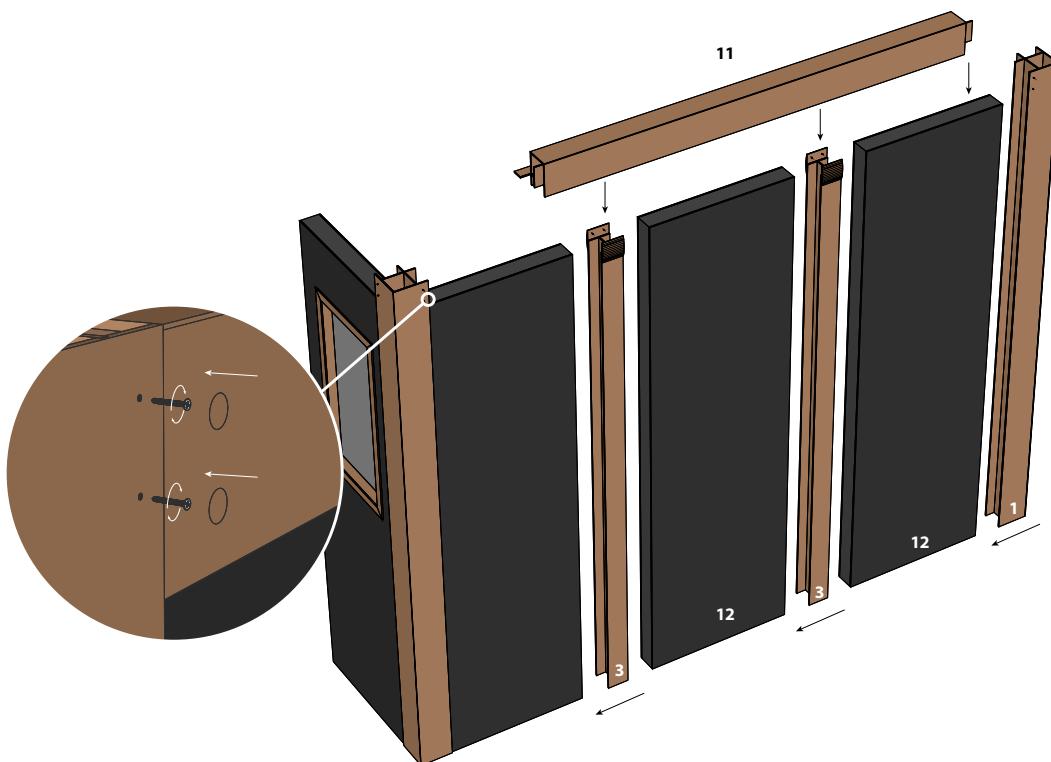

VicBooth Premium

INSTALLATION PROCEDURES



Step 3

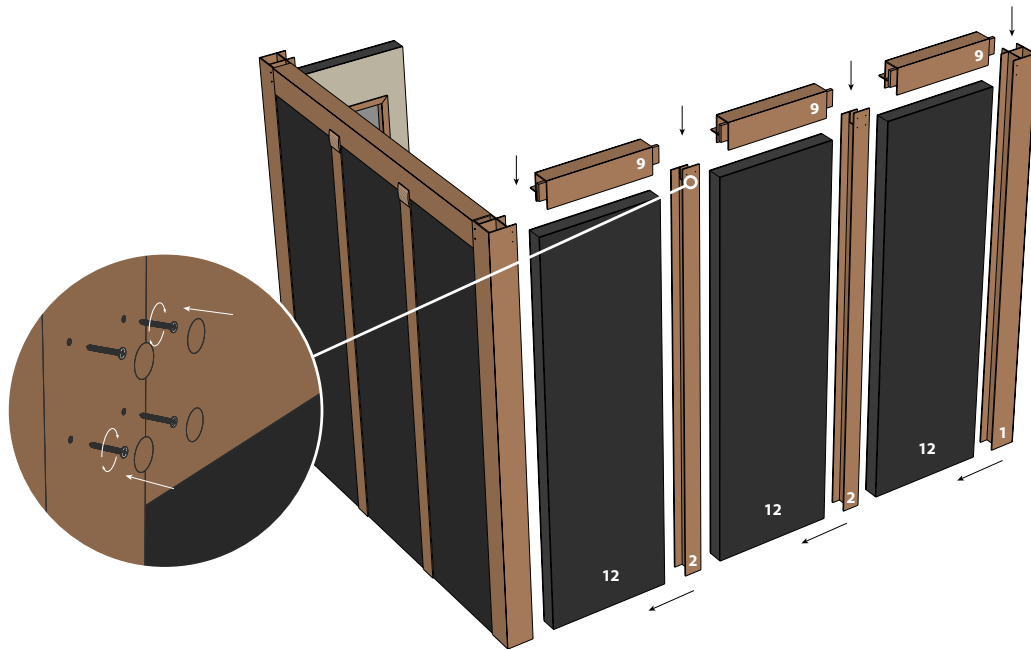

Step 4

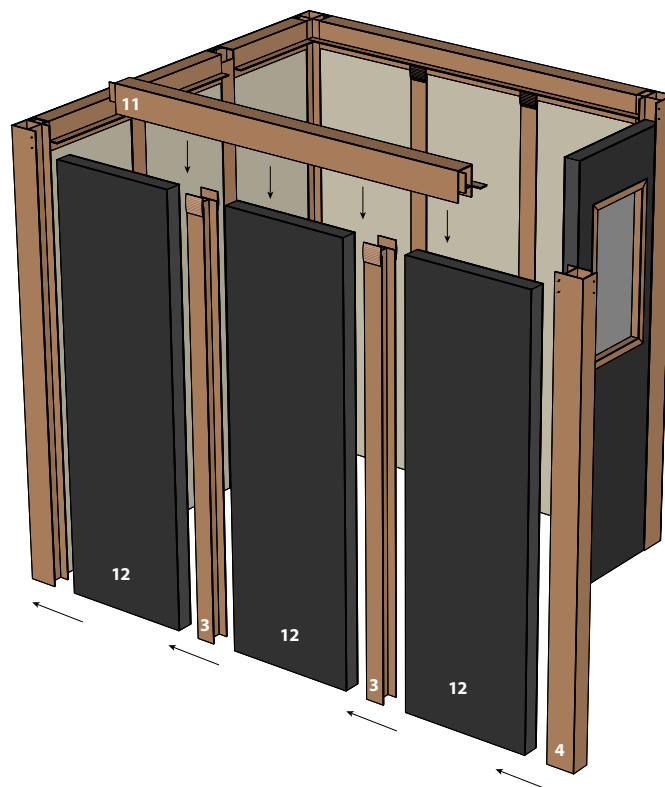

VicBooth Premium

INSTALLATION PROCEDURES



Step 5



Step 6

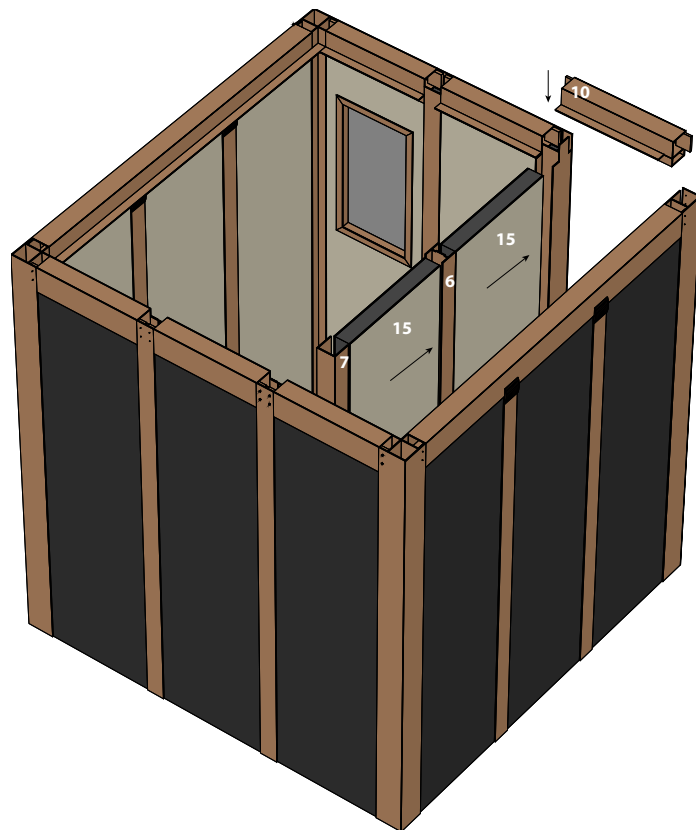

VicBooth Premium

INSTALLATION PROCEDURES



Vicoustic
Innovative Acoustic Solutions

Step 7

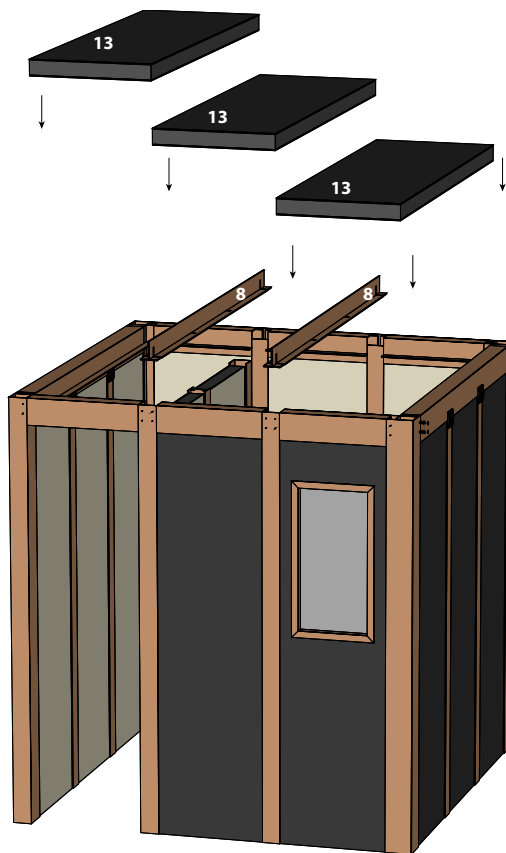

Step 8 (optional)

