

## Manual

### Edge™ Mic Converter



Congratulations and thank you for purchasing a FINHOL product. FINHOL produces at highest standards. All Finhol products are strictly quality inspected before delivery.

If you want to connect one of the various Edge Mic™ Microphones to an unbalanced input, such as small 2-channel acoustic guitar AMP's, or effects devices such as looper, compressor, chorus, reverb, delay, boosters, etc., you need the Edge™ Mic Converter.

This unit provides on the one hand the necessary phantom-power and converts at the same time in addition the balanced signal into an unbalanced signal.

The device also has an integrated microphone preamp, which can raise the input signal up to 40 dB. By means of a knob, you can adjust the level of the output signal.

The converter can be operated both, with an internal battery, as well as with an external power supply.

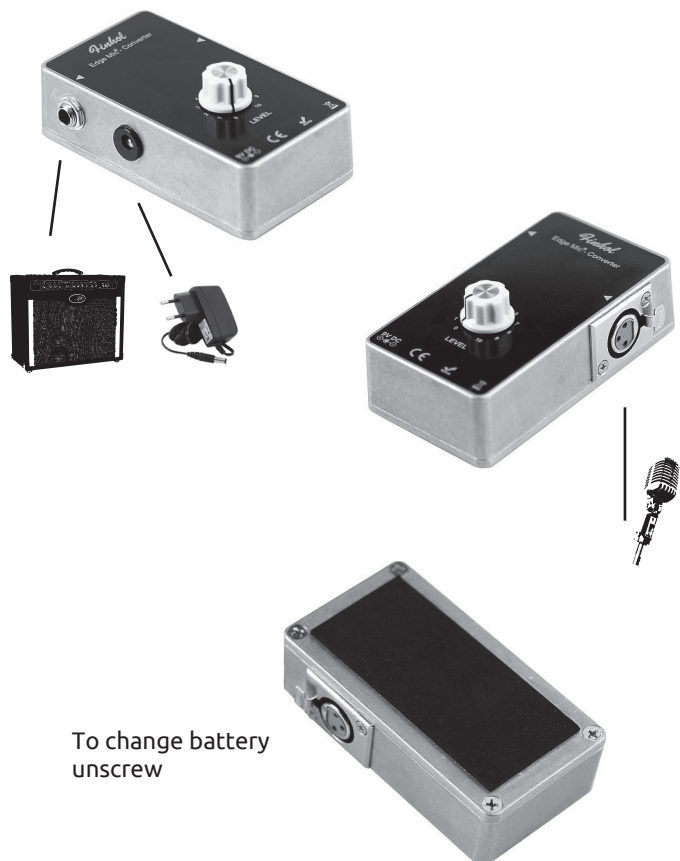

To change battery  
unscrew

## Technical Data

- Phantom power: 9 V / 10 mA
- Symmetry Converting: Balanced - Unbalanced
- Adjustable pre-amplification: 0 - 40 dB (factor of approx. 0-100> max 500 mV)
- Weight: approx. 235 gr
- Anti-slip mat
- Output Connector: 6.3mm unbalanced (unit is turned on plugged in)
- Input connector: XLR balanced
- DC jack: for 9 V power supply (- Pin / + Housing)
- Battery compartment inside: 9 V block
- CE, ROHS, Made in Germany

### Warning!

Store the product in a place that is neither excessively dry nor excessively moist. And since the temperature influences the humidity neither excessively hot ore excessively cold.

Don't take this product apart and don't try to repair it yourself.

Always keep this product in a case ore gigbag, to it's safety.

The + (plus) - (minus) contacts of battery or accumulator and battery compartment must match. Inserted the wrong way (reverse polarity wich means + on - and - on +) the electronics will not work and can be damaged. Also the battery or accumulator could overheat in certain circumstauces and thereby damage the product ore it could start a fire.

Only use highquality batteries or accumulators.

Always turn the product off after use, by pulling all plugs otherwise the battery or accumulator could discharge through standby current.

If you shouldn't use this product for more than 1 week, please take the battery or accumulator out of the compartment. With batteries and accumulators there is always the risk of leakage wich could highly damage your product.

Always dispose the batteries and accumulators properly. Don't ever throw batteries or accumulators into fire, this could cause an explosion and severe injuries.-

Finhol Beteiligungsgesellschaft mbH  
Geschäftsbereich Musikinstrumente und Zubehör  
Geschäftsführer: Udo Amend  
Registergericht: Amtsgericht Mannheim  
Nobelstr. 9 - 13 • D-76275 Ettlingen  
www.shop finhol.de • finhol@gmx.de  
HRB: 106334 • St. Nr.:35006/04661 • USt-IdNr.: DE156664640  
WEEE-Reg. Nr. DE 508 98 772