

Drums
Millenium

MPS-750X, MPS-750X PRO

E-Drum Module

Thomann GmbH
Hans-Thomann-Straße 1
96138 Burgebrach
Germany
Telephone: +49 (0) 9546 9223-0
Internet: www.thomann.de

28.09.2023, ID: 493327, 561586, 464015 (V6) Software V4.20

Table of contents

| | | |
|-----------|--|-----------|
| 1 | General information..... | 6 |
| 1.1 | Symbols and signal words..... | 6 |
| 2 | Safety instructions..... | 8 |
| 3 | Features..... | 10 |
| 4 | Installation and starting up..... | 11 |
| 5 | Connections and controls..... | 15 |
| 6 | Operating..... | 19 |
| 6.1 | Functions..... | 19 |
| 6.2 | Device settings..... | 25 |
| 6.3 | Connecting the device via Bluetooth®..... | 30 |
| 6.4 | Reset to factory defaults..... | 31 |
| 7 | Technical specifications..... | 32 |
| 8 | Plug and connection assignment..... | 35 |
| 9 | Cleaning..... | 37 |
| 10 | Protecting the environment..... | 38 |
| 11 | Appendix..... | 39 |
| 11.1 | Voice list..... | 39 |
| 11.2 | Kit list..... | 54 |

11.3 Styles..... 55



1 General information

This document contains important instructions for the safe operation of the product. Read and follow the safety instructions and all other instructions. Keep the document for future reference. Make sure that it is available to all those using the product. If you sell the product to another user, be sure that they also receive this document.

Our products and documentation are subject to a process of continuous development. They are therefore subject to change. Please refer to the latest version of the documentation, which is ready for download under www.thomann.de.

1.1 Symbols and signal words

In this section you will find an overview of the meaning of symbols and signal words that are used in this document.

| Signal word | Meaning |
|---|--|
| DANGER! | This combination of symbol and signal word indicates an immediate dangerous situation that will result in death or serious injury if it is not avoided. |
| WARNING! | This combination of symbol and signal word indicates a possible dangerous situation that can result in death or serious injury if it is not avoided. |
| NOTICE! | This combination of symbol and signal word indicates a possible dangerous situation that can result in material and environmental damage if it is not avoided. |
| Warning signs | Type of danger |
|  | Warning – danger zone. |

2 Safety instructions

Intended use

Drum modules are intended to be used for converting digital trigger signals from drum pads to various percussion sounds. Use the unit only as described in this manual. Any other use or use under other operating conditions is considered to be improper and may result in personal injury or property damage. No liability will be assumed for damages resulting from improper use.

This device may be used only by persons with sufficient physical, sensorial, and intellectual abilities and having corresponding knowledge and experience. Other persons may use this device only if they are supervised or instructed by a person who is responsible for their safety.

Safety



DANGER!

Risk of injury and choking hazard for children!

Children can suffocate on packaging material and small parts. Children can injure themselves when handling the device. Never allow children to play with the packaging material and the device. Always store packaging material out of the reach of babies and small children. Always dispose of packaging material properly when it is not in use. Never allow children to use the device without supervision. Keep small parts away from children and make sure that the device does not shed any small parts (such knobs) that children could play with.

**WARNING!****Possible hearing damage due to high volumes on speakers or headphones!**

With speakers or headphones connected, the device can produce volume levels that may cause temporary or permanent hearing impairment. Over an extended period of time, even levels that seem to be uncritical can cause hearing damage. Do not operate the device permanently at a high volume level. Decrease the volume level immediately if you experience ringing in your ears or hearing impairment.

**NOTICE!****Damage to the device if operated in unsuitable ambient conditions!**

The device can be damaged if it is operated in unsuitable ambient conditions. Only operate the device indoors within the ambient conditions specified in the “Technical specifications” chapter of this user manual. Avoid operating it in environments with direct sunlight, heavy dirt and strong vibrations. Avoid operating it in environments with strong temperature fluctuations. If temperature fluctuations cannot be avoided (for example after transport in low outside temperatures), do not switch on the device immediately. Never subject the device to liquids or moisture. Never move the device to another location while it is in operation. In environments with increased dirt levels (for example due to dust, smoke, nicotine or mist): Have the device cleaned by qualified specialists at regular intervals to prevent damage due to overheating and other malfunctions.

**NOTICE!****Damage to the external power supply due to high voltages!**

The device is powered by an external power supply. The external power supply can be damaged if it is operated with the incorrect voltage or if high voltage peaks occur. In the worst case, excess voltages can also cause a risk of injury and fires. Make sure that the voltage specification on the external power supply matches the local power grid before plugging in the power supply. Only operate the external power supply from professionally installed mains sockets that are protected by a residual current circuit breaker (FI). As a precaution, disconnect the power supply from the power grid when storms are approaching or if the device will not be used for a longer period.

3 Features

- 697 sounds
- 55 styles
- 20 drum kits
- 20 user kits
- Metronome
- 4-band equalizer (DSP)
- Reverb effect, distortion (FX) and compressor
- Recording function
- Flexible pad assignment
- Bluetooth®
- Connections: Headphones, external trigger, USB, line out, line in
- Standby function

4 Installation and starting up

Rack setup, connecting pads and pedals

Rack setup and assembly of the pads and pedals are described in detail in the enclosed set assembly guide. Finally check that all cables between the pads and the drum module have been properly connected.

Connecting the pads

Connect the supplied D-sub plug of the pad connector cable to the D-sub input socket on the bottom side of the drum module.

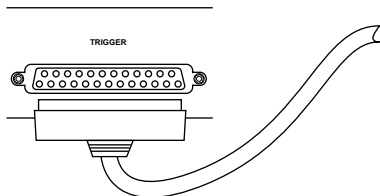

Connecting the power adapter

Connect the included power supply unit to the [DC 12 V] input on the rear panel of the drum module and then put the power plug into the power outlet.

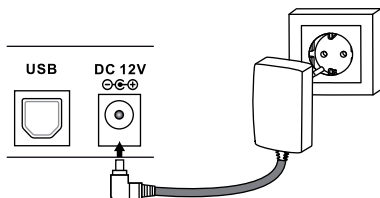

Connecting USB devices

Connect your computer to the USB port on the rear panel of the drum module.

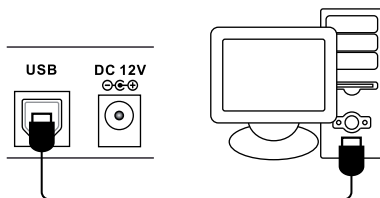

Connecting audio devices

Connect the inputs of your amplifier or active monitor to the output sockets *[LINE OUT]* on the rear panel of the drum module. Connect a CD or MP3 player etc. to the *[LINE IN]* input socket on the rear panel of the drum module.

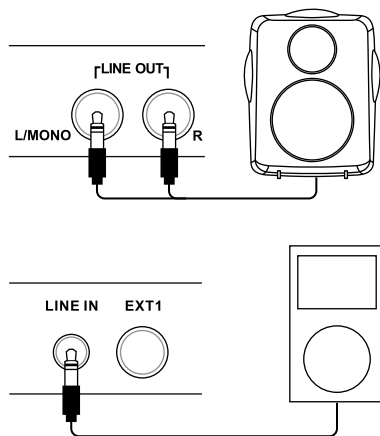

Connecting headphones

Connect your stereo headphones to the *[HEADPHONE]* output on the rear panel of the drum module.

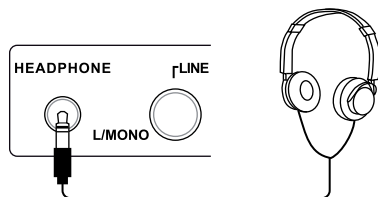

5 Connections and controls

Front

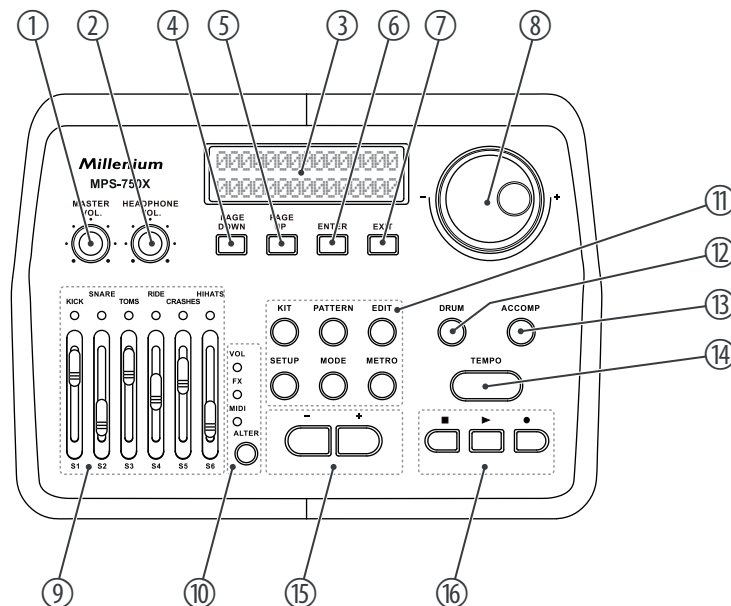

| | |
|----|--|
| 1 | [MASTER VOL.] Rotary control for adjusting the line out volume |
| 2 | [HEADPHONE VOL.] Rotary control for adjusting the headphone output volume |
| 3 | Backlit display |
| 4 | [PAGE DOWN] Button for scrolling forwards through the open menu |
| 5 | [PAGE UP] Button for scrolling backwards through the open menu |
| 6 | [ENTER] Enter button to confirm a selection or change |
| 7 | [EXIT] Return key to exit a menu or to discard changes |
| 8 | Rotary control [-] / [+] Increases or decreases the value of the currently selected parameter |
| 9 | Fader S1 ... S6 for the connected pads, function depends on the [ALTER] selection (10) |
| 10 | [ALTER] Selector switch for the operating mode of faders S1 ... S6: Volume, FX or MIDI. The control LED of the enabled function lights up. |
| 11 | [KIT] Button for activating "Kit" mode |
| | [PATTERN] Button for activating "Pattern" mode |
| | [EDIT] Button for opening the programming menu |
| | [SETUP] Button for opening the device settings menu |
| | [MODE] Button for switching between operating modes |
| | [METRO] Button for turning the metronome on and off and opening the click menu |

| | |
|----|--|
| 12 | [<i>DRUM</i>] Button for muting the drum track of a style |
| 13 | [<i>ACCOMP</i>] Button for muting the accompaniment track of a style |
| 14 | [<i>TEMPO</i>] Button for adjusting the metronome tempo and the tempo for recording and playback |
| 15 | [-] [+] Button to increase or decrease the displayed value and to select a kit |
| 16 | ■ Button to end style playback and to stop recording |
| | ► Button to start style playback |
| | ● Button to start recording |

Back

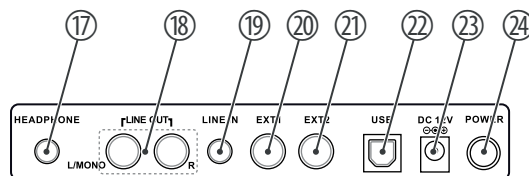

| | |
|----|---|
| 17 | [HEADPHONE] Headphone output |
| 18 | [LINE OUT] Output socket for connecting an amplifier or active monitor (mono left, stereo left/right) |
| 19 | [LINE IN] Input socket for connecting audio devices such as CD and MP3 players etc. |
| 20 | [EXT1] Input for connecting an external trigger, cymbal pad |
| 21 | [EXT2] Input for connecting an external trigger, mesh head pad or bar trigger pad |
| 22 | [USB] USB port for connecting a computer with USB-MIDI interface |
| 23 | [DC 12V] Connection socket for the power adapter for power supply |
| 24 | [POWER] Main switch for turning the device on and off |

6 Operating

6.1 Functions

Switching on



Check all cable connections for correct fit before switching on.

Before switching on, turn both volume controls of the drum module down to minimum.

Use the main switch *[POWER]* on the rear panel to switch the drum module on.

Standby function

The unit automatically switches to standby mode when you don't press any key or strike a connected pad for about 30 minutes. Then press the main switch *[POWER]* to turn the device back on again.

Selecting a drum kit

A drum kit is a compilation in which a certain sound and several sound parameters are assigned to each trigger. Selecting different drum kits lets you customise the sound of your e-drum set in seconds to the desired music genre.

1. ➤ Press *[KIT]*.

⇒ The first kit appears on the display.

2. ➤ Use the *[-]* / *[+]* buttons or the *[-]* / *[+]* rotary control to select the desired kit.

Customising a drum kit

The preprogrammed sounds of the drum module can be programmed to any of the connected pads. So you can create user kits and store them in the device. To do so proceed as follows:

1. ➤ First, call up one of the available drum kits (see previous chapter) and use *[EDIT]* to switch to Edit mode.
2. ➤ Hit the pad (Trigger) to which you want to programme a certain sound or press *[DRUM]* repeatedly until the desired pad is shown on the display. Additionally select the specific trigger for multiple assigned pads.
3. ➤ Use *[PAGE DOWN]* or *[PAGE UP]* to successively open the following selection menus and use the *[-]* / *[+]* rotary control or the *[-]* | *[+]* buttons to adjust the settings for the activated trigger.

| Selection menu | Value range |
|----------------|---|
| VOICE TYPE | Kick, Snare, Tom, Ride, Crash, Hi-Hat, Metro, Extras |
| VOICE | Voice selection, see |
| VOLUME | Volume |
| REVERB | Reverb effect |
| PITCH | Pitch |
| PAN | Position within the stereo signal (panorama right / left) |

4. ➤ Quit the selection menu with *[EXIT]*.
 - ⇒ Use *[-]* | *[+]* in the following saving dialogue to specify the memory location. Existing data will be overwritten.

5. ➤ Confirm with *[ENTER]* or cancel saving with *[EXIT]*.
6. ➤ Select if necessary the next trigger, to which you want to programme a sound. Use *[EXIT]* to exit the Edit mode.

Style playing

Your digital drum set has a total of 40 preprogrammed Styles, which can be played individually in the 'Pattern' mode.

1. ➤ Press the *[PATTERN]* button.
⇒ The display shows the first Style in '01 WalkWithTree' format.
2. ➤ Use the *[-] / [+]* rotary control or the *[-] | [+]* buttons to select the Style you want to play.
3. ➤ Start and stop playback with the ► and ■ buttons.

Metronome function

Press *[METRO]* to turn the Metronome on. Then you hear the Metronome sound. Proceed as follows to adjust the metronome settings:

1. ➤ Use *[PAGE DOWN]* or *[PAGE UP]* to successively open the following selection menus and use the *[-]* / *[+]* rotary control or the *[-]* | *[+]* buttons to adjust the settings as desired.

| Selection menu | Value range |
|----------------|-----------------|
| VOLUME | Volume |
| TEMPO | Speed |
| TIME SIGNATURE | Time signature |
| SOUND | Metronome sound |

2. ➤ Quit the selection menu with *[EXIT]*.

The click tempo can additionally be adjusted as follows: Press *[TEMPO]* and adjust the tempo using the *[-]* / *[+]* rotary control.

or

Tap four times in succession and at the desired tempo the *[TEMPO]* button (tap tempo function). The new value is instantly applied.

Press *[METRO]* again to turn the Metronome off.

Recording function

The drum module offers the possibility to record up to 15 user drum tracks in the operating modes 'Kit' or 'Pattern'. To do so proceed as follows:

1. ➤ Activate one of the operating modes 'Kit' or 'Pattern'.
2. ➤ Press ● to activate the recording mode.
3. ➤ If desired, specify the metronome settings for the recording.
4. ➤ Press ● again to start the recording.
5. ➤ Press ■ to stop the recording and ● to restart.
To finally stop recording press ■ twice.
⇒ The display shows the message 'Save the song to'.
6. ➤ Use [-] | [+] to specify the memory location. Existing data will be overwritten.
7. ➤ Confirm with [ENTER] or cancel saving with [EXIT].



In 'Pattern' mode you can add a style.

Mixer function

The function of faders S1 ... S6 of the drum module depends on the selected operating mode. Use *[ALTER]* to toggle between VOL, FX and MIDI. The control LED of the activated operating mode lights up.

| Operating mode | Fader function |
|----------------|--|
| VOL | Volume control for the assigned pad. |
| FX | Fader S1: Reverb control Fader S2: Compression control Fader S3 ... S6: 4-Band-EQ controls |
| MIDI | In MIDI operation, each fader S1 ... S6 is assigned to one controller, the function is specified in the settings of the installed DAW. |



If you have set one of the faders to a certain value in one of the operating modes and then repeatedly change the operating mode you first have to slide the fader over the previously set value in the initial mode.

Example: If you set fader S1 in VOL mode to value '127', then change to FX mode and set the fader to '0', then change back to VOL mode, you first have to set the fader back to value '127' to get a response.

» *Continued on the next page*

This function prevents sudden volume jumps or changes of effect settings by moving the faders in the three modes.

6.2 Device settings

Various device settings can be customised in the Setup menu.

Press **[SETUP]** to enter the menu. Use **[PAGE DOWN]** or **[PAGE UP]** to select the desired option and use the **[-] / [+]** rotary control or the **[-] | [+]** buttons to adjust the settings as desired.

Quit the selection menu with **[EXIT]**.

Confirm the respective security prompt with **[ENTER]** to accept the new value, or cancel all changes with **[EXIT]**.

| Parameter | Function |
|-------------|--|
| BACK VOLUME | Volume preset for all Styles and Loops. |
| MASTER TUNE | Pitch preset, on delivery set to standard A / 440 Hz. |
| LOCAL | Set the Parameter for normal operation to 'ON': the module plays the programmed sound files. Set the Parameter for MIDI operation to 'OFF' (low latency): the module transfers MIDI data. |

| Parameter | Function | |
|------------|---|--|
| FX SET | Fader function preset. Make the following settings either directly with the fader or use the <i>[PAGE UP]</i> / <i>[PAGE DOWN]</i> buttons: | |
| | Reverb Type | Reverb preset (effect type), fader S1. |
| | Dist.Pst | Distortion preset (effect type). |
| | Threshold | Compressor threshold preset, fader S2. |
| | LowFrq | Preset for low frequency control range, fader S3. |
| | LoMiFrq | Preset for low mid frequency control range, fader S4. |
| | HiMiFrq | Preset for high mid frequency control range, fader S5. |
| | HiFrq | Preset for high frequency control range, fader S6. |
| MIDI SET | Assignment of faders S1 ... S6 to the MIDI controllers. | |
| FADER MODE | Setting the fader positions | |
| | Save | The fader positions are saved when switching off the device. |
| | Cancel | The fader positions are not saved when switching off the device. |
| | Lock | The fader positions are locked and cannot be set individually. |
| ADVANCED | Pad or trigger parameter preset: | |

| Parameter | Function | |
|-----------|-------------------|---|
| | Sensitivity | The touch sensitivity regulates the volume behaviour of a pad regardless of the actual strike intensity. The higher the value, the higher the volume when playing, and vice versa. |
| | Headroom | This parameter is used to preset the level reserve between normal and maximum level when playing the pads. |
| | SenseTime | Presetting the minimum time interval between two signals from the same trigger prevents unwanted sound overlays by vibrations. |
| | Trigger | The trigger curve regulates the velocity, i.e. the ratio between the punch and volume. Use setting ' <i>Linear</i> ' for the most natural ratio between punch and volume. Use ' <i>Exp</i> ' if you want a hard strike to cause a bigger volume change (or dynamics). Use ' <i>Log</i> ' if you want a soft strike to cause a bigger change. With the setting ' <i>Spline</i> ' the volume changes less upon a change of the strike. High volumes are already reached at a relatively low strike intensity. |
| | Peak Decay | Setting the time period how long after signal input of the selected pad no other signal is accepted. The higher the value is, the lower the likelihood that notes are skipped, but double triggering is easier. |
| | Rim/Head Modifier | <p>Improve signal detection by increasing the signal strength difference between rim and head. The Rim Modifier strengthens the rim signal when the touch velocity is low. The Head Modifier lowers the head signal when the touch velocity is low.</p> <p>This setting only needs to be adjusted if pads of other models or manufacturers are used, but not if the original pads are used.</p> |

| Parameter | Function | |
|-----------|--------------|--|
| | Xtalk | <p>If several pads are mounted on a rack, vibrations can be transmitted to other pads when you hit a pad and unintentionally trigger sounds. This crosstalk can be avoided by the appropriate setting. The value should be set as low as possible.</p> <p>Press [ENTER] to store the setting. Trigger the selected pad with maximum power until 'OK' is shown. Choose another pad if necessary and repeat the process. Confirm the value with [ENTER].</p> |
| | Note Send | Setting the MIDI note value which is sent in MIDI operation |
| | Rim Velocity | Setting the volume of the rim trigger regardless of the actual strike intensity. The higher the value, the higher the volume when playing the rim trigger, and vice versa. |
| | Pedal Vel. | Setting the Hi-Hat volume. Select this option and press down the Hi-Hat pedal with maximum power. The harder you press down the pedal, the louder is the Hi-Hat. Confirm the value with [ENTER] . |
| | Split Point | Setting the rim trigger response value of the snare. If you play the Rim trigger of the snare softly you hear the Cross Stick sound. Above the response value you hear the Rim Shot sound. |
| | Chick Time | Setting the time period how long after triggering the pedal no other signal is accepted. This setting avoids unintentionally triggering caused by physical contact. |
| | Splash Time | Setting the level of difficulty for triggering the pedal splash. |

| Parameter | Function |
|-------------|---|
| Calib. | <p>This parameter defines the playing range of the hi-hat pedal. The set range is shown in the display in the lower right corner.</p> <p>Press <i>[ENTER]</i> to select the option. Press the pedal down to the floor and press <i>[ENTER]</i> to set the minimum. Release the pedal slowly and press <i>[ENTER]</i> to set the maximum. The value range is stored in the module and allows a more precise strike. It is recommended not to set extreme values to allow easy playing.</p> |
| | <p>The range between 'Hi-Hat open' and 'Hi-Hat closed' is called '<i>HalfOpen</i>'. For increasing the range '<i>HalfOpen</i>', increase the '<i>Open Point</i>' and decrease the '<i>Close Point</i>'.</p> |
| Open Point | <p>Setting the position where the Hi-Hat is open. The value is displayed in the entire Hi-Hat pedal range. The higher the value is, the closer it is to the position where the pedal is released. This means that the range for open Hi-Hat is very small.</p> |
| Close Point | <p>Setting the position where the Hi-Hat is closed. The value is displayed in the entire Hi-Hat pedal range. The lower the value is, the closer it is to the position where the pedal is pressed down to the floor. This means that the range for closed Hi-Hat is very small.</p> |
| Type | <p>Selection of the trigger type for input <i>[EXT2]</i>.</p> <p>'<i>Mesh</i>' for mesh head pad.</p> <p>'<i>Bar</i>' for bar trigger pad.</p> |

6.3 Connecting the device via Bluetooth®

You can connect the drum module to mobile devices that support Bluetooth® 4.0 or higher. Android and iOS are supported. The Bluetooth® function turns on automatically when the drum module is turned on.

Audio connection

Proceed as follows to play audio files on a mobile end device:

- 1.** ➤ Enable the Bluetooth® function of the mobile end device.
- 2.** ➤ Search for available devices.
- 3.** ➤ Select the module named 'HX-****'.
- 4.** ➤ Enter the password 1337 and confirm.
 - ⇒ After a successful connection, you can play audio data on the mobile device and hear it via the outputs of the drum module. The volume can now only be controlled with the mobile device.

6.4 Reset to factory defaults

Proceed as follows to reset the device to factory defaults:

1. ➤ Press the *[SETUP]* button and use *[PAGE UP]* or *[PAGE DOWN]* to highlight the menu item 'RESET'.
2. ➤ Use the *[-] / [+]* rotary control or the *[-] | [+]* buttons to highlight one of the following options:
 - 'Kits' (resets drum kits)
 - 'Settings' (resets system settings)
 - 'Xtalk' (sets the value 'Xtalk' to the minimum)
 - 'Songs' (deletes user songs)
 - 'All' (resets all settings and deletes all user songs)
3. ➤ Confirm your selection with *[ENTER]*.
4. ➤ Restart the drum module.

7 Technical specifications

| | | |
|--------------------------|--------------------------------|--------------------------|
| Input connections | Power supply | Socket for power adapter |
| | USB interface | USB MIDI |
| | Trigger | D-sub |
| | | 2 × 6.35 mm jack socket |
| | LINE IN | 1 × 3.5 mm jack socket |
| Output connections | Headphones | 1 × 3.5 mm jack socket |
| | LINE OUT (R/L mono) | 2 × 6.35 mm jack socket |
| Timbres | 697 | |
| Styles | 55 | |
| Polyphony | 189 | |
| Effects | Reverb, distortion, compressor | |
| Drum kits | 20 preset kits, 20 user kits | |
| Demo and practice tracks | 55 songs | |
| Equalizer | 4-band | |
| Bluetooth® | Frequency range | 2.402 GHz ... 2.480 GHz |

| | | |
|------------------------|---|----------------------------|
| | Max. transmission power | +4 dBm |
| | Standard | Version 5.0 |
| Power supply | External power adapter, 100 - 240 V ~ 50/60 Hz | |
| Operating voltage | 12 V $\overline{\text{---}}$ / 2,000 mA, centre positive, or via USB port | |
| Dimensions (W × H × D) | 295 mm × 60 mm × 200 mm | |
| Weight | 1.2 kg | |
| Ambient conditions | Temperature range | 0 °C...40 °C |
| | Relative humidity | 20%...80% (non-condensing) |

Further information

| | |
|--------------------------|-----|
| Rack included | Yes |
| Seat included | No |
| Bass drum pedal included | Yes |
| Headphones included | No |
| Mesh head pads | Yes |
| Pads in stereo | Yes |
| Number of direct outputs | 0 |

8 Plug and connection assignment

Introduction

This chapter will help you select the right cables and plugs to connect your valuable equipment in such a way that a perfect sound experience is ensured.

Please note these advices, because especially in 'Sound & Light' caution is indicated: Even if a plug fits into the socket, an incorrect connection may result in a destroyed power amp, a short circuit or 'just' in poor transmission quality!

1/4" TS phone plug (mono, unbalanced)



| | |
|---|-------------------|
| 1 | Signal |
| 2 | Ground, shielding |

1/4" TRS phone plug (stereo, unbalanced)



| | |
|---|----------------|
| 1 | Signal (left) |
| 2 | Signal (right) |
| 3 | Ground |

9 Cleaning

Device components

Clean the device components that are accessible from the outside regularly. The cleaning frequency depends on the operating environment: damp, smoky or particularly dirty environments can cause greater accumulation of dirt on the device components.

- Clean with a dry soft cloth.
- Stubborn dirt can be removed with a slightly dampened cloth.
- Never use solvents or alcohol for cleaning.

10 Protecting the environment

Disposal of the packaging material



For the transport and protective packaging, environmentally friendly materials have been chosen that can be supplied to normal recycling.

Ensure that plastic bags, packaging, etc. are properly disposed of.

Do not just dispose of these materials with your normal household waste, but make sure that they are collected for recycling. Please follow the notes and markings on the packaging.

Disposal of your old device



This product is subject to the European Waste Electrical and Electronic Equipment Directive (WEEE) in its currently valid version. Do not dispose with your normal household waste.

Dispose of this device through an approved waste disposal firm or through your local waste facility. When discarding the device, comply with the rules and regulations that apply in your country. If in doubt, consult your local waste disposal facility.

11 Appendix

11.1 Voice list

| Name | Name | Name |
|-------------|-----------|-----------|
| KICK | House 03 | Trance 04 |
| Rock | RnB 01 | Trance 05 |
| Jazz | RnB 02 | Trap 01 |
| Indie 01 | RnB 03 | Trap 02 |
| Indie 02 | RnB 04 | Trap 03 |
| Metal | Techno 01 | Trap 04 |
| Funk 01 | Techno 02 | Trap 05 |
| Funk 02 | Techno 03 | Pop 01 |
| 8Bit 01 | Techno 04 | Pop 02 |
| 8Bit 02 | Trance 01 | Pop 03 |
| House 01 | Trance 02 | Pop 04 |
| House 02 | Trance 03 | Jungle |

| Name | Name | Name |
|------------|------------|--------------|
| Latin | Sax | Rosa |
| Session | Six | KissV |
| Vintage | Hot | DG3 |
| Jungle 01 | Kiss | TR66RIM |
| Jungle 02 | DDDclean | Soli909RIM |
| Fiesta | MorMOOG | SNARE |
| Birch 01 | Morschlag2 | Rock |
| YAM18 | Morschlag3 | Rock R |
| JAZZ V | Morschlag1 | Rock X |
| METAL V | Morschlag5 | Jazz 01 |
| POP V | Ballerfiak | Jazz 01 R |
| ROCK2V | Rave309 | Jazz X |
| ROCK V | Y30 | Jazz 02 |
| ROCKBRIGHT | SOLI606 | Jazz 02 R |
| DGs8 | SOLI808 | Indie 01 |
| Pik | Y909 | Indie R 01 |

| Name | Name | Name |
|------------|------------|-----------|
| Indie X | House 03 | Trance 02 |
| Indie 02 | House 04 | Trance 03 |
| Indie R 02 | House 05 | Trance 04 |
| Metal | RnB 01 | Trap 01 |
| Metal R | RnB 02 | Trap 02 |
| Metal X | RnB 03 | Trap 03 |
| Funk 01 | RnB 04 | Trap 04 |
| Funk R 01 | RnB R 01 | Trap 05 |
| Funk X 01 | RnB R 02 | Trap 07 |
| Funk 02 | RnB X 01 | Trap 08 |
| Funk R 02 | RnB X 02 | Trap 09 |
| Funk X 02 | Techno 01 | Trap 10 |
| 8Bit 01 | Techno 02 | Trap 11 |
| 8Bit 02 | TechnoC 01 | Pop |
| House 01 | TechnoC 02 | Pop R |
| House 02 | Trance 01 | Pop X |

| Name | Name | Name |
|-------------|-------------|-----------|
| Brush | Fiesta X 01 | METALV |
| Brush R | Fiesta 02 | METALV RS |
| Brush X | FiestaR 02 | METALV SS |
| Latin | Fiesta R 03 | POPV |
| Latin R 01 | Jungle2 | POPV RS |
| Latin R 02 | Jungle2 R | POPV SS |
| Session | BALLAD1 | ROCKV2 |
| Session R | RSBALLAD1 | ROCKV2 RS |
| Session X | SSBALLAD1 | ROCKV2 SS |
| Vintage | BrushV | ROCKV3 |
| Vintage R | BrushVSWIRL | ROCKV3 RS |
| Vintage X | BrushV RS | ROCKV3 SS |
| Jungle | BrushV SS | ROCKBRI |
| Jungle R | JAZZV | ROCKBRIRS |
| Fiesta 01 | JAZZV RS | ROCKBRISS |
| Fiesta R 01 | JAZZV SS | Soli085 |

| Name | Name | Name |
|-----------|-------------|---------|
| FatschSd | SoliRH5 | Jazz2 R |
| MBare | RimY10RIM | Jazz3 |
| OrgCP | RimSoli808R | Jazz3 R |
| SoliNoisy | SNSN80er | Indie1 |
| 909 | TOM | Indie2 |
| Abpunch | Rock1 | Indie3 |
| DD31 | Rock1 R | Indie4 |
| Dy2 | Rock2 | Metal1 |
| L9 | Rock2 R | Metal2 |
| Morball2 | Rock3 | Metal3 |
| Morballcl | Rock3 R | Metal4 |
| X82 | Rock4 | Conga1 |
| Soli8084 | Rock4 R | Conga2 |
| Soli9095 | Jazz1 | Conga3 |
| SoliFR2L | Jazz1 R | Conga4 |
| Soli808 | Jazz2 | Conga5 |

| Name | Name | Name |
|-----------|------------|------------|
| Conga6 | House2 03 | Trance2 02 |
| Timbale1 | House3 03 | Trance2 03 |
| Timbale2 | House4 03 | Trance2 04 |
| 8Bit1 | RnB1 | Trap1 01 |
| 8Bit2 | RnB2 | Trap1 02 |
| 8Bit3 | RnB3 | Trap1 03 |
| 8Bit4 | RnB4 | Trap2 01 |
| House1 01 | Techno1 | Trap2 02 |
| House2 01 | Techno2 | Trap2 03 |
| House3 01 | Techno3 | Pop1 |
| House4 01 | Techno4 | Pop1 R |
| House1 02 | Trance1 01 | Pop2 |
| House2 02 | Trance1 02 | Pop2 R |
| House3 02 | Trance1 03 | Pop3 |
| House4 02 | Trance1 04 | Pop3 R |
| House1 03 | Trance2 01 | Pop4 |

| Name | Name | Name |
|------------|------------|------------|
| Pop4 R | Vintage2 R | Fiesta2 R |
| Brush1 | Vintage3 | Fiesta3 |
| Brush2 | Vintage3 R | Fiesta3 R |
| Brush3 | Vintage4 | Fiesta4 R |
| Brush4 | Vintage4 R | Brush8 |
| Latin1 | Jungle1 | Brush10 |
| Latin2 | Jungle1 R | Brush12 |
| Latin3 | Jungle2 | Brush14 |
| Latin4 | Jungle2 R | BrushRim8 |
| Session1 | Jungle3 | BrushRim10 |
| Session2 | Jungle3 R | BrushRim12 |
| Session3 | Jungle4 | BrushRim14 |
| Session4 | Jungle4 R | 10XNMas |
| Vintage1 | Fiesta1 | 12XNMas |
| Vintage1 R | Fiesta1 R | 14XNMas |
| Vintage2 | Fiesta2 | 16XNMas |

| Name | Name | Name |
|----------------|--------------|--------------|
| Rim10XNMas | Rim10MetaFil | Rim10SoliJP1 |
| Rim12XNMas | Rim12MetaFil | Rim12SoliJP1 |
| Rim14XNMas | Rim14MetaFi | Rim14SoliJP1 |
| Rim16XNMas | Rim16MetaFi | Rim16SoliJP1 |
| 10BigReverb | 10SoliNathan | yt808ana1 |
| 12BigReverb | 12SoliNathan | yt808ana2 |
| 14BigReverb | 14SoliNathan | yt808ana3 |
| 16BigReverb | 16SoliNathan | yt808ana4 |
| Rim10BigReverb | Rim10SoliNat | Li_HTO 1 |
| Rim12BigReverb | Rim12SoliNat | Li_HTO 2 |
| Rim14BigReverb | Rim14SoliNat | Li_HTO 3 |
| Rim16BigReverb | Rim16SoliNat | Li_HTO 4 |
| 10MetaFilter | 10SoliJP1 | 80_TOM1 |
| 12MetaFilter | 12SoliJP1 | 80_TOM2 |
| 14MetaFilter | 14SoliJP1 | 80_TOM3 |
| 16MetaFilter | 16SoliJP1 | 80_TOM4 |

| Name | Name | Name |
|-------------|-------------|-----------|
| 80er1 | TED_TOM1 | Indie B |
| 80er2 | TED_TOM2 | Indie E |
| 80er3 | TED_TOM3 | Funk 02 |
| 80er4 | TED_TOM4 | Funk B 02 |
| NOV_808TOM1 | X1_ETOM1 | Funk E 02 |
| NOV_808TOM2 | X1_ETOM2 | Funk 01 |
| NOV_808TOM3 | X1_ETOM3 | Funk B 01 |
| NOV_808TOM4 | X1_ETOM4 | Funk E 01 |
| SDS7_4TO1 | RIDE | House 01 |
| SDS7_4TO2 | Rock | House 02 |
| SDS7_4TO3 | Rock B | House 03 |
| SDS7_4TO4 | Rock E | RnB |
| 909_TOM1 | Jazz | Techno 01 |
| 909_TOM2 | Jazz B | Techno 02 |
| 909_TOM3 | Jazz E | Trance |
| 909_TOM4 | Indie | Pop |

| Name | Name | Name |
|------------|------------|---------------|
| Pop B | Pst20Wd | Pst2TNy B |
| Brush | Pst20Wd B | Pst2TNy E1 |
| Brush B | Pst20Wd E | Pst2TNy E2 |
| Brush E | Pst20Br | CRASH |
| Session | Pst20Br B | Rock1 |
| Vintage | Pst20Br E | Rock1 E |
| Vintage B | Pst21Ny1 | Rock2 |
| Jungle B | Pst21Ny2 | Rock2 E |
| Fiesta | Pst21 B1 | RockChina |
| Fiesta B | Pst21 B2 | RockSplash |
| Fiesta E | Pst21 E | Jazz1 |
| Pst20Ny1 | Pst21Br | Jazz1 E 01 |
| Pst20Ny2 | Pst21Br B | Jazz2 |
| Pst20Ny B | Pst21Br E | Jazz2 E |
| Pst20Ny E1 | Pst21EDGMe | JazzSplash 01 |
| Pst20Ny E2 | Pst2TNy | JazzSplash 02 |

| Name | Name | Name |
|---------------|----------|-------------|
| RockSplash | House 02 | Fiesta2 |
| Jazz1 | House 03 | SplashA12 |
| Jazz1 E 01 | House 04 | SplashA12 E |
| Jazz2 | Trance1 | SplashB12 |
| Jazz2 E | Trance2 | SplashB12 E |
| JazzSplash 01 | Trap1 01 | Splash8 |
| JazzSplash 02 | Trap2 01 | Splash8E |
| Indie1 01 | Pop1 | China12Mal |
| Indie2 01 | Pop2 | China14Mal |
| Indie1 02 | Session1 | China16Mal |
| Indie2 02 | Session2 | China20Sti |
| Funk1 02 | Vintage1 | China30 |
| Funk2 02 | Vintage2 | Crash14 E |
| 8Bit1 | Jungle1 | Crash14 |
| 8Bit2 | Jungle2 | Crash16 E |
| House 01 | Fiesta1 | Crash16 |

| Name | Name | Name |
|-------------|---------------|------------|
| Crash17 | Crash20Br | Jazz P 02 |
| Crash17br | Crash20EDGE | Indie O 02 |
| Crash17 E | 808_1CYMB | Indie C 02 |
| Crash17 | NOV_CYMB | Indie P 02 |
| Crash18 | Y808crash | Metal O |
| Crash18 E | HI-HAT | Metal C |
| CrashB16 E | Rock O | Metal P |
| CrashB16 E | Rock C | Funk O 01 |
| CrashB16 | Rock P | Funk C 01 |
| Crash18 | Rock Half-O | Funk P 01 |
| Crash18 B | Rock P Sp | Funk O 02 |
| Crash18Br | Jazz O 01 | Funk C 02 |
| Crash18 E1 | Jazz C 01 | Funk P 02 |
| Crash18 E2 | Jazz P 01 | 8Bit O |
| Crash20 | Jazz O 02 | 8Bit C |
| Crash20Beat | Jazz C 02 | House O 01 |

| Name | Name | Name |
|-------------|-------------|-------------------|
| House C 01 | Trance C 02 | Brush Sp |
| House O 02 | Trap O 01 | Session O |
| House C 02 | Trap C 01 | Session C |
| House O 03 | Trap O 02 | Session P |
| House C 03 | Trap C 02 | Session Sp |
| RnB O 01 | Trap O 03 | Vintage O |
| RnB C 01 | Trap C 03 | Vintage C |
| RnB O 02 | Pop O | Vintage P |
| RnB C 02 | Pop C | Vintage Half-Open |
| Techno O 01 | Pop P | Vintage Sp |
| Techno C 01 | Pop Half | Jungle O |
| Techno O 02 | Pop Sp | Jungle C |
| Techno C 02 | Brush O | Jungle P |
| Trance O 01 | Brush C | Jungle Half |
| Trance C 01 | Brush P | Jungle Sp |
| Trance O 02 | Brush Half | Fiesta O |

| Name | Name | Name |
|-------------|-----------|-------------------|
| Fiesta C | CDHH P | CR78_HHO |
| Fiesta P | CDHH Half | CR78_HHC |
| Fiesta Half | CDHH Sp | NOV_HHOP |
| Fiesta Sp | CCO O | NOV_1HHC |
| CCMHH O | CCO C | SakataHH O |
| CCMHH C | CCO P | SakataHH C |
| CCMHH P | CCO Half | SakataHH P |
| CCMHH Half | CCO Sp | Y808HH O |
| CCMHH Sp | 808_2HH O | Y808HH C |
| BalHH O | 808_3HH O | PERCUSSION |
| BalHH C | 808_HH C1 | Cowbell |
| BalHH P | 808_HH C2 | FunkPerc 01 |
| BalHH Half | 808HH P | FunkPerc 02 |
| BalHHSp | 909HHOP2 | 8BitFX01 |
| CDHH O | 909HHCL | 8BitFX02 |
| CDHH C | 909HHCL2 | 8BitFX03 |

| Name | Name | Name |
|------------|--------------|-------------|
| HouseFX01 | Dub FX01 | Abs5 |
| HouseFX02 | Dub FX02 | 808congaHi |
| HouseFX03 | Dub FX03 | 808 claves |
| HouseFX04 | Dub FX04 | 808 shaker |
| HouseFX05 | Dub FX05 | SakataAgogo |
| HouseFX06 | Agogo01 | Elec9Clap |
| TranceFX01 | Agogo02 | 626_TAM |
| TranceFX02 | ShakerShort | 707_TAMB |
| TranceFX03 | ShakerLong | ABcowbell |
| TranceFX04 | NoClp | C78_Guiro |
| TranceFX05 | SDS7_CLP | 808congalo |
| TrapFX01 | Soli909_CLAP | 808congame |
| TrapFX02 | 909Clp | Y30ZAP2 |
| El Shaker | 808Clp | X10_ZAP |
| El Co bell | Abs | |

11.2 Kit list

| No. | Name | | No. | Name |
|-----|--------|--|-----|------------|
| 01 | Studio | | 11 | Fiesta |
| 02 | radio | | 12 | Mario |
| 03 | Pop | | 13 | Impulse |
| 04 | Jazz | | 14 | Loop |
| 05 | Metal | | 15 | DirtySouth |
| 06 | Rock | | 16 | Nebula |
| 07 | 80s | | 17 | Drumstep |
| 08 | Latin | | 18 | Jungle |
| 09 | Brush | | 19 | Utopia |
| 10 | Sunray | | 20 | Bluebay |

11.3 Styles

| No. | Name | No. | Name | No. | Name |
|-----|--------------|-----|--------------|-----|-------------|
| 01 | WalkWithTree | 15 | ChaCha | 29 | NightTrain |
| 02 | Soul | 16 | Life | 30 | Arriba |
| 03 | Latin | 17 | Home | 31 | Batteries |
| 04 | Moskau | 18 | Latina | 32 | Revealite |
| 05 | Heart | 19 | Reality | 33 | Breathe |
| 06 | Fable | 20 | SoftAmour | 34 | BlueEyes |
| 07 | theStorm | 21 | MelodicDeath | 35 | HeyMan |
| 08 | Beowulf | 22 | SambaDance | 36 | Firerain |
| 09 | Forever | 23 | RockBlues | 37 | NyanCats |
| 10 | Acid | 24 | Fly | 38 | Supreme |
| 11 | Arcane | 25 | Bossa | 39 | Bartender |
| 12 | toBeLoved | 26 | Tango | 40 | Celebration |
| 13 | Rain | 27 | Dancing | 41 | Discover |
| 14 | PopAges | 28 | CryintheRain | 42 | Shade |

| No. | Name | No. | Name | No. | Name |
|-----|------------|-----|--------------|-----|----------|
| 43 | Echo | 48 | Blues | 52 | theLight |
| 44 | LiteGroove | 49 | Techno | 53 | Take |
| 45 | River | 50 | OutofMyHerat | 54 | Angel |
| 46 | Jazz | 51 | MellowTone | 55 | Bridge |
| 47 | Love | | | | |

