



Harley Benton

BLM-1
effects pedal

Musikhaus Thomann
Thomann GmbH
Hans-Thomann-Straße 1
96138 Burgebrach
Germany
Telephone: +49 (0) 9546 9223-0
E-mail: info@thomann.de
Internet: www.thomann.de

23.07.2015, ID: 114565

Table of contents

1	General notes.....	4
2	Safety instructions.....	6
3	Features.....	9
4	Instructions for use.....	10
5	Components and functions.....	11
6	Technical specifications.....	16
7	Protecting the environment.....	17

1 General notes

This user manual contains important information on safe operation of the device. Read and follow all safety notes and all instructions. Save this manual for future reference. Make sure that it is available to all persons using this device. If you sell the device to other users, be sure that they also receive this manual.

Our products are subject to a process of continuous development. We therefore reserve the right to make changes without notice.

Symbols and signal words

This section provides an overview of the symbols and signal words used in this user manual.

Signal word	Meaning
DANGER!	This combination of symbol and signal word indicates an immediate dangerous situation that will result in death or serious injury if it is not avoided.
NOTICE!	This combination of symbol and signal word indicates a possible dangerous situation that can result in material and environmental damage if it is not avoided.

Warning signs	Type of danger
	Warning – danger zone.

2 Safety instructions

Intended use

This device is intended to be used for sound processing of signals from musical instruments with electromagnetic pickups. Any other use or use under other operating conditions is considered to be improper and may result in personal injury or property damage. No liability will be assumed for damages resulting from improper use.

This device may be used only by persons with sufficient physical, sensorial, and intellectual abilities and having corresponding knowledge and experience. Other persons may use this device only if they are supervised or instructed by a person who is responsible for their safety.

Safety



DANGER!

Danger for children

Ensure that plastic bags, packaging, etc. are disposed of properly and are not within reach of babies and young children. Choking hazard!

Ensure that children do not detach any small parts (e.g. knobs or the like) from the unit. They could swallow the pieces and choke!

Never let children unattended use electrical devices.



NOTICE!

Operating conditions

This device has been designed for indoor use only. To prevent damage, never expose the device to any liquid or moisture. Avoid direct sunlight, heavy dirt, and strong vibrations.



NOTICE!

Risk of fire due to incorrect polarity

Incorrectly inserted batteries may destroy the device or the batteries.

Ensure that proper polarity is observed when inserting batteries.



NOTICE!

Possible damage by leaking batteries

Leaking batteries can cause permanent damage to the device.

Take batteries out of the device if it is not going to be used for a longer period.

3 Features

- Compressor/limiter floor effects pedal, designed for bass guitar
- Limits signal peaks and evens out signal level
- Numerous setting options
- Voltage supply by 9 V battery or power adaptor
- Robust metal housing

4 Instructions for use

Unpack and carefully check that there is no transportation damage before using the unit. Keep the equipment packaging. To fully protect the device against vibration, dust and moisture during transportation or storage use the original packaging or your own packaging material suitable for transport or storage, respectively.

Handle the device with care.

Do not try to disassemble or repair the device yourself in the unlikely event that it does not work.

Do not use solvents such as alcohol to clean the device.

5 Components and functions

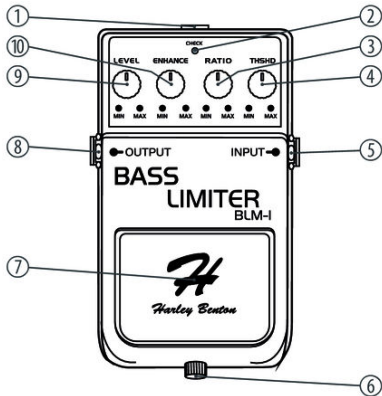

- | | |
|---|---|
| 1 | Connector for an optional 9 V power adaptor. If a 9 V power adaptor is used, the battery is automatically disconnected from the circuitry. |
| 2 | CHECK
The LED "CHECK" lights up when the effects pedal is active. If the LED is not lit or just glowing low during operation you have to replace the battery. |
| 3 | RATIO
Adjusts the compression ratio of the limiter. |
| 4 | THSHD
Adjusts the threshold for the limiter response. |
| 5 | INPUT
1/4" phone socket for a standard instrument cable. |
| 6 | Knurled-head screw to open the battery compartment. See details @ ↗ 'Changing the battery' on page 13. |

7	The foot switch toggles the effect on / off.
8	OUTPUT Output socket. Connect the output with a standard instrument cable to another effects pedal or an amp.
9	LEVEL Adjusts the output level of the device.
10	ENHANCE Adjusts the intensity of the Enhance effect.

Establish all connections as long as the unit is switched off. Use the shortest possible high-quality cables for all connections.

Power supply

You can either use a 9 V battery or the DC 9 V connection for an external power supply. Before connecting, check for correct polarity.

When you do not use the pedal unplug the instrument cable from the input jack. Otherwise, the battery will be discharged.

Changing the battery

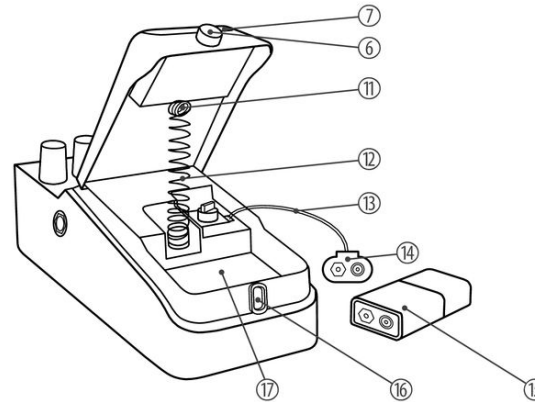

6	Knurled-head screw to open the battery compartment
---	--

7	Foot switch
---	-------------

11	Spring suspension
12	Coil spring
13	Battery cable
14	Battery clip for 9 V battery
15	9 V battery
16	Feed hole
17	Battery compartment

Before installing or replacing the battery disconnect the power adaptor from the wall outlet.

- 1.** ➤ Loosen the knurled-head screw (7) on the pedal to open it.
- 2.** ➤ Take the 9 V battery out of the battery compartment (17) and pull off the battery clip (14) from the empty battery.
- 3.** ➤ Put the battery clip (14) on the new battery (respecting the pole marking) and put it into the battery compartment (17). Make sure that the battery cable (13) is not trapped in the coil spring (12) or the pedal cover.
- 4.** ➤ Press the coil spring (12) into the spring suspension (11) and close the pedal switch (7).

5. ➤ Insert the knurled-head screw (6) through the feed hole (16) and tighten the screw securely.

6 Technical specifications

Input level	-20 dBu
Input impedance	1 M Ω
Output level	-20 dBu
Output impedance	1 k Ω
Recommended load impedance	≥ 10 k Ω
Intrinsic noise	-106 dBu (IHF-A, typ.)
Current draw	14 mA
Operating voltage supply	9 V battery (6F22) / 9 V power adaptor
Dimensions (W \times H \times D)	72 mm \times 128 mm \times 60 mm
Weight	390 g

7 Protecting the environment

Disposal of the packaging material



For the transport and protective packaging, environmentally friendly materials have been chosen that can be supplied to normal recycling.

Ensure that plastic bags, packaging, etc. are properly disposed of.

Do not just dispose of these materials with your normal household waste, but make sure that they are fed to a recovery. Please follow the notes and markings on the packaging.

Disposal of batteries



Batteries must not be disposed of as domestic waste or thrown into fire. Dispose of the batteries according to national or local regulations regarding hazardous waste. To protect the environment, dispose of empty batteries at your retail store or at appropriate collection sites.

Disposal of your old device



This product is subject to the European Waste Electrical and Electronic Equipment Directive (WEEE). Do not dispose with your normal household waste.

Dispose this device through an approved waste disposal firm or through your local waste facility. When discarding the device, comply with the rules and regulations that apply in your country. If in doubt, consult your local waste disposal facility.



