

Drums
Millenium

MPS-750X

E-Drum Module

Thomann GmbH
Hans-Thomann-Straße 1
96138 Burgebrach
Germany
Telephone: +49 (0) 9546 9223-0
Internet: www.thomann.de

20.02.2023, ID: 493327, 464015 (V5) Software V4.20

Table of contents

1	General information.....	6
1.1	Further information.....	7
1.2	Notational conventions.....	7
1.3	Symbols and signal words.....	8
2	Safety instructions.....	10
3	Features.....	12
4	Installation and starting up.....	13
5	Connections and controls.....	17
6	Operating.....	21
6.1	Functions.....	21
6.2	Device settings.....	27
6.3	Connecting the device via Bluetooth®.....	32
6.4	Reset to factory defaults.....	33
7	Technical specifications.....	34
8	Plug and connection assignment.....	36
9	Cleaning.....	38
10	Protecting the environment.....	39

11	Appendix.....	40
11.1	Voice list.....	40
11.2	Kit list.....	55
11.3	Styles.....	56



1 General information

This user manual contains important information on the safe operation of the device. Read and follow all safety notes and all instructions. Save this manual for future reference. Make sure that it is available to all persons using this device. If you sell the device to another user, be sure that they also receive this manual.

Our products and user manuals are subject to a process of continuous development. We therefore reserve the right to make changes without notice. Please refer to the latest version of the user manual which is ready for download under www.thomann.de.

1.1 Further information

On our website (www.thomann.de) you will find lots of further information and details on the following points:

Download	This manual is also available as PDF file for you to download.
Keyword search	Use the search function in the electronic version to find the topics of interest for you quickly.
Online guides	Our online guides provide detailed information on technical basics and terms.
Personal consultation	For personal consultation please contact our technical hotline.
Service	If you have any problems with the device the customer service will gladly assist you.

1.2 Notational conventions

This manual uses the following notational conventions:

Letterings

The letterings for connectors and controls are marked by square brackets and italics.

Examples: *[VOLUME]* control, *[Mono]* button.

Displays

Texts and values displayed on the device are marked by quotation marks and italics.

Examples: *'24ch'*, *'OFF'*.

Cross-references

References to other locations in this manual are identified by an arrow and the specified page number. In the electronic version of the manual, you can click the cross-reference to jump to the specified location.

Example: See ↗ *'Cross-references'* on page 8.

1.3 Symbols and signal words

In this section you will find an overview of the meaning of symbols and signal words that are used in this manual.

Signal word	Meaning
DANGER!	This combination of symbol and signal word indicates an immediate dangerous situation that will result in death or serious injury if it is not avoided.
CAUTION!	This combination of symbol and signal word indicates a possible dangerous situation that can result in minor injury if it is not avoided.
NOTICE!	This combination of symbol and signal word indicates a possible dangerous situation that can result in material and environmental damage if it is not avoided.
Warning signs	Type of danger
	Warning – danger zone.

2 Safety instructions

Intended use

Drum modules are intended to be used for converting digital trigger signals from drum pads to various percussion sounds. Use the unit only as described in this manual. Any other use or use under other operating conditions is considered to be improper and may result in personal injury or property damage. No liability will be assumed for damages resulting from improper use.

This device may be used only by persons with sufficient physical, sensorial, and intellectual abilities and having corresponding knowledge and experience. Other persons may use this device only if they are supervised or instructed by a person who is responsible for their safety.

Safety



DANGER!

Danger for children

Ensure that plastic bags, packaging, etc. are disposed of properly and are not within reach of babies and young children. Choking hazard! Ensure that children do not detach any small parts (e.g. knobs or the like) from the unit. They could swallow the pieces and choke! Never let children unattended use electrical devices.



CAUTION!

Possible hearing damage

With loudspeakers or headphones connected, the device can produce volume levels that may cause temporary or permanent hearing impairment. Do not operate the device permanently at a high volume level. Decrease the volume level immediately if you experience ringing in your ears or hearing impairment.

**NOTICE!****Operating conditions**

This device has been designed for indoor use only. To prevent damage, never expose the device to any liquid or moisture. Avoid direct sunlight, heavy dirt, and strong vibrations. Only operate the device within the ambient conditions specified in the chapter 'Technical specifications' of this user manual. Avoid heavy temperature fluctuations and do not switch the device on immediately after it was exposed to temperature fluctuations (for example after transport at low outside temperatures). Dust and dirt inside can damage the unit. When operated in harmful ambient conditions (dust, smoke, nicotine, fog, etc.), the unit should be maintained by qualified service personnel at regular intervals to prevent overheating and other malfunction.

**NOTICE!****External power supply**

The device is powered by an external power supply. Before connecting the external power supply, ensure that the input voltage (AC outlet) matches the voltage rating of the device and that the AC outlet is protected by a residual current circuit breaker. Failure to do so could result in damage to the device and possibly the user. Unplug the external power supply before electrical storms occur and when the device is unused for long periods of time to reduce the risk of electric shock or fire.

3 Features

- 697 sounds
- 55 styles
- 20 drum kits
- 20 user kits
- Metronome
- 4-band equalizer (DSP)
- Reverb effect, distortion (FX) and compressor
- Recording function
- Flexible pad assignment
- Bluetooth®
- Connections: Headphones, external trigger, USB, line out, line in
- Standby function

4 Installation and starting up

Rack setup, connecting pads and pedals

Rack setup and assembly of the pads and pedals are described in detail in the enclosed set assembly guide. Finally check that all cables between the pads and the drum module have been properly connected.

Connecting the pads

Connect the supplied D-sub plug of the pad connector cable to the D-sub input socket on the bottom side of the drum module.

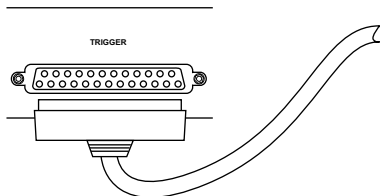

Connecting the power adapter

Connect the included power supply unit to the [DC 12 V] input on the rear panel of the drum module and then put the power plug into the power outlet.

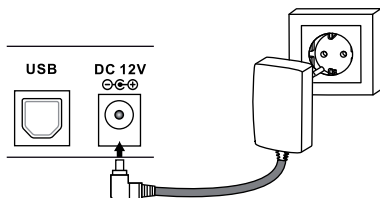

Connecting USB devices

Connect your computer to the USB port on the rear panel of the drum module.

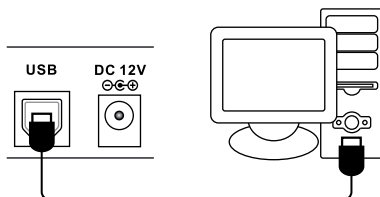

Connecting audio devices

Connect the inputs of your amplifier or active monitor to the output sockets *[LINE OUT]* on the rear panel of the drum module. Connect a CD or MP3 player etc. to the *[LINE IN]* input socket on the rear panel of the drum module.

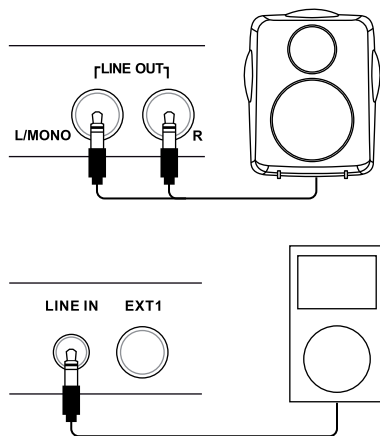

Connecting headphones

Connect your stereo headphones to the *[HEADPHONE]* output on the rear panel of the drum module.

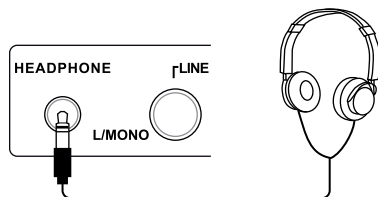

5 Connections and controls

Front panel

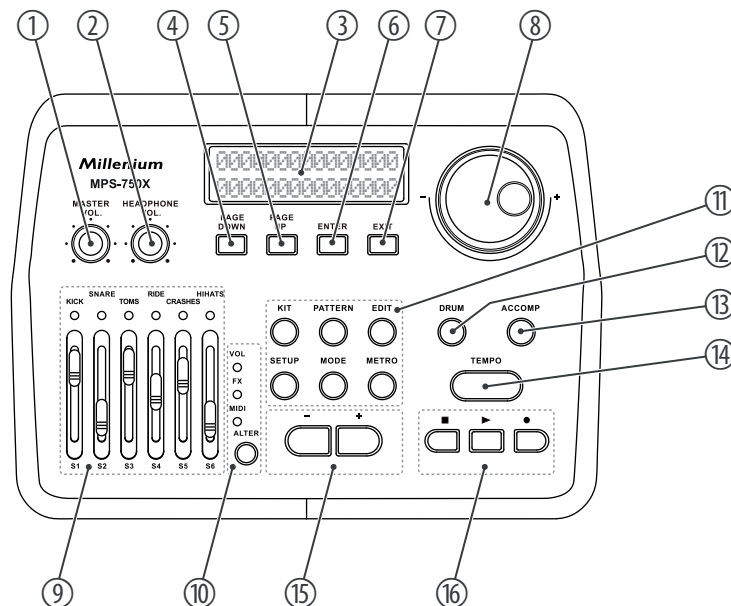

1	[MASTER VOL.] rotary control for adjusting the Line out volume
2	[HEADPHONE VOL.] rotary control for adjusting the headphones output volume
3	Backlit display
4	[PAGE DOWN] button to scroll forward through the open menu
5	[PAGE UP] button to scroll backward through the open menu
6	[ENTER] enter button to confirm a selection or change
7	[EXIT] return key to exit a menu or to discard changes
8	[-] / [+] rotary control increases or decreases the value of the currently selected parameter
9	Faders S1 ... S6 for the connected pads, function depends on selection [ALTER] (10)
10	[ALTER] selector switch for faders function S1 ... S6: Volume, FX or MIDI. The control LED of the enabled function lights up.
11	[KIT] button to enable 'Kit' mode
	[PATTERN] button to enable 'Pattern' mode
	[EDIT] button to open the programming menu
	[SETUP] button to open the device settings menu
	[MODE] button to switch between operating modes
	[METRO] button to turn the metronome on and off and opens the click menu
12	[DRUM] button to mute the Drum track of a style

- | | |
|----|---|
| 13 | [<i>ACCOMP</i>] button to mute the Accompaniment track of a style |
| 14 | [<i>TEMPO</i>] button to adjust the metronome tempo and thus the tempo for recording and playback |
| 15 | [<i>-</i>] [<i>+</i>] buttons to increase or decrease the displayed value and to select a kit |
| 16 | ■ button to end Style playback and to stop recording |
| | ▶ button to start Style playback |
| | ● button to start recording |

Rear panel

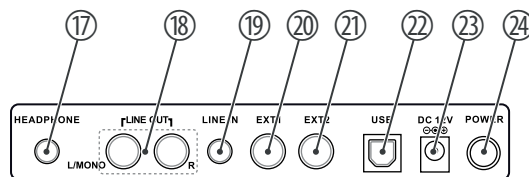

17	[HEADPHONE] headphones output
18	[LINE OUT] output socket to connect an amplifier or active monitor (mono left, stereo left/right)
19	[LINE IN] input socket for connecting audio devices as CD and MP3 players, etc.
20	[EXT1] input for connecting an external trigger, forth tom pad, by default
21	[EXT2] input for connecting an external trigger, second crash pad, by default
22	[USB] USB port for connecting a computer with USB-MIDI interface
23	[DC 12V] connection socket for the power adapter for power supply
24	[POWER] mains switch to turn the device on and off

6 Operating

6.1 Functions

Switching on



Check all cable connections for correct fit before switching on.

Before switching on, turn both volume controls of the drum module down to minimum.

Use the main switch *[POWER]* on the rear panel to switch the drum module on.

Standby function

The unit automatically switches to standby mode when you don't press any key or strike a connected pad for about 30 minutes. Then press the main switch *[POWER]* to turn the device back on again.

Selecting a drum kit

A drum kit is a compilation in which a certain sound and several sound parameters are assigned to each trigger. Selecting different drum kits lets you customise the sound of your e-drum set in seconds to the desired music genre.

1. ➤ Press *[KIT]*.

⇒ The first kit appears on the display.

2. ➤ Use the *[-]* / *[+]* buttons or the *[-]* / *[+]* rotary control to select the desired kit.

Customising a drum kit

The preprogrammed sounds of the drum module can be programmed to any of the connected pads. So you can create user kits and store them in the device. To do so proceed as follows:

1. ➤ First, call up one of the available drum kits (see previous chapter) and use *[EDIT]* to switch to Edit mode.
2. ➤ Hit the pad (Trigger) to which you want to programme a certain sound or press *[DRUM]* repeatedly until the desired pad is shown on the display. Additionally select the specific trigger for multiple assigned pads.
3. ➤ Use *[PAGE DOWN]* or *[PAGE UP]* to successively open the following selection menus and use the *[-]* / *[+]* rotary control or the *[-]* | *[+]* buttons to adjust the settings for the activated trigger.

Selection menu	Value range
VOICE TYPE	Kick, Snare, Tom, Ride, Crash, Hi-Hat, Metro, Extras
VOICE	Voice selection, see
VOLUME	Volume
REVERB	Reverb effect
PITCH	Pitch
PAN	Position within the stereo signal (panorama right / left)

4. ➤ Quit the selection menu with *[EXIT]*.
 - ⇒ Use *[-]* | *[+]* in the following saving dialogue to specify the memory location. Existing data will be overwritten.

5. ➤ Confirm with *[ENTER]* or cancel saving with *[EXIT]*.
6. ➤ Select if necessary the next trigger, to which you want to programme a sound. Use *[EXIT]* to exit the Edit mode.

Style playing

Your digital drum set has a total of 40 preprogrammed Styles, which can be played individually in the 'Pattern' mode.

1. ➤ Press the *[PATTERN]* button.
⇒ The display shows the first Style in '01 WalkWithTree' format.
2. ➤ Use the *[-] / [+]* rotary control or the *[-] | [+]* buttons to select the Style you want to play.
3. ➤ Start and stop playback with the ► and ■ buttons.

Metronome function

Press *[METRO]* to turn the Metronome on. Then you hear the Metronome sound. Proceed as follows to adjust the metronome settings:

1. ➤ Use *[PAGE DOWN]* or *[PAGE UP]* to successively open the following selection menus and use the *[-]* / *[+]* rotary control or the *[-]* | *[+]* buttons to adjust the settings as desired.

Selection menu	Value range
VOLUME	Volume
TEMPO	Speed
TIME SIGNATURE	Time signature
SOUND	Metronome sound

2. ➤ Quit the selection menu with *[EXIT]*.

The click tempo can additionally be adjusted as follows: Press *[TEMPO]* and adjust the tempo using the *[-]* / *[+]* rotary control.

or

Tap four times in succession and at the desired tempo the *[TEMPO]* button (tap tempo function). The new value is instantly applied.

Press *[METRO]* again to turn the Metronome off.

Recording function

The drum module offers the possibility to record up to 15 user drum tracks in the operating modes 'Kit' or 'Pattern'. To do so proceed as follows:

1. ➤ Activate one of the operating modes 'Kit' or 'Pattern'.
2. ➤ Press ● to activate the recording mode.
3. ➤ If desired, specify the metronome settings for the recording.
4. ➤ Press ● again to start the recording.
5. ➤ Press ■ to stop the recording and ● to restart.
To finally stop recording press ■ twice.
⇒ The display shows the message 'Save the song to'.
6. ➤ Use [-] | [+] to specify the memory location. Existing data will be overwritten.
7. ➤ Confirm with [ENTER] or cancel saving with [EXIT].



In 'Pattern' mode you can add a style.

Mixer function

The function of faders S1 ... S6 of the drum module depends on the selected operating mode. Use *[ALTER]* to toggle between VOL, FX and MIDI. The control LED of the activated operating mode lights up.

Operating mode	Fader function
VOL	Volume control for the assigned pad.
FX	Fader S1: Reverb control Fader S2: Compression control Fader S3 ... S6: 4-Band-EQ controls
MIDI	In MIDI operation, each fader S1 ... S6 is assigned to one controller, the function is specified in the settings of the installed DAW.



If you have set one of the faders to a certain value in one of the operating modes and then repeatedly change the operating mode you first have to slide the fader over the previously set value in the initial mode.

Example: If you set fader S1 in VOL mode to value '127', then change to FX mode and set the fader to '0', then change back to VOL mode, you first have to set the fader back to value '127' to get a response.

» *Continued on the next page*

This function prevents sudden volume jumps or changes of effect settings by moving the faders in the three modes.

6.2 Device settings

Various device settings can be customised in the Setup menu.

Press **[SETUP]** to enter the menu. Use **[PAGE DOWN]** or **[PAGE UP]** to select the desired option and use the **[-] / [+]** rotary control or the **[-] | [+]** buttons to adjust the settings as desired.

Quit the selection menu with **[EXIT]**.

Confirm the respective security prompt with **[ENTER]** to accept the new value, or cancel all changes with **[EXIT]**.

Parameter	Function
BACK VOLUME	Volume preset for all Styles and Loops.
MASTER TUNE	Pitch preset, on delivery set to standard A / 440 Hz.
LOCAL	Set the Parameter for normal operation to 'ON': the module plays the programmed sound files. Set the Parameter for MIDI operation to 'OFF' (low latency): the module transfers MIDI data.

Parameter	Function	
FX SET	Fader function preset. Make the following settings either directly with the fader or use the <i>[PAGE UP]</i> / <i>[PAGE DOWN]</i> buttons:	
	Reverb Type	Reverb preset (effect type), fader S1.
	Dist.Pst	Distortion preset (effect type).
	Threshold	Compressor threshold preset, fader S2.
	LowFrq	Preset for low frequency control range, fader S3.
	LoMiFrq	Preset for low mid frequency control range, fader S4.
	HiMiFrq	Preset for high mid frequency control range, fader S5.
	HiFrq	Preset for high frequency control range, fader S6.
MIDI SET	Assignment of faders S1 ... S6 to the MIDI controllers.	
FADER MODE	Setting the fader positions	
	Save	The fader positions are saved when switching off the device.
	Cancel	The fader positions are not saved when switching off the device.
	Lock	The fader positions are locked and cannot be set individually.
ADVANCED	Pad or trigger parameter preset:	

Parameter	Function	
	Sensitivity	The touch sensitivity regulates the volume behaviour of a pad regardless of the actual strike intensity. The higher the value, the higher the volume when playing, and vice versa.
	Headroom	This parameter is used to preset the level reserve between normal and maximum level when playing the pads.
	SenseTime	Presetting the minimum time interval between two signals from the same trigger prevents unwanted sound overlays by vibrations.
	Trigger	The trigger curve regulates the velocity, i.e. the ratio between the punch and volume. Use setting ' <i>Linear</i> ' for the most natural ratio between punch and volume. Use ' <i>Exp</i> ' if you want a hard strike to cause a bigger volume change (or dynamics). Use ' <i>Log</i> ' if you want a soft strike to cause a bigger change. With the setting ' <i>Spline</i> ' the volume changes less upon a change of the strike. High volumes are already reached at a relatively low strike intensity.
	Peak Decay	Setting the time period how long after signal input of the selected pad no other signal is accepted. The higher the value is, the lower the likelihood that notes are skipped, but double triggering is easier.
	Rim/Head Modifier	<p>Improve signal detection by increasing the signal strength difference between rim and head. The Rim Modifier strengthens the rim signal when the touch velocity is low. The Head Modifier lowers the head signal when the touch velocity is low.</p> <p>This setting only needs to be adjusted if pads of other models or manufacturers are used, but not if the original pads are used.</p>

Parameter	Function	
	Xtalk	<p>If several pads are mounted on a rack, vibrations can be transmitted to other pads when you hit a pad and unintentionally trigger sounds. This crosstalk can be avoided by the appropriate setting. The value should be set as low as possible.</p> <p>Press [ENTER] to store the setting. Trigger the selected pad with maximum power until 'OK' is shown. Choose another pad if necessary and repeat the process. Confirm the value with [ENTER].</p>
	Note Send	Setting the MIDI note value which is sent in MIDI operation
	Rim Velocity	Setting the volume of the rim trigger regardless of the actual strike intensity. The higher the value, the higher the volume when playing the rim trigger, and vice versa.
	Pedal Vel.	Setting the Hi-Hat volume. Select this option and press down the Hi-Hat pedal with maximum power. The harder you press down the pedal, the louder is the Hi-Hat. Confirm the value with [ENTER] .
	Split Point	Setting the rim trigger response value of the snare. If you play the Rim trigger of the snare softly you hear the Cross Stick sound. Above the response value you hear the Rim Shot sound.
	Chick Time	Setting the time period how long after triggering the pedal no other signal is accepted. This setting avoids unintentionally triggering caused by physical contact.
	Splash Time	Setting the level of difficulty for triggering the pedal splash.

Parameter	Function
Calib.	<p>This parameter defines the playing range of the hi-hat pedal. The set range is shown in the display in the lower right corner.</p> <p>Press <i>[ENTER]</i> to select the option. Press the pedal down to the floor and press <i>[ENTER]</i> to set the minimum. Release the pedal slowly and press <i>[ENTER]</i> to set the maximum. The value range is stored in the module and allows a more precise strike. It is recommended not to set extreme values to allow easy playing.</p>
	<p>The range between 'Hi-Hat open' and 'Hi-Hat closed' is called '<i>HalfOpen</i>'. For increasing the range '<i>HalfOpen</i>', increase the '<i>Open Point</i>' and decrease the '<i>Close Point</i>'.</p>
Open Point	<p>Setting the position where the Hi-Hat is open. The value is displayed in the entire Hi-Hat pedal range. The higher the value is, the closer it is to the position where the pedal is released. This means that the range for open Hi-Hat is very small.</p>
Close Point	<p>Setting the position where the Hi-Hat is closed. The value is displayed in the entire Hi-Hat pedal range. The lower the value is, the closer it is to the position where the pedal is pressed down to the floor. This means that the range for closed Hi-Hat is very small.</p>
Type	<p>Selection of the trigger type for input <i>[EXT2]</i>.</p> <p>'<i>Mesh</i>' for mesh head pad.</p> <p>'<i>Bar</i>' for bar trigger pad.</p>

6.3 Connecting the device via Bluetooth®

You can connect the drum module to mobile devices that support Bluetooth® 4.0 or higher. Android and iOS are supported. The Bluetooth® function turns on automatically when the drum module is turned on.

Audio connection

Proceed as follows to play audio files on a mobile end device:

1. ➤ Enable the Bluetooth® function of the mobile end device.
2. ➤ Search for available devices.
3. ➤ Select the module named 'HX-****'.
4. ➤ Enter the password 1337 and confirm.
 - ⇒ After a successful connection, you can play audio data on the mobile device and hear it via the outputs of the drum module. The volume can now only be controlled with the mobile device.

6.4 Reset to factory defaults

Proceed as follows to reset the device to factory defaults:

1. ➤ Press the *[SETUP]* button and use *[PAGE UP]* or *[PAGE DOWN]* to highlight the menu item 'RESET'.
2. ➤ Use the *[-] / [+]* rotary control or the *[-] | [+]* buttons to highlight one of the following options:
 - 'Kits' (resets drum kits)
 - 'Settings' (resets system settings)
 - 'Xtalk' (sets the value 'Xtalk' to the minimum)
 - 'Songs' (deletes user songs)
 - 'All' (resets all settings and deletes all user songs)
3. ➤ Confirm your selection with *[ENTER]*.
4. ➤ Restart the drum module.

7 Technical specifications

Input connections	Power supply	Socket for power adapter
	USB port	USB MIDI
	Trigger	2 × 1/4" jack socket
	LINE IN	1 × 3.5 mm jack socket
Output connections	Headphones	1 × 3.5 mm jack socket
	LINE OUT (R/L mono)	2 × 1/4" jack socket
Sounds	697	
Styles	55	
Polyphony	189	
Effects	Reverb, distortion, compressor	
Drum kits	20 preset kits, 20 user kits	
Equalizer	4-band	
Bluetooth®	Frequency range	2.402 GHz ... 2.480 GHz
	Max. transmission power	+4 dBm
	Standard	Version 5.0

Power supply	External power adapter, 100 - 240 V ~ 50/60 Hz	
Operating voltage	12 V $\overline{\text{---}}$ / 2000 A , centre positive, or via USB port	
Dimensions (W × H × D)	295 mm × 60 mm × 200 mm	
Weight	1.2 kg	
Ambient conditions	Temperature range	0 °C...40 °C
	Relative humidity	20 %...80 % (non-condensing)

Further information

Rack included	Yes
Seat included	No
Bass drum pedal included	Yes
Headphones included	No
Mesh Head Pads	Yes
Pads in Stereo	Yes
Number of direct outputs	0

8 Plug and connection assignment

Introduction

This chapter will help you select the right cables and plugs to connect your valuable equipment in such a way that a perfect sound experience is ensured.

Please note these advices, because especially in 'Sound & Light' caution is indicated: Even if a plug fits into the socket, an incorrect connection may result in a destroyed power amp, a short circuit or 'just' in poor transmission quality!

1/4" TS phone plug (mono, unbalanced)



1	Signal
2	Ground, shielding

1/4" TRS phone plug (stereo, unbalanced)



1	Signal (left)
2	Signal (right)
3	Ground

9 Cleaning

Device components

Clean the device components that are accessible from the outside regularly. The cleaning frequency depends on the operating environment: damp, smoky or particularly dirty environments can cause greater accumulation of dirt on the device components.

- Clean with a dry soft cloth.
- Stubborn dirt can be removed with a slightly dampened cloth.
- Never use solvents or alcohol for cleaning.

10 Protecting the environment

Disposal of the packaging material



For the transport and protective packaging, environmentally friendly materials have been chosen that can be supplied to normal recycling.

Ensure that plastic bags, packaging, etc. are properly disposed of.

Do not just dispose of these materials with your normal household waste, but make sure that they are collected for recycling. Please follow the notes and markings on the packaging.

Disposal of your old device



This product is subject to the European Waste Electrical and Electronic Equipment Directive (WEEE) in its currently valid version. Do not dispose with your normal household waste.

Dispose of this device through an approved waste disposal firm or through your local waste facility. When discarding the device, comply with the rules and regulations that apply in your country. If in doubt, consult your local waste disposal facility.

11 Appendix

11.1 Voice list

Name	Name	Name
KICK	House 03	Trance 04
Rock	RnB 01	Trance 05
Jazz	RnB 02	Trap 01
Indie 01	RnB 03	Trap 02
Indie 02	RnB 04	Trap 03
Metal	Techno 01	Trap 04
Funk 01	Techno 02	Trap 05
Funk 02	Techno 03	Pop 01
8Bit 01	Techno 04	Pop 02
8Bit 02	Trance 01	Pop 03
House 01	Trance 02	Pop 04
House 02	Trance 03	Jungle

Name	Name	Name
Latin	Sax	Rosa
Session	Six	KissV
Vintage	Hot	DG3
Jungle 01	Kiss	TR66RIM
Jungle 02	DDDclean	Soli909RIM
Fiesta	MorMOOG	SNARE
Birch 01	Morschlag2	Rock
YAM18	Morschlag3	Rock R
JAZZ V	Morschlag1	Rock X
METAL V	Morschlag5	Jazz 01
POP V	Ballerfiak	Jazz 01 R
ROCK2V	Rave309	Jazz X
ROCK V	Y30	Jazz 02
ROCKBRIGHT	SOLI606	Jazz 02 R
DGs8	SOLI808	Indie 01
Pik	Y909	Indie R 01

Name	Name	Name
Indie X	House 03	Trance 02
Indie 02	House 04	Trance 03
Indie R 02	House 05	Trance 04
Metal	RnB 01	Trap 01
Metal R	RnB 02	Trap 02
Metal X	RnB 03	Trap 03
Funk 01	RnB 04	Trap 04
Funk R 01	RnB R 01	Trap 05
Funk X 01	RnB R 02	Trap 07
Funk 02	RnB X 01	Trap 08
Funk R 02	RnB X 02	Trap 09
Funk X 02	Techno 01	Trap 10
8Bit 01	Techno 02	Trap 11
8Bit 02	TechnoC 01	Pop
House 01	TechnoC 02	Pop R
House 02	Trance 01	Pop X

Name	Name	Name
Brush	Fiesta X 01	METALV
Brush R	Fiesta 02	METALV RS
Brush X	FiestaR 02	METALV SS
Latin	Fiesta R 03	POPV
Latin R 01	Jungle2	POPV RS
Latin R 02	Jungle2 R	POPV SS
Session	BALLAD1	ROCKV2
Session R	RSBALLAD1	ROCKV2 RS
Session X	SSBALLAD1	ROCKV2 SS
Vintage	BrushV	ROCKV3
Vintage R	BrushVSWIRL	ROCKV3 RS
Vintage X	BrushV RS	ROCKV3 SS
Jungle	BrushV SS	ROCKBRI
Jungle R	JAZZV	ROCKBRIRS
Fiesta 01	JAZZV RS	ROCKBRISS
Fiesta R 01	JAZZV SS	Soli085

Name	Name	Name
FatschSd	SoliRH5	Jazz2 R
MBare	RimY10RIM	Jazz3
OrgCP	RimSoli808R	Jazz3 R
SoliNoisy	SNSN80er	Indie1
909	TOM	Indie2
Abpunch	Rock1	Indie3
DD31	Rock1 R	Indie4
Dy2	Rock2	Metal1
L9	Rock2 R	Metal2
Morball2	Rock3	Metal3
Morballcl	Rock3 R	Metal4
X82	Rock4	Conga1
Soli8084	Rock4 R	Conga2
Soli9095	Jazz1	Conga3
SoliFR2L	Jazz1 R	Conga4
Soli808	Jazz2	Conga5

Name	Name	Name
Conga6	House2 03	Trance2 02
Timbale1	House3 03	Trance2 03
Timbale2	House4 03	Trance2 04
8Bit1	RnB1	Trap1 01
8Bit2	RnB2	Trap1 02
8Bit3	RnB3	Trap1 03
8Bit4	RnB4	Trap2 01
House1 01	Techno1	Trap2 02
House2 01	Techno2	Trap2 03
House3 01	Techno3	Pop1
House4 01	Techno4	Pop1 R
House1 02	Trance1 01	Pop2
House2 02	Trance1 02	Pop2 R
House3 02	Trance1 03	Pop3
House4 02	Trance1 04	Pop3 R
House1 03	Trance2 01	Pop4

Name	Name	Name
Pop4 R	Vintage2 R	Fiesta2 R
Brush1	Vintage3	Fiesta3
Brush2	Vintage3 R	Fiesta3 R
Brush3	Vintage4	Fiesta4 R
Brush4	Vintage4 R	Brush8
Latin1	Jungle1	Brush10
Latin2	Jungle1 R	Brush12
Latin3	Jungle2	Brush14
Latin4	Jungle2 R	BrushRim8
Session1	Jungle3	BrushRim10
Session2	Jungle3 R	BrushRim12
Session3	Jungle4	BrushRim14
Session4	Jungle4 R	10XNMas
Vintage1	Fiesta1	12XNMas
Vintage1 R	Fiesta1 R	14XNMas
Vintage2	Fiesta2	16XNMas

Name	Name	Name
Rim10XNMas	Rim10MetaFil	Rim10SoliJP1
Rim12XNMas	Rim12MetaFil	Rim12SoliJP1
Rim14XNMas	Rim14MetaFi	Rim14SoliJP1
Rim16XNMas	Rim16MetaFi	Rim16SoliJP1
10BigReverb	10SoliNathan	yt808ana1
12BigReverb	12SoliNathan	yt808ana2
14BigReverb	14SoliNathan	yt808ana3
16BigReverb	16SoliNathan	yt808ana4
Rim10BigReverb	Rim10SoliNat	Li_HTO 1
Rim12BigReverb	Rim12SoliNat	Li_HTO 2
Rim14BigReverb	Rim14SoliNat	Li_HTO 3
Rim16BigReverb	Rim16SoliNat	Li_HTO 4
10MetaFilter	10SoliJP1	80_TOM1
12MetaFilter	12SoliJP1	80_TOM2
14MetaFilter	14SoliJP1	80_TOM3
16MetaFilter	16SoliJP1	80_TOM4

Name	Name	Name
80er1	TED_TOM1	Indie B
80er2	TED_TOM2	Indie E
80er3	TED_TOM3	Funk 02
80er4	TED_TOM4	Funk B 02
NOV_808TOM1	X1_ETOM1	Funk E 02
NOV_808TOM2	X1_ETOM2	Funk 01
NOV_808TOM3	X1_ETOM3	Funk B 01
NOV_808TOM4	X1_ETOM4	Funk E 01
SDS7_4TO1	RIDE	House 01
SDS7_4TO2	Rock	House 02
SDS7_4TO3	Rock B	House 03
SDS7_4TO4	Rock E	RnB
909_TOM1	Jazz	Techno 01
909_TOM2	Jazz B	Techno 02
909_TOM3	Jazz E	Trance
909_TOM4	Indie	Pop

Name	Name	Name
Pop B	Pst20Wd	Pst2TNy B
Brush	Pst20Wd B	Pst2TNy E1
Brush B	Pst20Wd E	Pst2TNy E2
Brush E	Pst20Br	CRASH
Session	Pst20Br B	Rock1
Vintage	Pst20Br E	Rock1 E
Vintage B	Pst21Ny1	Rock2
Jungle B	Pst21Ny2	Rock2 E
Fiesta	Pst21 B1	RockChina
Fiesta B	Pst21 B2	RockSplash
Fiesta E	Pst21 E	Jazz1
Pst20Ny1	Pst21Br	Jazz1 E 01
Pst20Ny2	Pst21Br B	Jazz2
Pst20Ny B	Pst21Br E	Jazz2 E
Pst20Ny E1	Pst21EDGMe	JazzSplash 01
Pst20Ny E2	Pst2TNy	JazzSplash 02

Name	Name	Name
RockSplash	House 02	Fiesta2
Jazz1	House 03	SplashA12
Jazz1 E 01	House 04	SplashA12 E
Jazz2	Trance1	SplashB12
Jazz2 E	Trance2	SplashB12 E
JazzSplash 01	Trap1 01	Splash8
JazzSplash 02	Trap2 01	Splash8E
Indie1 01	Pop1	China12Mal
Indie2 01	Pop2	China14Mal
Indie1 02	Session1	China16Mal
Indie2 02	Session2	China20Sti
Funk1 02	Vintage1	China30
Funk2 02	Vintage2	Crash14 E
8Bit1	Jungle1	Crash14
8Bit2	Jungle2	Crash16 E
House 01	Fiesta1	Crash16

Name	Name	Name
Crash17	Crash20Br	Jazz P 02
Crash17br	Crash20EDGE	Indie O 02
Crash17 E	808_1CYMB	Indie C 02
Crash17	NOV_CYMB	Indie P 02
Crash18	Y808crash	Metal O
Crash18 E	HI-HAT	Metal C
CrashB16 E	Rock O	Metal P
CrashB16 E	Rock C	Funk O 01
CrashB16	Rock P	Funk C 01
Crash18	Rock Half-O	Funk P 01
Crash18 B	Rock P Sp	Funk O 02
Crash18Br	Jazz O 01	Funk C 02
Crash18 E1	Jazz C 01	Funk P 02
Crash18 E2	Jazz P 01	8Bit O
Crash20	Jazz O 02	8Bit C
Crash20Beat	Jazz C 02	House O 01

Name	Name	Name
House C 01	Trance C 02	Brush Sp
House O 02	Trap O 01	Session O
House C 02	Trap C 01	Session C
House O 03	Trap O 02	Session P
House C 03	Trap C 02	Session Sp
RnB O 01	Trap O 03	Vintage O
RnB C 01	Trap C 03	Vintage C
RnB O 02	Pop O	Vintage P
RnB C 02	Pop C	Vintage Half-Open
Techno O 01	Pop P	Vintage Sp
Techno C 01	Pop Half	Jungle O
Techno O 02	Pop Sp	Jungle C
Techno C 02	Brush O	Jungle P
Trance O 01	Brush C	Jungle Half
Trance C 01	Brush P	Jungle Sp
Trance O 02	Brush Half	Fiesta O

Name	Name	Name
Fiesta C	CDHH P	CR78_HHO
Fiesta P	CDHH Half	CR78_HHC
Fiesta Half	CDHH Sp	NOV_HHOP
Fiesta Sp	CCO O	NOV_1HHC
CCMHH O	CCO C	SakataHH O
CCMHH C	CCO P	SakataHH C
CCMHH P	CCO Half	SakataHH P
CCMHH Half	CCO Sp	Y808HH O
CCMHH Sp	808_2HH O	Y808HH C
BalHH O	808_3HH O	PERCUSSION
BalHH C	808_HH C1	Cowbell
BalHH P	808_HH C2	FunkPerc 01
BalHH Half	808HH P	FunkPerc 02
BalHHSp	909HHOP2	8BitFX01
CDHH O	909HHCL	8BitFX02
CDHH C	909HHCL2	8BitFX03

Name	Name	Name
HouseFX01	Dub FX01	Abs5
HouseFX02	Dub FX02	808congaHi
HouseFX03	Dub FX03	808 claves
HouseFX04	Dub FX04	808 shaker
HouseFX05	Dub FX05	SakataAgogo
HouseFX06	Agogo01	Elec9Clap
TranceFX01	Agogo02	626_TAM
TranceFX02	ShakerShort	707_TAMB
TranceFX03	ShakerLong	ABcowbell
TranceFX04	NoClp	C78_Guiro
TranceFX05	SDS7_CLP	808congalo
TrapFX01	Soli909_CLAP	808congame
TrapFX02	909Clp	Y30ZAP2
El Shaker	808Clp	X10_ZAP
El Co bell	Abs	

11.2 Kit list

No.	Name		No.	Name
01	Studio		11	Fiesta
02	radio		12	Mario
03	Pop		13	Impulse
04	Jazz		14	Loop
05	Metal		15	DirtySouth
06	Rock		16	Nebula
07	80s		17	Drumstep
08	Latin		18	Jungle
09	Brush		19	Utopia
10	Sunray		20	Bluebay

11.3 Styles

No.	Name	No.	Name	No.	Name
01	WalkWithTree	15	ChaCha	29	NightTrain
02	Soul	16	Life	30	Arriba
03	Latin	17	Home	31	Batteries
04	Moskau	18	Latina	32	Revealite
05	Heart	19	Reality	33	Breathe
06	Fable	20	SoftAmour	34	BlueEyes
07	theStorm	21	MelodicDeath	35	HeyMan
08	Beowulf	22	SambaDance	36	Firerain
09	Forever	23	RockBlues	37	NyanCats
10	Acid	24	Fly	38	Supreme
11	Arcane	25	Bossa	39	Bartender
12	toBeLoved	26	Tango	40	Celebration
13	Rain	27	Dancing	41	Discover
14	PopAges	28	CryintheRain	42	Shade

No.	Name	No.	Name	No.	Name
43	Echo	48	Blues	52	theLight
44	LiteGroove	49	Techno	53	Take
45	River	50	OutofMyHerat	54	Angel
46	Jazz	51	MellowTone	55	Bridge
47	Love				

