

# the t.bone

## free2b | wireless transmission system

### User manual

This manual contains important information on the safe operation of the device. Read and follow the safety advice and instructions given. Retain the manual for future reference. If you pass the device on to others please include this manual.

### Safety instructions

#### Intended use

This device is meant to be used for wireless transmission of audio signals with microphone level. Any other use or use under other operating conditions is considered to be improper and may result in personal injury or property damage. No liability will be assumed for damages resulting from improper use.

#### Danger for children



Ensure that plastic bags, packaging, etc. are disposed of properly and are not within reach of babies and young children. Choking hazard! Ensure that children do not detach any small parts (e.g. knobs or the like) from the unit. They could swallow the pieces and choke! Never let unattended children use electrical devices.

#### Interference with other electrical equipment

Using the device near radios or TV sets may cause interference. Then increase the distance between the devices.

#### Where to use the product

Never use the product

- in direct sunlight
- in conditions of extreme temperature or humidity
- in extremely dusty or dirty areas
- at locations where the unit can become wet
- near magnetic fields

#### General handling

- To prevent damage, never use force when operating the switches and controls.
- Never immerse the appliance in water. Just wipe it with a clean dry cloth. Do not use liquid cleaners such as benzene, thinners or flammable cleaning agents.

#### Keep foreign substances from the unit!

Keep the device away from containers with liquids. Should any liquid get into the unit, this could lead to its destruction or fire. Be sure not to let any metal objects into the unit.

### Features

- Attachment system for dynamic microphones
- Ready-to-use set of transmitter and receiver
- 2.4 GHz band suitable for worldwide license-free operation
- 32 bit / 48 kHz high-definition audio quality

- Built-in lithium-ion rechargeable battery
- Charging via supplied micro USB cable
- LED indicators for charge status and channel selection
- Adapter from XLR to 3.5 mm mini jack included

### Operating elements

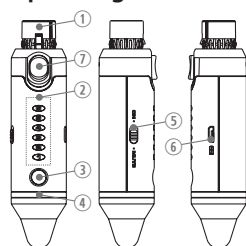

#### Transmitter

1. XLR connector socket
2. Channel indicator
3. Channel selection button
4. RF status LED ring
5. On / mute switch
6. Micro-USB port
7. XLR socket lock

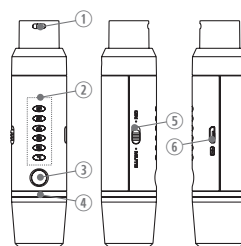

#### Receiver

1. XLR connector plug
2. Channel indicator
3. Channel selection button
4. RF status LED ring
5. On / mute switch
6. Micro-USB port

### Using the device

#### Switching on / off

1. To turn on the devices, press their On / Mute switches ⑤. Channel indicators ② will now work as a charge indicator for one second:

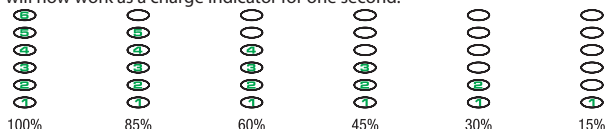

If the charge state drops below approx. 10 %, the RF status LED ring ④ flashes red twice and the device shuts off automatically.

2. To charge the built-in battery, connect the micro-USB jack ⑥. Use the supplied USB cable with a powered-on computer or other USB charging source. During charging, the RF status LED ring ④ lights red. When charging has finished, the RF status LED ring ④ lights up blue. If the devices are not in use for a long time, fully charge the batteries every three months.

#### Connecting and coupling devices

1. Plug the XLR socket of the transmitter into the XLR connector of the microphone. Plug the XLR plug of the receiver into the XLR input of a mixer or similar device for further signal processing (see the figure on the right).
2. After powering up, both transmitter and receiver operate on channel 1. When using multiple systems, each device pair must operate on its own channel. If necessary, press the channel selection button ③ several times on each device pair to set both devices to the same channel. Wait until the RF status LED ring ④ of the transmitter lights up blue. Now the coupling is complete. To avoid interference, keep the devices at least 3 meters away from other transmission equipment such as WiFi routers, etc.

#### Auto Standby

1. If the transmitter is not connected to a microphone 30 seconds after power is turned on, or if the input signal remains off for 30 seconds, the transmitter and the paired receiver automatically switch to standby mode to conserve battery power. When the signal returns, both devices switch on again immediately.
2. If the transmitter is not connected to a microphone for 1 hour after power is turned on, or if the input signal remains off for 1 hour, both devices will switch off completely. To turn them back on, press the On / Mute switches ⑤ of both units.

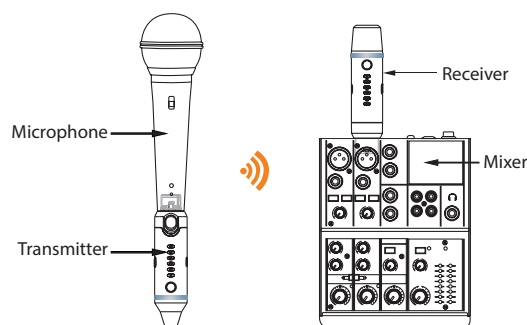
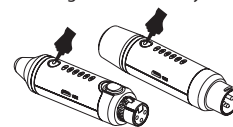

### Technical specifications

Number of transmission channels:	6
Range:	max. 30 m
Latency:	< 4 ms

Lithium Ion battery:	3.7 V, 700 mAh
Battery life:	approx. 5 hours
Dimensions (L x W x H):	approx. 108 x 26 x 26 mm
Weight:	130 g



For the transport and protective packaging, environmentally friendly materials have been chosen that can be supplied to normal recycling. Ensure that plastic bags, packaging, etc. are properly disposed of. Do not just dispose of these materials with your normal household waste, but make sure that they are collected for recycling. Please follow the notes and markings on the packaging.

Remove lithium batteries before disposing of the device. Protect used lithium batteries against potential short circuits, e.g. by covering the poles with adhesive tape. Lithium batteries must not be thrown away with the normal household waste or

burned, but must be disposed of in accordance with local regulations on the disposal of hazardous waste. Use the existing collection points.



This product is subject to the European Waste Electrical and Electronic Equipment Directive (WEEE) in its currently valid version. Do not dispose of your old device with your normal household waste. Dispose of this product through an approved waste disposal firm or through your local waste facility. Comply with the rules and regulations that apply in your country. If in doubt, consult your local waste disposal facility.