

**SPECIFICATIONS**

**Ellipsoidal Lighting Fixture**

- Physical**
- Die cast aluminum construction
  - Smooth running teflon guides
  - Fits all standard Source Four shutter barrels
  - Uses 6.25" color frame
  - Compatible with UL, cUL and CE fixtures
- Optical**
- Projector-quality, dual aspheric lenses
  - Minimum distortion of projected image
  - Provides up to 22% increased lumen output and efficiency
  - Provides crisp image edge definition and high contrast
  - Superior optical glass with advanced AR coatings
  - Lens(es) secured with anti-vibration shock mounts
  - Available in 19°, 26°, 36°, and 50° field angles

**ORDERING INFORMATION**

**Source Four EDLT**

Model#	Description
419EDLT	19° Enhanced Definition Lens Tube
426EDLT	26° Enhanced Definition Lens Tube
436EDLT	36° Enhanced Definition Lens Tube
450EDLT	50° Enhanced Definition Lens Tube

**Note:** EDLT is supplied with color frame.

For a complete fixture, order the Source Four fixture body (7060A1023) in addition to the desired lens tube.

**Source Four EDLT Weight**

Model	EDLT Weight		Shipping Weight	
	kgs	lbs	kgs	lbs
EDLT	2.1	4.5	2.8	6

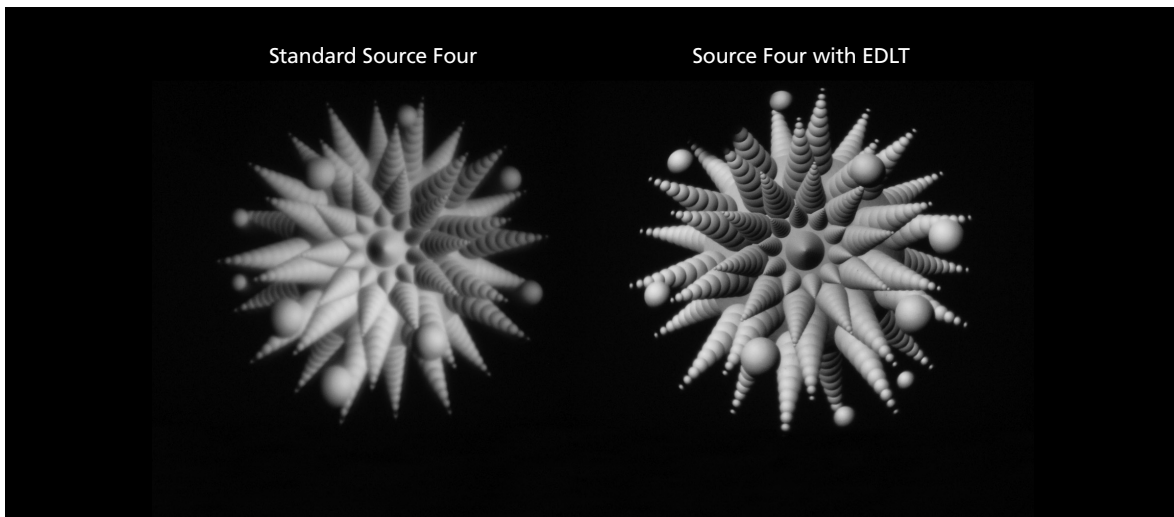

**PHOTOMETRIC DATA HPL 750W/115V/300HR**

**19° EDLT**

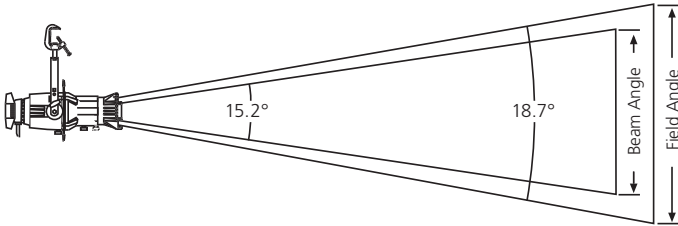

**Source Four 19° EDLT (cosine)**

Degree	Candela	Field Lumens	Beam Lumens	Field Efficiency	Efficacy
19°	260,363	13,012	10,173	59.4%	17.3 LPW

<b>Throw Distance (d)</b>	24' 7.3m	40' 12.2m	55' 16.8m	72' 22.0m
<b>Field Diameter</b>	8' 2.4m	13' 4.0m	18' 5.5m	24' 7.3m
<b>Illuminance (fc)</b>	452	163	86	50
<b>Illuminance (lux)</b>	4,865	1,752	926	341

For Field Diameter at any distance, multiply distance by .33  
 For Beam Diameter at any distance, multiply distance by .27

**26° EDLT**

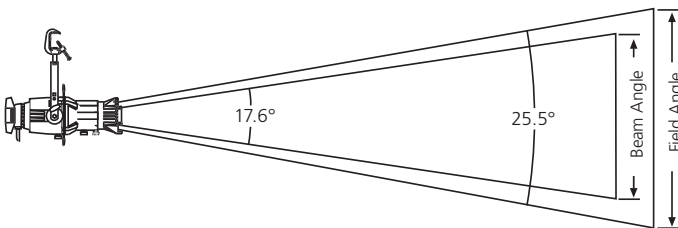

**Source Four 26° EDLT (cosine)**

Degree	Candela	Field Lumens	Beam Lumens	Field Efficiency	Efficacy
26°	182,301	15,412	9,929	70.4%	20.5 LPW

<b>Throw Distance (d)</b>	18' 5.5m	30' 9.1m	45' 13.7m	60' 18.3m
<b>Field Diameter</b>	8' 2.4m	14' 4.3m	20' 6.1m	27' 8.2m
<b>Illuminance (fc)</b>	563	203	90	51
<b>Illuminance (lux)</b>	6,056	2,180	969	545

For Field Diameter at any distance, multiply distance by .45  
 For Beam Diameter at any distance, multiply distance by .31

To determine illuminance in footcandles (fc) or lux at any throw distance, divide Candela by distance squared.

**Metric Conversions:**  
 For Meters multiply feet by .3048  
 For Lux multiply footcandles by 10.76

Ellipsoidal Series  
Accessories

36° EDLT

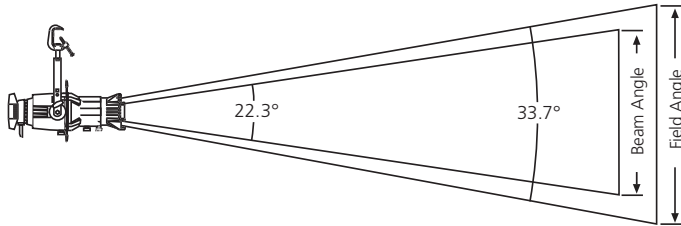

Source Four 36° EDLT (cosine)

Degree	Candela	Field Lumens	Beam Lumens	Field Efficiency	Efficacy
36°	98,553	14,271	8,941	65.2%	19.0 LPW

<b>Throw Distance (d)</b>	13' 4.0m	25' 7.6m	35' 10.7m	45' 13.7m
<b>Field Diameter</b>	8' 2.4m	15' 4.6m	21' 6.4m	27' 8.2m
<b>Illuminance (fc)</b>	566	158	80	49
<b>Illuminance (lux)</b>	6,088	1,697	866	524

For Field Diameter at any distance, multiply distance by .61  
For Beam Diameter at any distance, multiply distance by .39

50° EDLT

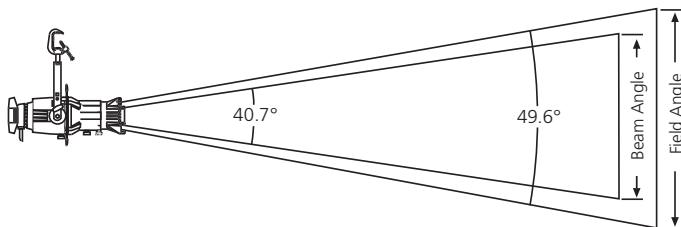

Source Four 50° EDLT (cosine)

Degree	Candela	Field Lumens	Beam Lumens	Field Efficiency	Efficacy
50°	41,471	14,437	9,542	65.9%	19.2 LPW

<b>Throw Distance (d)</b>	8.7' 2.7m	15' 4.6m	20' 6.1m	29' 8.8m
<b>Field Diameter</b>	8' 2.4m	14' 4.3m	18' 5.5m	27' 8.2m
<b>Illuminance (fc)</b>	548	184	104	49
<b>Illuminance (lux)</b>	5,898	1,984	1,116	531

For Field Diameter at any distance, multiply distance by .92  
For Beam Diameter at any distance, multiply distance by .74

## Ellipsoidal Series Accessories

To determine Candela (Cd) or Lumens (Lm) for Source Four EDLT with an HPL lamp, multiply the Candela or Lumen value by the multiplying factor (MF) shown for that lamp in the table below.

### Lamps

ETC Part #	Lamp Code	Watts	Volts	Initial Lumens	Color Temp.	Average Rated Life	19° MF		26° MF		36° MF		50° MF	
							Cd	Lm	Cd	Lm	Cd	Lm	Cd	Lm
RT116	HPL 750/115	750	115	21,900	3,250°	300	1.00	1.00	1.00	1.00	1.00	1.00	1.00	1.00
RT196	HPL 750/120X	750	120	16,400	3,065°	1,500	0.64	0.74	0.64	0.74	0.64	0.74	0.64	0.74
RT113	HPL 575/115	575	115	16,520	3,250°	300	0.85	0.82	0.78	0.82	0.67	0.75	0.79	0.76
RT114	HPL 575/115X	575	115	12,360	3,050°	2,000	0.56	0.56	0.56	0.56	0.56	0.56	0.56	0.56
RT115	HPL 575/120	575	120	16,520	3,250°	300	0.85	0.82	0.78	0.82	0.67	0.75	0.79	0.76
RT171	HPL 575/120X	575	120	12,360	3,050°	2,000	0.56	0.56	0.56	0.56	0.56	0.56	0.56	0.56
RT142	HPL 375/115	375	115	10,540	3,200°	300	0.71	0.53	0.66	0.52	0.56	0.48	0.66	0.46
RT143	HPL 375/115X	375	115	8,000	3,000°	1,000	0.49	0.40	0.45	0.40	0.39	0.36	0.46	0.36
RT112	HPL 550/77	550	77	16,170	3,250°	300	0.87	0.81	0.77	0.77	0.68	0.73	0.81	0.75
RT117	HPL 550/77X	550	77	12,160	3,050°	2,000	0.59	0.56	0.59	0.56	0.59	0.56	0.59	0.56
RT160	HPL 750/230	750	230	19,750	3,200°	300	0.64	0.70	0.64	0.75	0.74	0.86	0.74	0.75
N/A	HPL 750/240	750	240	19,750	3,200°	300	0.64	0.70	0.64	0.75	0.74	0.85	0.74	0.75
RT129	HPL 575/230	575	230	14,900	3,200°	400	0.55	0.53	0.53	0.61	0.63	0.65	0.61	0.60
RT130	HPL 575/240	575	240	14,900	3,200°	400	0.52	0.53	0.50	0.61	0.60	0.65	0.58	0.60
RT138	HPL 575/230X	575	230	11,780	3,050°	1,500	0.38	0.42	0.38	0.45	0.44	0.51	0.45	0.45
RT139	HPL 575/240X	575	240	11,780	3,050°	1,500	0.36	0.42	0.36	0.45	0.41	0.51	0.42	0.45
RT154	HPL 375/230X	375	230	7,800	3,050°	1,000	0.30	0.28	0.29	0.32	0.35	0.34	0.34	0.31
RT155	HPL 375/240X	375	240	7,800	3,050°	1,000	0.30	0.28	0.31	0.32	0.35	0.34	0.34	0.31

Source Four is rated for 750W maximum. For links to photometry file downloads (IES LM-63-02 format) go to [www.etcconnect.com](http://www.etcconnect.com).

All photometric data was prepared using a production fixture and the Prometric CCD measurement system. Fixture adjusted for cosine distribution and tested with calibrated lamp at rated voltage. All data normalized to nominal lamp lumens in accordance with IES LM-73-04. Testing performed at ETC West, Hollywood, CA.

### PHYSICAL

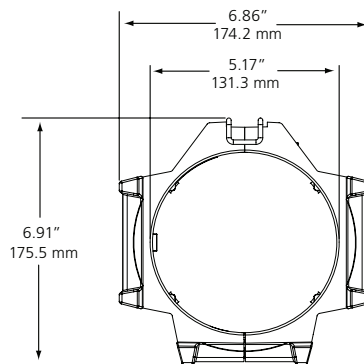
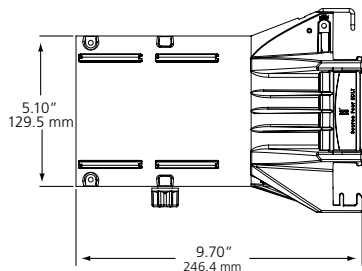

**Corporate Headquarters** ■ 3031 Pleasant View Rd, PO Box 620979, Middleton WI 53562 0979 USA ■ Tel +1 608 831 4116 ■ Fax +1 608 836 1736

**London, UK** ■ Unit 26-28, Victoria Industrial Estate, Victoria Road, London W3 6UU, UK ■ Tel +44 (0)20 8896 1000 ■ Fax +44 (0)20 8896 2000

**Rome, IT** ■ Via Ennio Quirino Visconti, 11, 00193 Rome, Italy ■ Tel +39 (06) 32 111 683 ■ Fax +39 (06) 32 656 990

**Holzkirchen, DE** ■ Ohmstrasse 3, 83607 Holzkirchen, Germany ■ Tel +49 (80 24) 47 00-0 ■ Fax +49 (80 24) 47 00-3 00

**Hong Kong** ■ Room 605-606, Tower III Enterprise Square, 9 Sheung Yuet Road, Kowloon Bay, Kowloon, Hong Kong ■ Tel +852 2799 1220 ■ Fax +852 2799 9325

**Web** ■ [www.etcconnect.com](http://www.etcconnect.com) ■ Copyright © 2006 ETC. All Rights Reserved. All product information and specifications subject to change. 7060L1042 Rev. A Printed in USA 07/06

Source Four® products protected by U.S. Patent Numbers 5,268,613, 5,345,371, 5,544,029, 5,446,637 and 5,775,799; Japanese Patent Number 2,501,772; US and International Patents Pending.