



ARENA

THEATRE FRESNEL

A 2.0kW / 2.5kW luminaire using a 200mm diameter lens.

The adjustable cone of light has a soft edge, easily blended with adjacent beams to provide even illumination.

The Arena Theatre Fresnel offers superior light output, strength and performance at a moderate cost.

FEATURES

- Wide range of beam angle from 7°-60°.
- Flat even beam with very little spill.
- Adjustable yoke balance point.
- 'Swing-down' door for easy access to lamp or cleaning. Isolates the mains supply when opened.
- Choice of GY16 lamp socket for CP72/43 2.0kW lamp or G22 lamp socket for CP91, 2.5kW.
- Smooth focus movement from 'Posi-slide' focus system, no metal to metal contact.
- Effective airflow maintains lower body temperature.
- Constructed of pressure die-castings and aluminium extrusion.
- Fully tested and compliant to CE standards.

PHYSICAL DATA

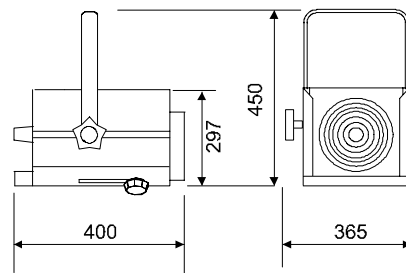

Weights:

Model	Unit including c/frame	Unit including c/frame packed
2kW	10.04kg	12.17kg
2.5kW	10.30kg	12.42kg

Carton Size:

310 x 375 x 520

Carton Size Cubic:

0.06

Colour Frame Size:

245mm x 245mm

Included:

1 x colour frame, 1 x M12 nut & bolt set, instruction leaflet.

LAMPS: 220V-240V

GY16 lamp socket / 2000W

CP72 50,000 lumens 400 hours average life

G22 lamp socket / 2500W

CP91 65,000 lumens 400 hours average life

G22 lamp socket / 2000W

CP92 50,000 lumens 400 hours average life

PHOTOMETRIC DATA

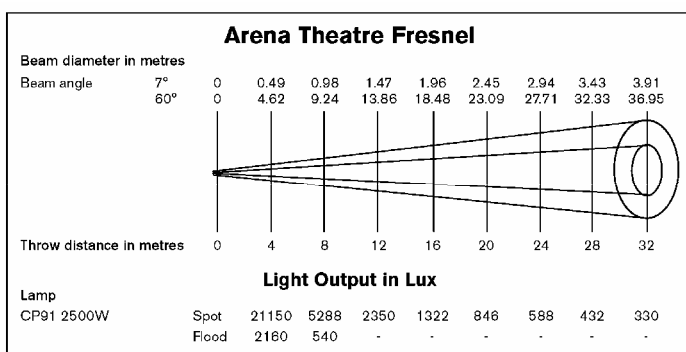

Tests conducted using a standard CP91, 2500W, 240V, 65,600 lumens lamp.

ORDER CODES & ACCESSORIES

Arena Theatre Fresnel 2kW	10SF2020GY16
Arena Theatre Fresnel 2.5kW	10SF2025G22
Barndoor	20BDSF2020
Lens Safety Mesh	20SM24
Suspension Hookclamp	20HC
Safety Bond	20SC

Selecon reserves the right to change the specifications without notice (09/06).