

- Piano bench
- Double-cross precision lifting system
- Music compartment (KB-57)
- Seat cushion: black velour
- Max. load capacity: 130 kg
- Adjustable height:
 - 450 mm - 580 mm (KB-47, KB-48)
 - 520 mm - 610 mm (KB-57)
- Seating surface:
 - 520 mm × 300 mm (KB-47, KB-48)
 - 570 mm × 350 mm (KB-57)
- Weight:
 - 8.75 kg (KB-47)
 - 11.3 kg (KB-48)
 - 8.9 kg (KB-57)

Mounting

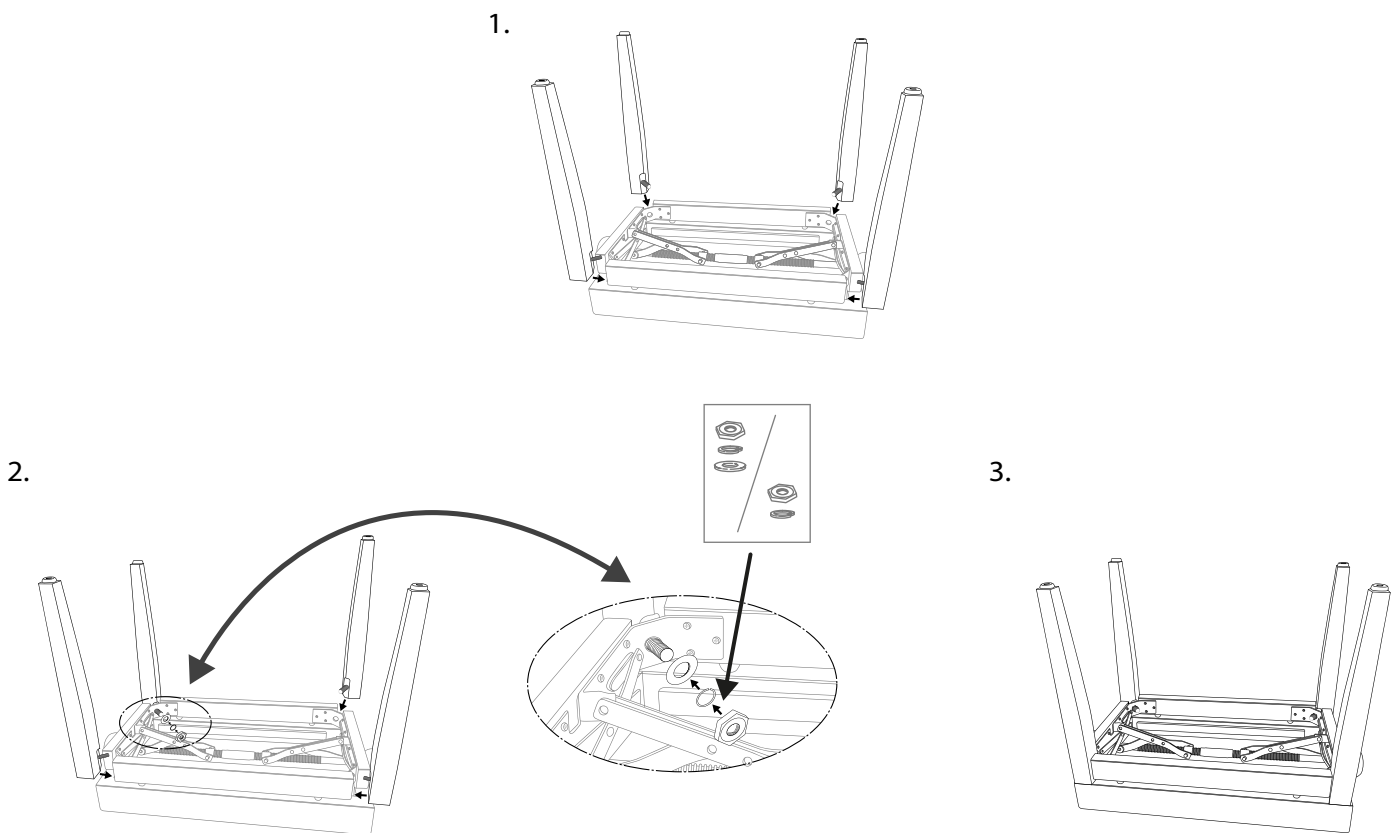

Tighten the nuts manually. Put the bench in a stable position on the floor. Tighten the nuts only then using the included wrench. This ensures that the bench does not shake.



Intended use

This product is intended for use as seat. Any other use is considered to be improper and may result in personal injury or property damage. No liability will be assumed for damages resulting from improper use.

Danger for children

Ensure that plastic bags, packaging, etc. are disposed of properly and are not within reach of babies and young children. Choking hazard! Ensure that children do not detach any small parts from the product. They could swallow the pieces and choke! Never let children unattended use the product.

Danger of tipping on unsuitable ground

If placed on soft or uneven ground, the product may overturn and cause injuries and property damage. Place the stand on flat and solid surfaces only.



Danger of tipping due to overload

In case of overload, the product may tip over and cause injuries and property damage. Never exceed the maximum load capacity specified for the product.

Possible staining

The plasticiser contained in the rubber feet of this product may possibly react with the coating of your surface and after some time cause permanent dark stains. In case of doubt, do not put the rubber feet directly on the surface and use a suitable underlay if necessary, i.e. felt-pad floor protectors or similar.



For the packaging, environmentally friendly materials have been chosen that can be supplied to normal recycling. Ensure that plastic bags, packaging, etc. are properly disposed of. Do not just dispose of these materials with your normal household waste, but make sure that they are collected for recycling. Please follow the notes and markings on the packaging.