

8 7 6 5 4 3 2 1

| REVISIONS | | | | |
|-----------|------|-------------|------|----------|
| ZONE | REV. | DESCRIPTION | DATE | APPROVED |
| | | | | |
| | | | | |

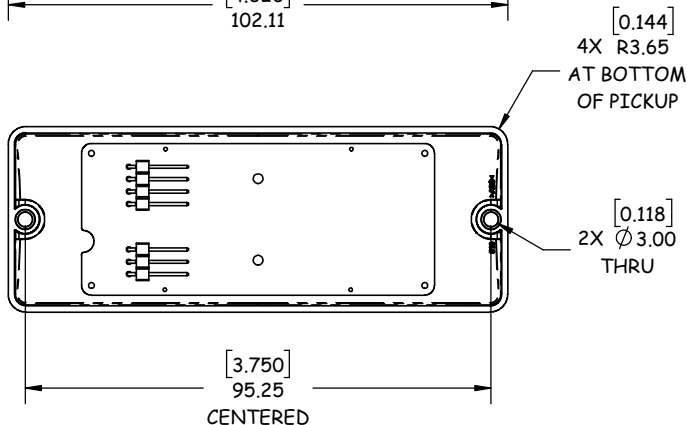
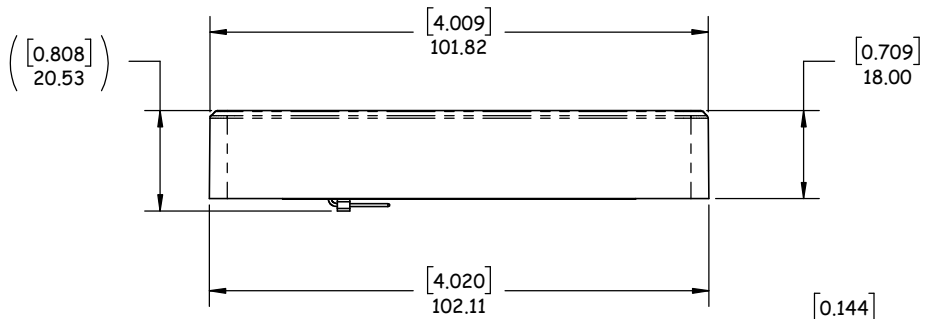
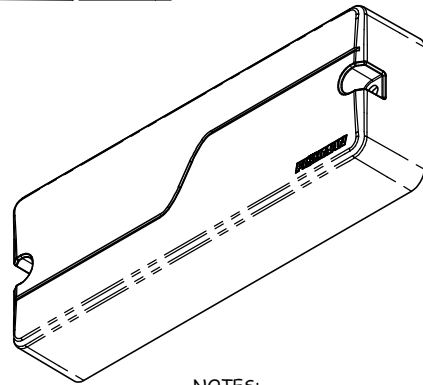
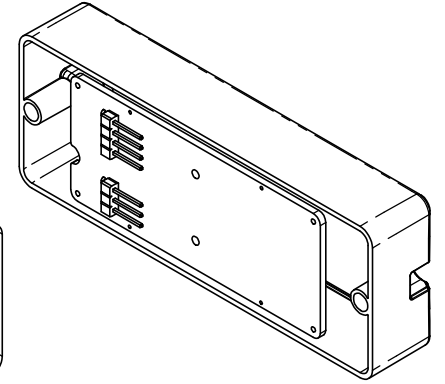
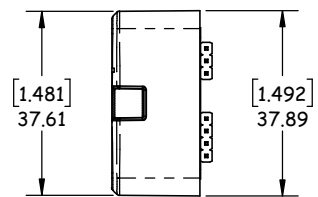
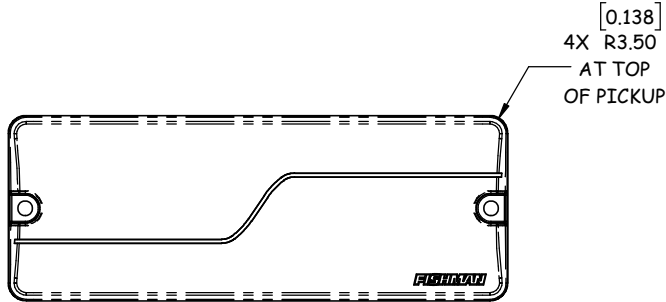

NOTES:

1. THIS DRAWING IS THE PROPERTY OF FISHMAN TRANSDUCERS INC. AND IS NOT TO BE REPRODUCED OR COMMUNICATED TO A THIRD PARTY WITHOUT THE EXPRESS WRITTEN PERMISSION OF AN OFFICER OF FISHMAN TRANSDUCERS.
2. FISHMAN RESERVES THE RIGHT TO MODIFY THESE DIMENSIONS AT ANY TIME. A REASONABLE EFFORT WILL BE MADE TO UPDATE OUR CUSTOMERS, HOWEVER, NO GUARANTEE IS MADE OR IMPLIED.
3. ALL FISHMAN FLUENCE PICKUPS ARE RoHS COMPLIANT AND CARRY A "CE" APPROVAL.
4. FISHMAN FLUENCE PICKUPS ARE PROTECTED UNDER PATENT 8,519,251. ADDITIONAL PATENTS PENDING.

| | | | | | |
|-------------------------------|--|---------------|--------------|---|----------|
| UNLESS OTHERWISE SPECIFIED: | | NAME | DATE | <p>3 Riverside Drive, Andover, MA 01810 USA Tel: 978.988.9199 Fax: 978.658.4713 www.fishman.com</p> | |
| DIMENSIONS ARE IN MILLIMETERS | | DRAWN | M. SCHOW | | 03/01/18 |
| TOLERANCES: | | CHECKED | | | |
| 0 PLACE DECIMAL ± 0.8 mm | | ENG APPR. | | | |
| 1 PLACE DECIMAL ± 0.4 mm | | MFG APPR. | | | |
| 2 PLACE DECIMAL ± 0.12 mm | | Q.A. | | | |
| MATERIAL | <p>PROPRIETARY AND CONFIDENTIAL THE INFORMATION CONTAINED IN THIS DRAWING IS THE SOLE PROPERTY OF FISHMAN TRANSDUCERS, INC. ANY REPRODUCTION IN PART OR AS A WHOLE WITHOUT THE WRITTEN PERMISSION OF FISHMAN TRANSDUCERS, INC. IS PROHIBITED.</p> | | | TITLE: FLUENCE 5 STRING BASS DIMENSIONS | |
| FINISH | DO NOT SCALE DRAWING | SIZE B | DWG. NO. | REV 0 | |
| SCALE: 1:1 | | | SHEET 1 OF 1 | | |

8 7 6 5 4 3 2 1