

Baugruppe	Gew [kg]
Profi Haube	31.77
Rollbrett	7.71
Basis	10.76
Deckel	13.30
	31.77

Fittings(Case)

Pos	Art-Nr	Anz	Beschreibung
1	ECK4101	8	Kugelecke groß
2	ECK4043	8	L-Ecke mittel
3	VER17291S	4	Butterfly mittel 12mm
4	GRI34082	6	Klappgriff mittel
5	ROL3470	2	100mm Lenkrolle Blue Wheel 160kg
6	ROL3477	2	100mm Lenkrolle Blue Wheel 160kg Feststeller



Proj: Roadcase Yamaha DM7C +DH

Rollbrett / Dockhouse 15cm / Schaumstoff

Art-Nr. 569503

AFS-ID

Kunde / Nr.

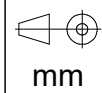

mm
gez. 17.07.2023 rp

Profil 30x30 | 9.5Hyb

Casety / Material Profi Haube
9mm Multiplex schwarz RAL9004

A-A

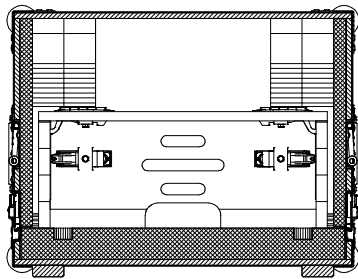

B-B

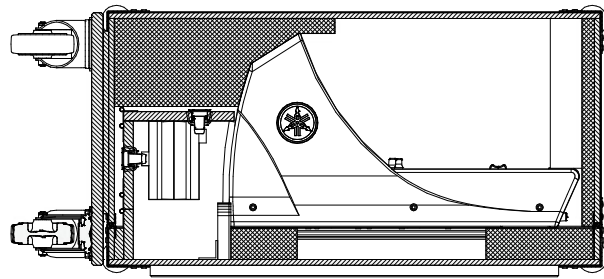

C-C

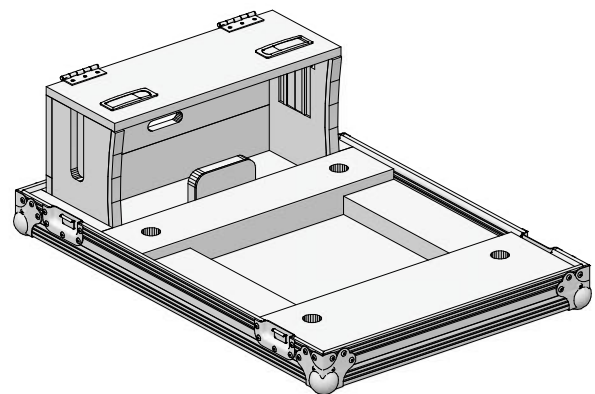
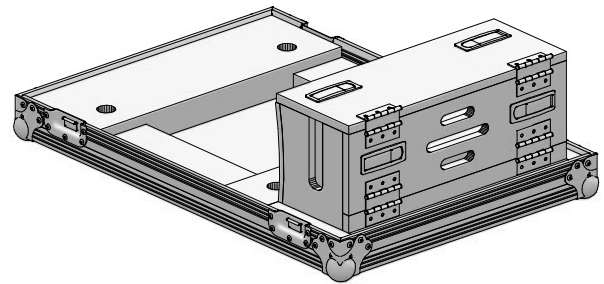
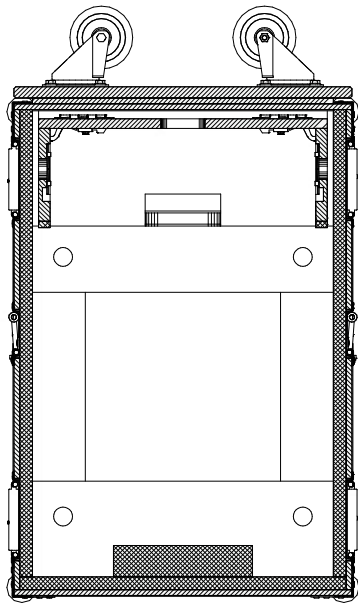

Fittings (Ausbau)

Pos	Art-Nr	Anz.	Beschreibung
1	SHA2600BLK	4	Doppelscharnier schwarz
2	VER1655	4	Hebelverschluß schmal



Proj Roadcase Yamaha DM7C +DH

Art-Nr. 569503

Rollbrett / Dockhouse 15cm / Schaumstoff

AFS-ID

Kunde / Nr.

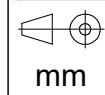

gez. 17.07.2023 rp

Profil 30x30 | 9.5Hyb

Casetyp / Material Profi Haube
9mm Multiplex schwarz RAL9004